

IRELAND'S 1ST ADDITION.

TO THE
CITY OF ROCHESTER

Scale 1"=200'

J. C. Utton.

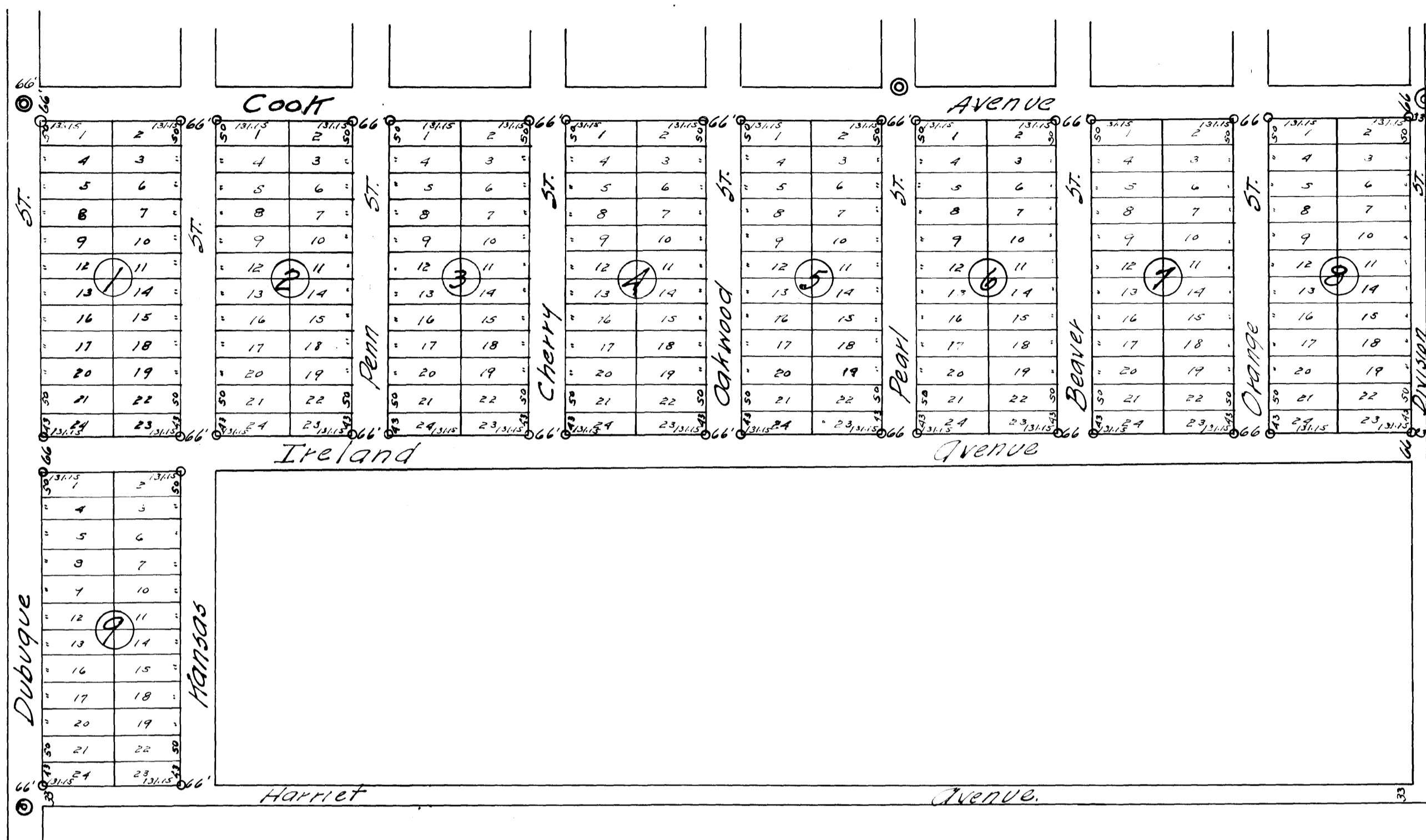

I, J. C. Utton, do hereby certify that at the request of W. W. Ireland and Annie E. Ireland, his wife, owners of the following described tract or parcel of land, lying and being within the corporate limits of the City of Rochester, County of Olmsted, State of Minnesota, to-wit: Part of the North one half (1/2) of the North West one quarter (1/4) of Section Twelve (12) Township One hundred six (106) N. of Range Fourteen (14) W. I have surveyed and platted said tract or parcel of land above described into Blocks, Lots and Streets, as an Addition to the City of Rochester, as shown on the accompanying Plat, said Addition to be known and designated as "Ireland's 1st Addition." I further certify that the accompanying Plat is a true and correct representation of the survey, that all the distances are correctly shown on plat in feet and decimals of a foot, that monuments for guidance of future surveys have been placed as shown thus © that the outside boundary lines are correctly designated on the plat, that there are no wet lands thereon and that said tract of land has not been heretofore platted into Blocks and Lots.

Dated this 16th day of June, 1916.

J. C. Utton, Surveyor.

Subscribed and sworn to before me, this 16th day of June, 1916.

Theo. A. Schacht, Notary Public, My Commission expires July 22, 1917

State of Minnesota,
County of Olmsted,
City of Rochester.

I, A. F. Wright, City Clerk in and for said City of Rochester, do hereby certify that on the 22nd day of June 1916, the accompanying Plat was duly approved by the Common Council of the City of Rochester, in testimony whereof I have hereunto signed my name and affixed the seal of said City this 23rd day of June 1916.

A. F. Wright, City Clerk.

State of Minnesota,
County of Olmsted, s.s.

Taxes paid and transfer entered this 27th day of July, A. D. 1916.

Leiter J. Fiesel,
County Auditor

By A. L. G. Ditt.

State of Minnesota, s.s.
County of Olmsted.

We the undersigned, W. W. Ireland and Annie E. Ireland, his wife, do hereby certify that we are the owners of the following, described tract or parcel of land, situated and being within the corporate limits of the City of Rochester, County of Olmsted, State of Minnesota to-wit: Part of the North one half (1/2) of the North West one quarter (1/4) of Section Twelve (12) Township One hundred six (106) N. of Range Fourteen (14) W. and we do further certify that we have caused the same to be platted into Blocks, Lots and Streets as an Addition to the City of Rochester, to be known as Ireland's 1st Addition, and that we do for ourselves, our heirs and assigns, hereby grant and dedicate the streets shown on the accompanying Plat to the City of Rochester and the public use forever. In testimony whereof we have hereunto set our hands and seals this 16th day of June, A. D. 1916.

Witnesses
Theo. A. Schacht

W. W. Ireland (Seal)
Annie E. Ireland (Seal)

State of Minnesota,
County of Olmsted, s.s.

On this 16th day of June, 1916, before me a Notary Public in and for said County and State, personally appeared W. W. Ireland and Annie E. Ireland his wife, to me well known to be the persons who executed the foregoing instrument and acknowledged that they executed the same as their own free act and deed.

Theo. A. Schacht, Notary Public, My Commission expires July 22-1917

State of Minnesota,
County of Olmsted, s.s.

Filed for record this 27th day of July 1916 at 11 1/2 o'clock A. M.
and recorded in Book of Plats on page

Walter Coleboldt

Deputy Clerk of W. U. S.