

# EVERGREEN CEMETERY

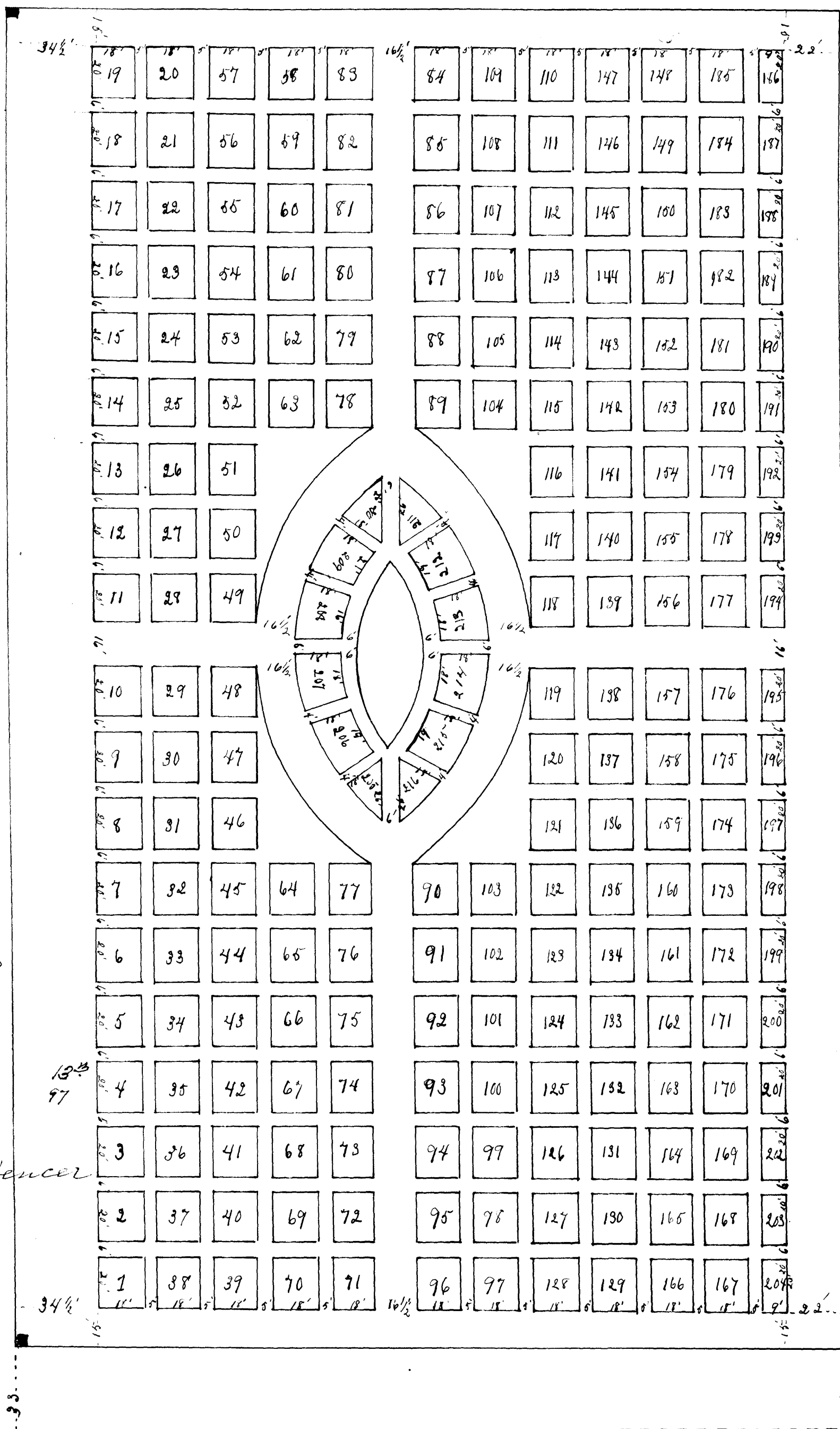

17916  
 Christed  
 December  
 J. F. Spencer

I hereby certify that I have surveyed and platted as a cemetery under the direction of the officers of the Evergreen Cemetery Association, the following described piece of land to wit: Commencing at a point two rods north of the southwest corner of the southeast quarter of the North east quarter of Section Sixteen (16) Town One hundred Six (106) North, Range Eleven (11) west Christed County, Minn. Running thence North thirty two (32) rods, Thence East twenty (20) rods, Thence South thirty two (32) rods, Thence West twenty rods to place of beginning.

The annexed is a true plat with measurement given in feet. Stone monuments marked thus ■ Surveyed the 3<sup>rd</sup> day of Aug. A.D. 1897

*J. J. [Signature]*  
 (Surveyor)

State of Minnesota } ss  
 County of Christed }  
 On this 11<sup>th</sup> day of October 1897 before me a Notary Public within and in said County personally appeared E. E. Rank and Harlow Brown to me personally known, who being duly sworn by me, the said E. E. Rank did say that he is the secretary and treasurer and said Harlow Brown did say that he is the president of the Evergreen Cemetery Association of above Christed County, Minn. and that the foregoing plat was made, signed, and sealed in behalf of said Corporation by authority of the board of trustees, and said E. E. Rank and Harlow Brown acknowledged said action to be the free act of said Corporation, and that said Corporation has no Certified Seal. Harlow Brown *(Seal)* E. E. Rank *(Seal)* subscribed and sworn to and acknowledged before me this 11<sup>th</sup> day of October 1897.

*William C. Fraser*  
 Notary Public