

Register office, I hereby certify that this Plat of Farmington Cemetery was filed in this office on the 29th day of May 1864 at 3 o'clock P.M. and incorporated into Book 1 of Town Plats with Page 34 L.B. Ship Registered of deeds

FARMINGTON CEMETERY.

Farmington Cemetery is situated in Section 8 Town 10R Range 13. The initial point of said survey is the North West corner of said section 8, which is N. 88° 20' W. 943 1/2 feet distant from the North West corner of this cemetery. All lines of lots or alleys are either parallel or at right angles to north line which is parallel to, and 33 feet distant from the north line of the section, the course of which is expressed upon the Plat. Position of monuments are indicated upon Plat by small squares. All measurements expressed in feet in figures in black ink. No of feet in red ink in center of lot.

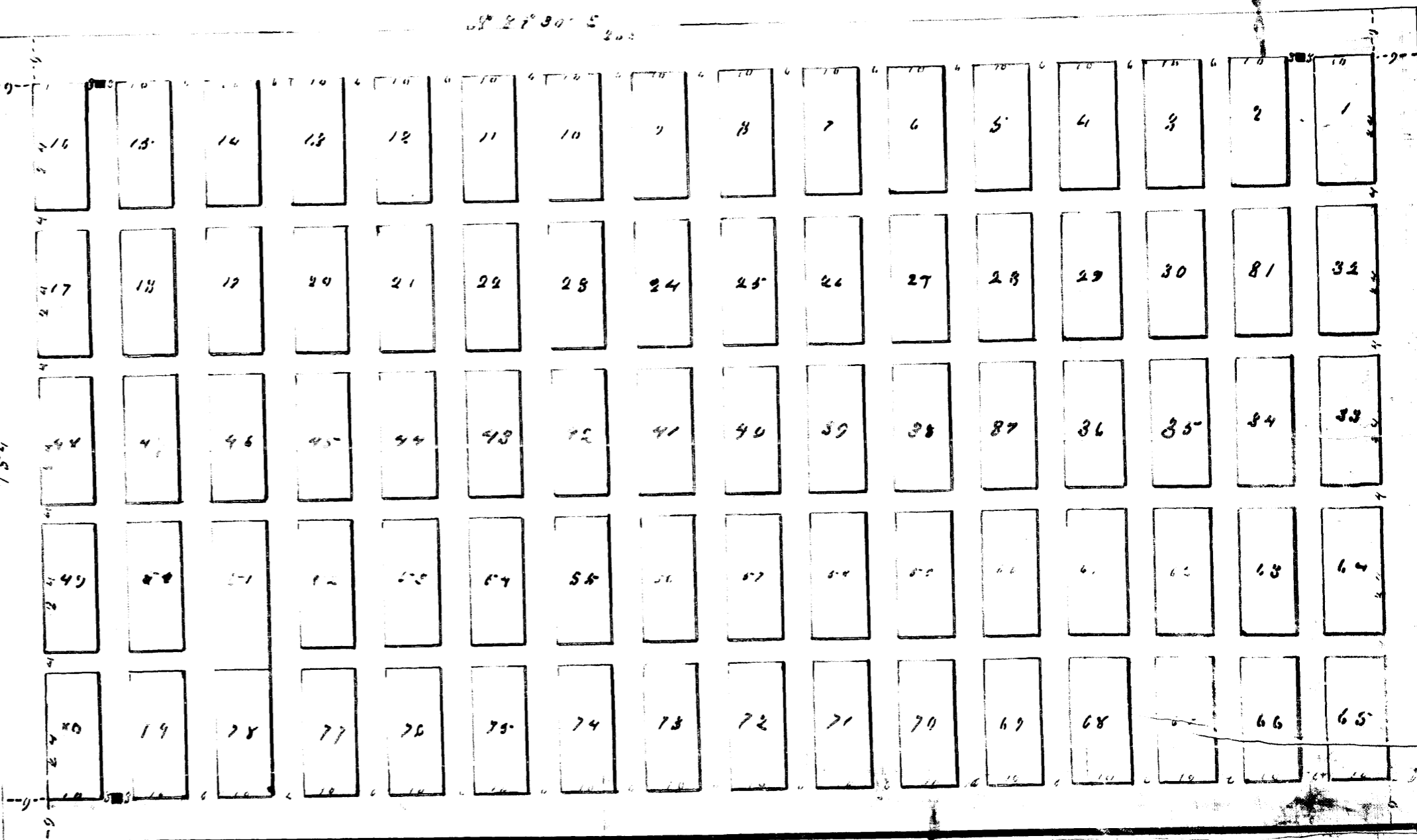

I hereby certify that the accompanying Plat is a true record of a survey for a Cemetery, as surveyed by the 17th day of July 1867 W.E. Norton

The annexed Plat embraces the grounds purchased by the Farmington Cemetery Association for a Cemetery and was laid out under the direction of the Trustees of said Association as set forth in the Certificate of the Surveyor herewith attached

In Presence of Rochester May 29th 1869
L.B. Ship
G.S. Cook

Thomas Pratt Pres. L.S.
John Little Secy. L.S.

Certificate of Acknowledgments.
State of Minnesota
County of Ramsey
Before me Otto H. Cook Notary Public in and for said County and State, personally came Thomas Pratt President and John Little Secretary of the Farmington Cemetery Association. On this twenty ninth day of May 1869, said persons being to me known as the persons whose names are subscribed to the foregoing instrument and acknowledged the signing and sealing of said instrument in official capacity as their free and deed for the purpose therein expressed.
Otto H. Cook
Notary Public