

MAP OF WILLSON'S ADDITION

ROCHESTER MINN.

SCALE 1 INCH = 100 FEET

Explanations
 Fifty feet due North from the South West Corner of Block No. Eighty Seven (87) in this Addition is the initial point of the survey of this plat, which point is marked and designated by the corner Stone in the South West Corner of Dr. Kellys Brick Business House. The width of the streets and alleys and the size of the lots are as designated in red ink on said plat, and the streets named Broadway, Main, Line, First, Second, High & Minnesota are continuations of the streets in straight lines and of the same width & in the same direction with the streets bearing the same names in the portions of said city of Rochester heretofore surveyed and platted.

Engel & Sons, Surveyors

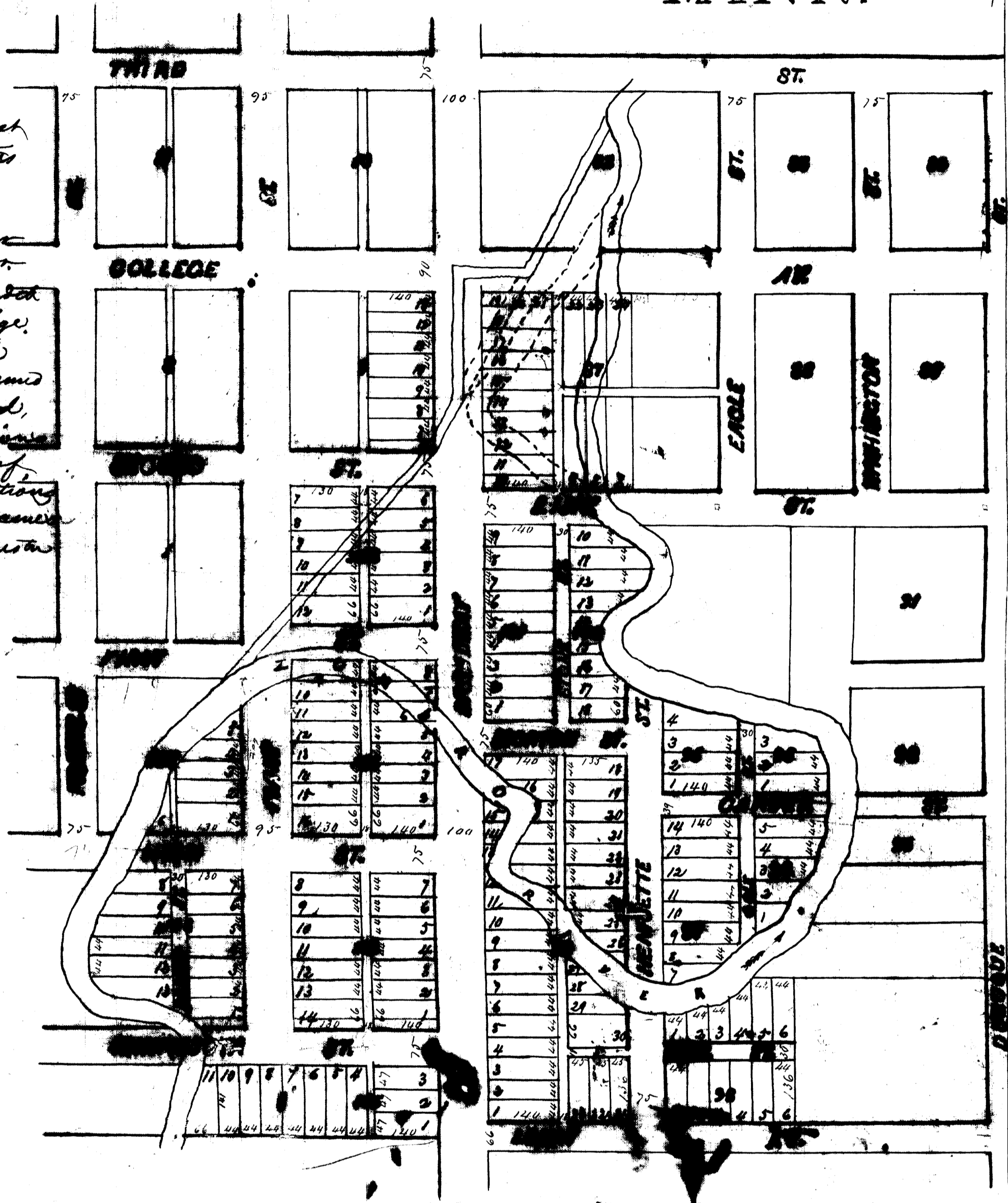

Rochester Olmsted County Minnesota January 20 1859 -
 We the undersigned Surveyors of Willson's addition to the city of Rochester aforesaid situated in the N. E. Quarter of Sec No 2, T. 206. N. R. 14 W. do hereby certify that we caused the said addition to be surveyed and platted and the plat thereof to be filed and we hereby dedicate the streets and alleys as laid down on said plat to the public for public use as such forever.

Signed sealed & delivered in the presence of
 Moses W. Gray
 Dwight Chubbuck
 Henry Messersmith

Charles C. Willson
 George Head
 Henrietta M. Head

Register Office
 Olmsted County
 I hereby certify that this Plat was filed for record on the 20th day of January A. D. 1859 at 4 1/2 o'clock P. M. and recorded in Book 4 of Plats on Page 20

E. Mapes
 Register of Deeds

State of Minnesota }
 Olmsted County ss } On this 20th day of January 1859 personally appeared before me Charles C. Willson, George Head and Henrietta Head to me known as the persons who executed the above instrument and they severally acknowledged that they executed the same and the said Henrietta Head on a separate examination apart from & out of the hearing of her husband acknowledged that she executed the same freely without any fear or compulsion of her said husband George Head and that she does not wish to retract the same - In testimony whereof I have hereunto set my hand and affixed my official seal this 20th day of January 1859 -

Moses W. Gray
 Judge of Probate