

BAIHLY WOODLAND SIXTH SUBDIVISION

INSTRUMENT OF DEDICATION

KNOW ALL MEN BY THESE PRESENTS: That Southwest Woodland, a partnership, owners and proprietors of the following described property situated in the County of Olmsted, State of Minnesota, to wit:

That part of the Northwest Quarter of Section 10, Township 106 North, Range 14 West, Olmsted County, Minnesota, described as follows:

Commencing at the northwest corner of said Northwest Quarter; thence southerly on a Minnesota State Plane Grid Azimuth from north of 178 degrees 06 minutes 04 seconds along the west line of said Northwest Quarter 1796.35 feet to the north line of the south 50.00 acres of said Northwest Quarter; thence easterly 88 degrees 53 minutes 16 seconds azimuth along said north line 852.37 feet to the point of beginning; thence northerly 358 degrees 53 minutes 16 seconds azimuth 220.18 feet; thence northwesterly 336 degrees 56 minutes 41 seconds azimuth 218.09 feet to the southerly line of Baihly Woodland Fifth Subdivision; thence easterly 86 degrees 12 minutes 32 seconds azimuth along said southerly line 195.10 feet to the southwesterly line of Block 3 of Baihly Woodland Third Subdivision; thence southeasterly 136 degrees 30 minutes 44 seconds azimuth along said southwesterly line 34.71 feet to the southeasterly line of said Block 3; thence northeasterly 46 degrees 30 minutes 44 seconds azimuth along said southeasterly line and an extension thereof 402.35 feet to the intersection with a northwesterly projection of the southwesterly line of Block 2 of Baihly Woodland Third Subdivision; thence southeasterly 136 degrees 30 minutes 44 seconds azimuth along said southwesterly line 216.00 feet to the southeasterly line of said Block 2; thence northeasterly 46 degrees 30 minutes 44 seconds azimuth along said southeasterly line 127.68 feet to the southerly line of said Block 2; thence easterly 96 degrees 35 minutes 00 seconds azimuth along said southerly line 148.44 feet to the southwesterly line of Block 3 of Baihly Woodland Fourth Subdivision; thence southeasterly 143 degrees 27 minutes 40 seconds azimuth along said southwesterly line 171.43 feet to the northwesterly corner of Lot 4 of Baihly Woodland Second Addition; thence southerly 170 degrees 18 minutes 09 seconds azimuth along the westerly line of said Lot 4 a distance of 101.74 feet to the northerly corner of Lot 3 of Baihly Woodland Second Addition; thence southwesterly 217 degrees 47 minutes 51 seconds azimuth along the northwesterly line of Baihly Woodland Second Addition 250.02 feet; thence southwesterly 223 degrees 08 minutes 34 seconds azimuth along said northwesterly line 169.00 feet to the northeasterly corner of Lot 11 of Baihly Woodland First Addition Replat; thence southwesterly 231 degrees 13 minutes 31 seconds azimuth along the northwesterly line of said Lot 11 a distance of 45.57 feet; thence westerly 269 degrees 35 minutes 31 seconds azimuth along the northerly line of Baihly Woodland First Addition Replat 189.25 feet to northwesterly corner of said Replat; thence southwesterly 216 degrees 58 minutes 50 seconds azimuth along the northwesterly line of said Replat 2.96 feet to the north line of said south 50.00 acres; thence westerly 268 degrees 53 minutes 16 seconds azimuth along said north line 433.47 feet to the point of beginning.

Said tract contains 10.61 acres more or less.

Have caused the same to be surveyed and platted as BAIHLY WOODLAND SIXTH SUBDIVISION and do hereby donate and dedicate to the public for public use forever the thorough fares and grant the easements as shown on this plat.

In witness whereof said Southwest Woodland, a partnership, has caused these presents to be signed by two of the partners this 26th day of May, 1987.

Donald A. Andersberg
Partner

Samuel A. Baihly
Partner

STATE OF MINNESOTA
COUNTY OF OLMSTED

The foregoing instrument was acknowledged before me this 26th day of May, 1987, by Donald A. Andersberg and Samuel A. Baihly, Partners of Southwest Woodland, a partnership.

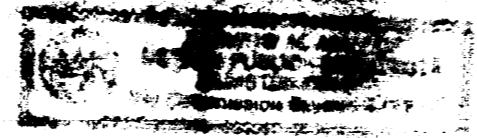

Stephen M. Stoll
Notary Public, Olmsted County, MN
My Commission Expires 6-1-91



717 THIRD AVENUE SOUTHEAST
ROCHESTER, MINNESOTA 55904
507-288-8484

ENGINEERING ·
ARCHITECTURE ·
SURVEYING ·
PLANNING ·
LANDSCAPE ARCHITECTURE

COUNTY TREASURER

Taxes due and payable for the year 1987, have been paid as of this 13th day of July, 1987.

Bob Ryan
Karen Locker Deputy
Olmsted County Treasurer

COUNTY AUDITOR

No delinquent taxes due and transfer entered this 13th day of July, 1987.

Wayne Pearson
Olmsted County Auditor
by: Patricia G. Griffin, Deputy

COUNTY RECORDER

Document Number 5300 1

I hereby certify that this instrument was filed in the office of the County Recorder for record on this 13 day of July, 1987, at 2:12 o'clock P.M. and was duly recorded in Olmsted County Records.

LOIS FINSTUEN
Olmsted County Recorder
Carol Ann Ferrier
deputy

COUNTY SURVEYOR

I certify that this plat has been checked mathematically and that the plat conforms to the applicable platting laws.

This 26th day of May, 1987

Roger W. Brand
Olmsted County Surveyor

STATE OF MINNESOTA
COUNTY OF OLMSTED
CITY OF ROCHESTER

I, Carol A. Grimm, City Clerk, in and for the City of Rochester, do hereby certify that on the 18 day of May, 1987, the accompanying plat was duly approved by the Common Council of the City of Rochester. In testimony whereof, I have hereunto signed my name and affixed the Seal of said City of Rochester this 6 day of July, 1987.

Carol A. Grimm
City Clerk

SURVEYOR'S CERTIFICATE

I do hereby certify that I have surveyed and platted the property described on this plat as BAIHLY WOODLAND SIXTH SUBDIVISION that this plat is a correct representation of said survey, that all distances are correctly shown on said plat in feet and hundredths of a foot, that all monuments have been correctly placed in the ground as shown, that the outside boundary lines are correctly designated and that there are no wetlands or public highways to be designated on said plat other than as shown.

Donald R. Borcharding
DONALD R. BORCHARDING
Minnesota R.L.S. 10162

STATE OF MINNESOTA
COUNTY OF OLMSTED

The foregoing Surveyor's Certificate was acknowledged before me this 26th day of May, 1987, by Donald R. Borcharding, R.L.S. No. 10162.



Stephen M. Stoll
Notary Public, Olmsted County, MN
My Commission Expires 6-1-91

BAIHLY WOODLAND SIXTH SUBDIVISION

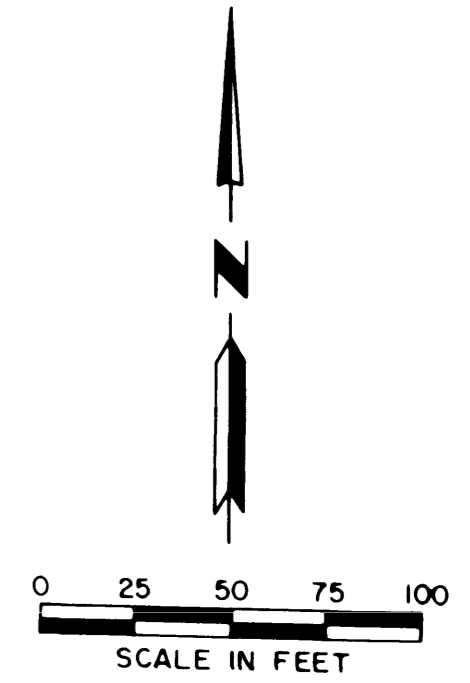

BEARINGS
Plat bearings are Minnesota State Plane Grid azimuths measured to the right from Grid North.

- MONUMENTS**
- 1/2" Re-Bars
 - 3/4" Iron Pipes
 - Found Monument
 - 3/4" Iron Pipe unless otherwise noted

All monuments set have a plastic cap stamped "RLS 10162"

CURVE DATA				
CURVE	Δ	R	L	CHORD
1	32° 30' 00"	175.00	99.27	97.94
2	03° 31' 51"	275.00	16.95	16.94
3	29° 42' 08"	275.00	142.72	141.12
4	29° 42' 51"	275.00	142.62	141.02
5	03° 09' 38"	275.00	15.17	15.17
6	41° 24' 35"	50.00	36.14	35.36
7	47° 25' 53"	50.00	41.39	40.22
8	68° 09' 41"	50.00	59.48	56.04
9	67° 22' 48"	50.00	58.80	55.47
10	79° 50' 48"	50.00	69.68	64.18
11	10° 31' 23"	50.00	9.18	9.17
12	30° 53' 12"	50.00	26.96	26.63
13	09° 12' 15"	325.00	52.21	52.15
14	16° 15' 35"	325.00	92.23	91.92
15	16° 15' 35"	325.00	92.23	91.92
16	16° 47' 54"	325.00	95.29	94.95
17	07° 37' 09"	325.00	43.22	43.19
18	05° 59' 52"	225.00	23.55	23.54
19	26° 30' 08"	225.00	104.07	103.15
20	20° 25' 57"	333.00	118.75	118.12
21	20° 25' 57"	267.00	95.22	94.71
A	20° 25' 57"	300.00	106.98	106.42
B	32° 30' 00"	200.00	113.45	111.93
C	66° 08' 28"	300.00	346.31	327.40

① CURVE REFERENCE NO. (PROP. LINE)
② CURVE REFERENCE NO. (CENTER LINE)

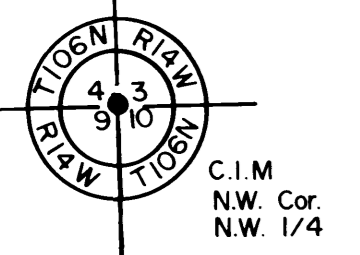

C.I.M.
N.W. Cor.
N.W. 1/4

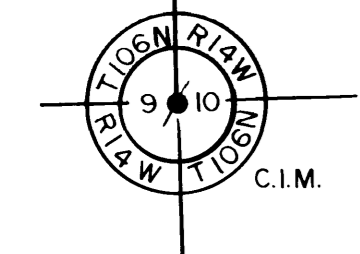

C.I.M.

Utility Easements are shown thus: UNPLATTED

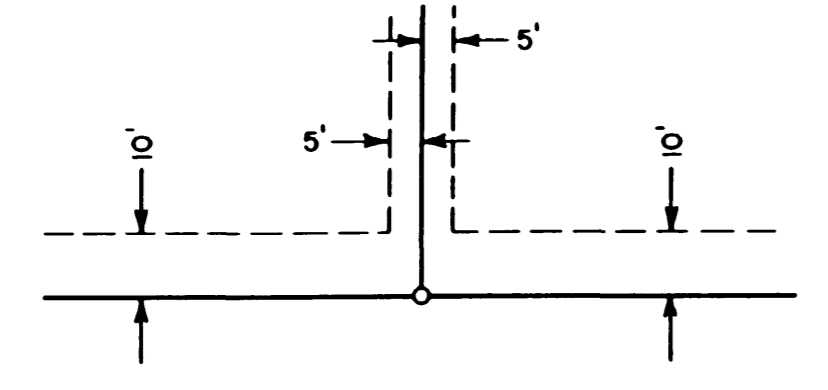

Being 5-feet in width, unless otherwise indicated, and adjoining lot lines, and 10-feet in width and adjoining street lines, as shown on the plat.

UTILITY EASEMENT DEFINED
An unobstructed easement for the construction and maintenance of all necessary overhead, underground, or surface public utilities, including rights to conduct drainage and trimming on said easement.

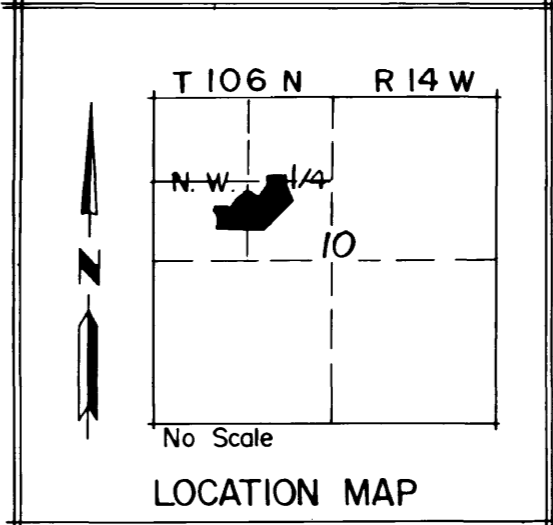

LOCATION MAP



717 THIRD AVENUE SOUTHEAST
ROCHESTER, MINNESOTA 55904
507-288-8484

ENGINEERING - ARCHITECTURE - SURVEYING - PLANNING - LANDSCAPE ARCHITECTURE