

# CONDOMINIUM NUMBER 84 LA QUESTA NORTH CONDOMINIUM SITE PLAN

These Floor Plans have been recorded as part of the Declaration filed as Document No. 475373 on the 12 day of September A.D., 1984, Olmsted County Recorder.

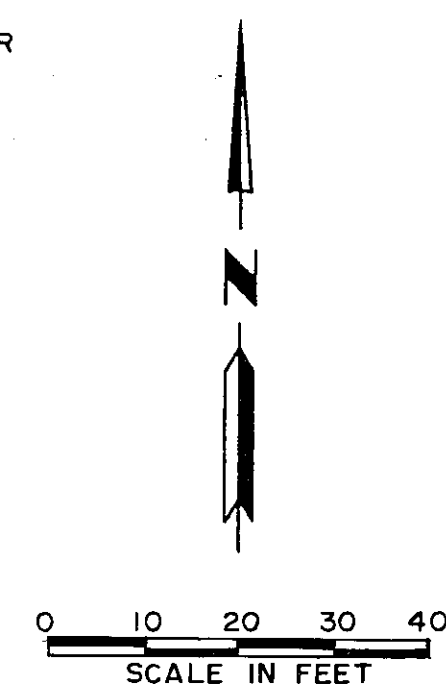
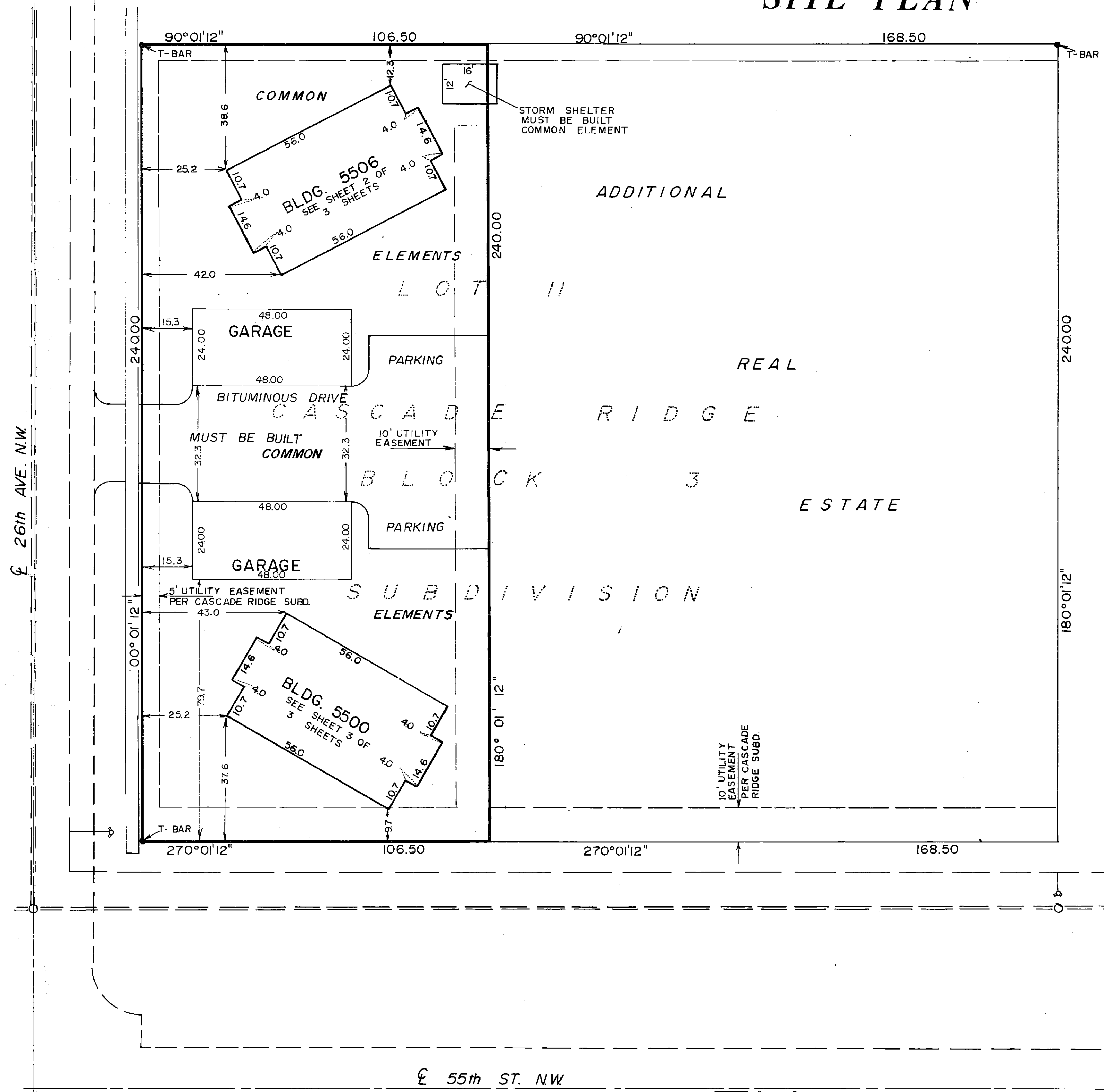

**BENCH MARKS:**

Northeast Bolt Hydrant at 26th Avenue and 55th Street N.W. El. 1032.58

Northeast Bolt Hydrant on North Frontage Road midway between 26th Avenue and 28th Avenue N.W. El. 1026.77

Elevations are based on the National Geodetic Vertical Datum of 1929.

Bearings are azimuths measured to the right from an assumed north.

I hereby certify that the Site Plans for "LA QUESTA NORTH CONDOMINIUM" No. 84) being located upon the following described property:

The west 106.50 feet of Lot 11, Block 3, CASCADE RIDGE SUBDIVISION, according to the plat thereof on file in the County Recorders Office, Olmsted County, Minnesota.

Said tract contains 0.58 acres more or less.

and the additional real estate described as follows:

All of Lot 11, Block 3, CASCADE RIDGE SUBDIVISION, according to the plat thereof on file in the County Recorders Office, Olmsted County, Minnesota, except the west 106.50 feet thereof.

Said tract contains 0.94 acres more or less.

Accurately depict all information required by Minnesota Statutes Section 515.01 and 515.02.

I hereby certify that this survey, plan or report was prepared by me or under my direct supervision and that I am a duly Registered Land Surveyor under the laws of the State of Minnesota.

*Donald R. Borcherding*  
Date 9/6/84 Reg. No. 10162

**NOTARY:**

State of Minnesota  
County of Olmsted

The foregoing instrument was acknowledged before me this 6<sup>th</sup> day of SEPTEMBER, 1984 by DONALD R. BORCHERDING a registered professional LAND SURVEYOR.

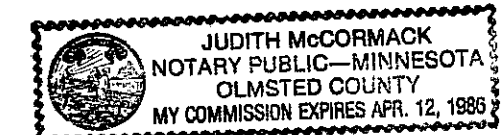

*Judith M. McCormack*  
Notary Public

I hereby certify that all structural components and mechanical systems serving more than one unit of all buildings containing or comprising any units hereby created are substantially completed consistent with the Floor Plans for "LA QUESTA NORTH CONDOMINIUM" (No. 84) and

I hereby certify that this plan, specification, or report was prepared by me or under my direct supervision and that I am a duly Registered Engineer under the laws of the State of Minnesota.

*Donald R. Borcherding*  
Date 9/6/84 Reg. No. 10162

**NOTARY:**

State of Minnesota  
County of Olmsted

The foregoing instrument was acknowledged before me this 6<sup>th</sup> day of SEPTEMBER, 1984 by DONALD R. BORCHERDING a registered professional ENGINEER.

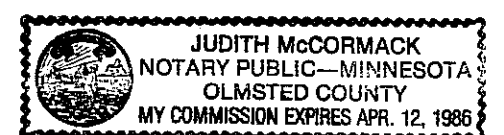

*Judith M. McCormack*  
Notary Public

# CONDOMINIUM NUMBER 84 LA QUESTA NORTH CONDOMINIUM FLOOR PLAN

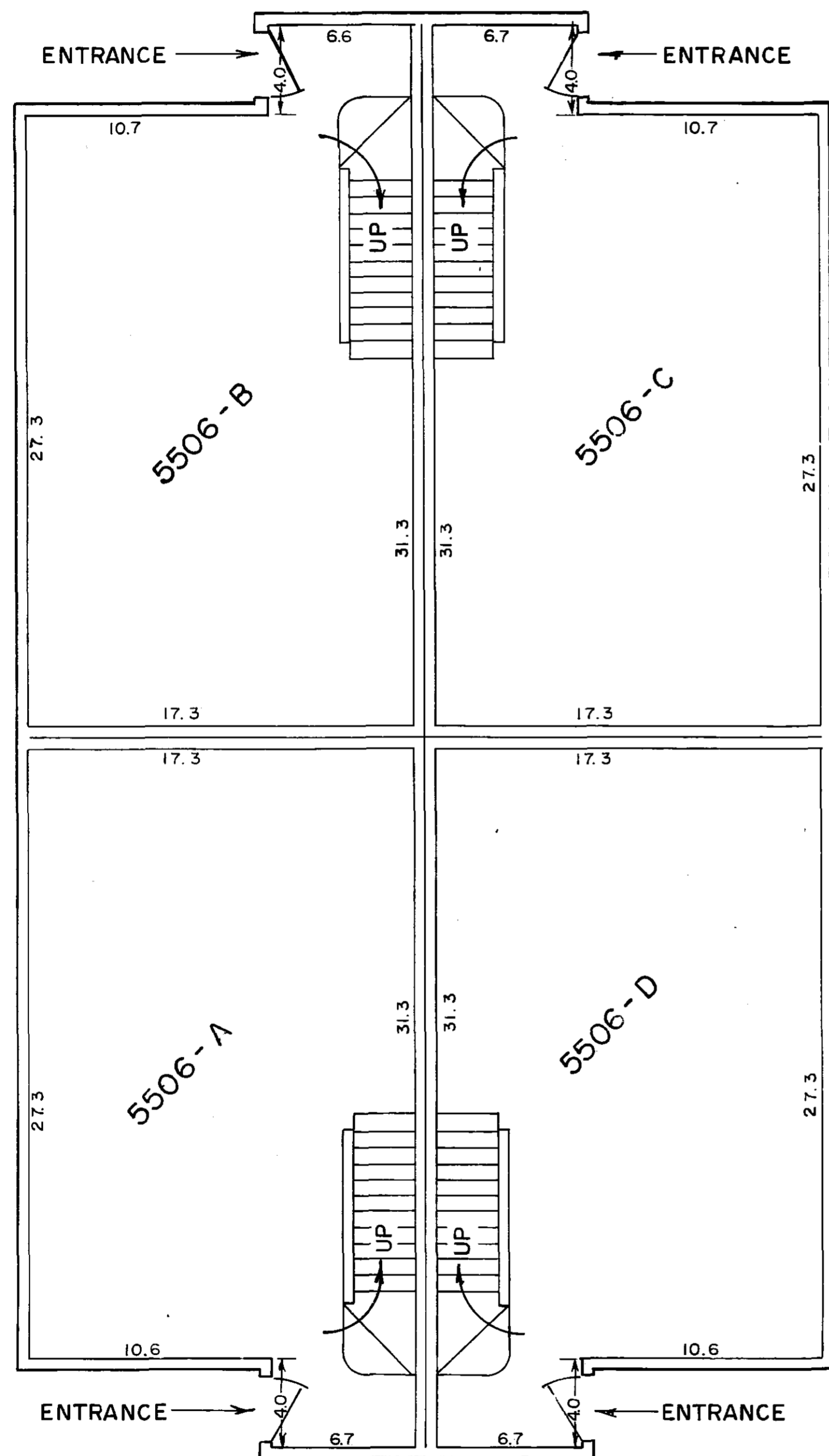

FLOOR ELEVATION 1040.46  
CEILING HEIGHT 8.05

## MAIN FLOOR

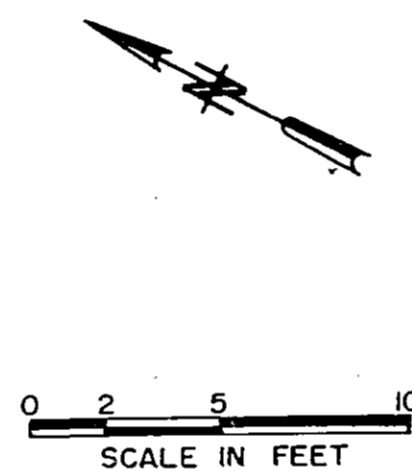

Refer to Site Plan, Sheet 1 of 3 Sheets for building location. Floor Elevations as shown are referenced to an established benchmark as shown on Site Plan.

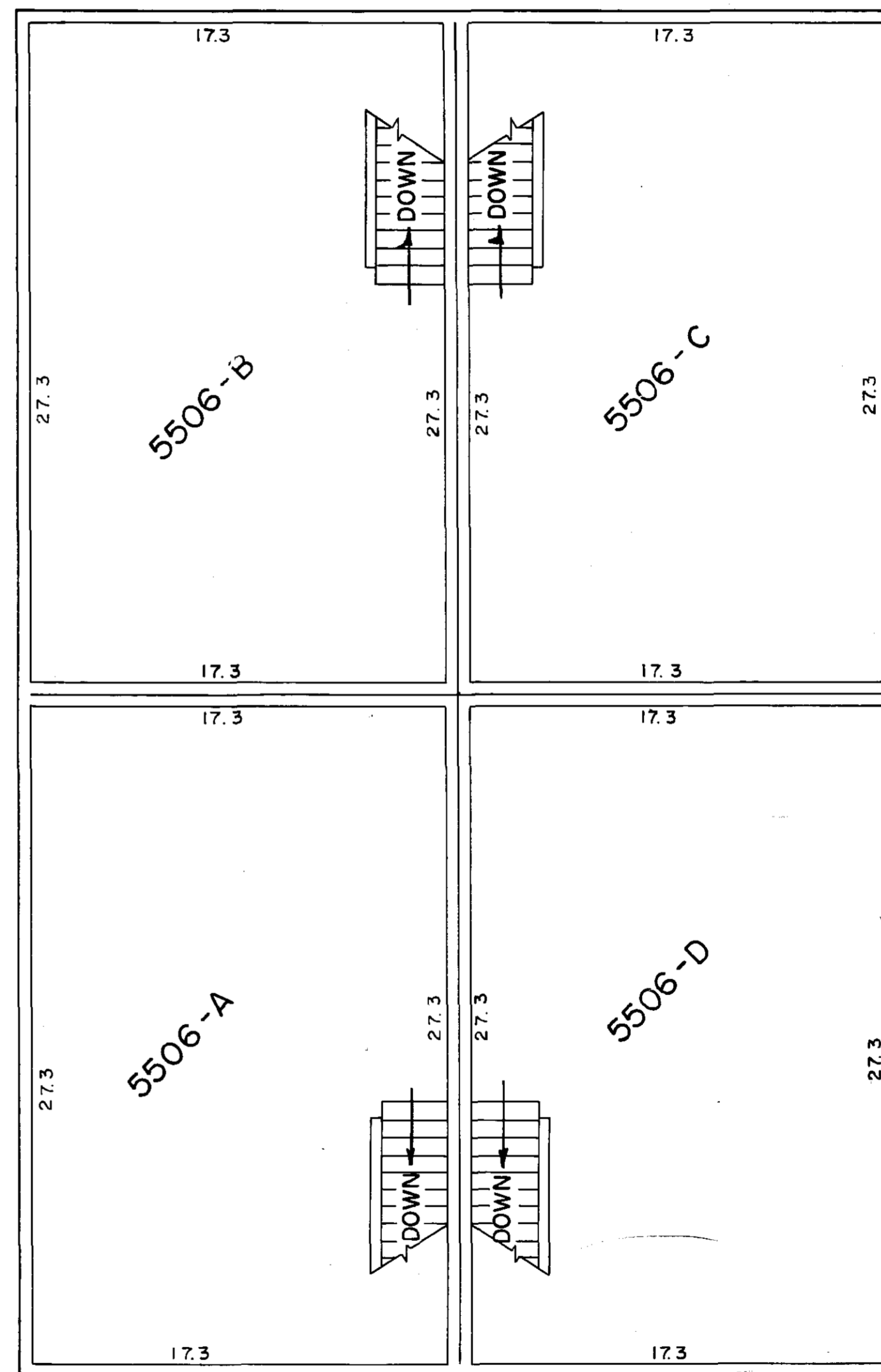

FLOOR ELEVATION 1049.71  
CEILING HEIGHT 8.05

## SECOND FLOOR

VERTICAL CONTROL

The elevations on this plan are based on the National Geodetic Vertical Datum of 1929.

# CONDOMINIUM NUMBER 84 LA QUESTA NORTH CONDOMINIUM FLOOR PLAN

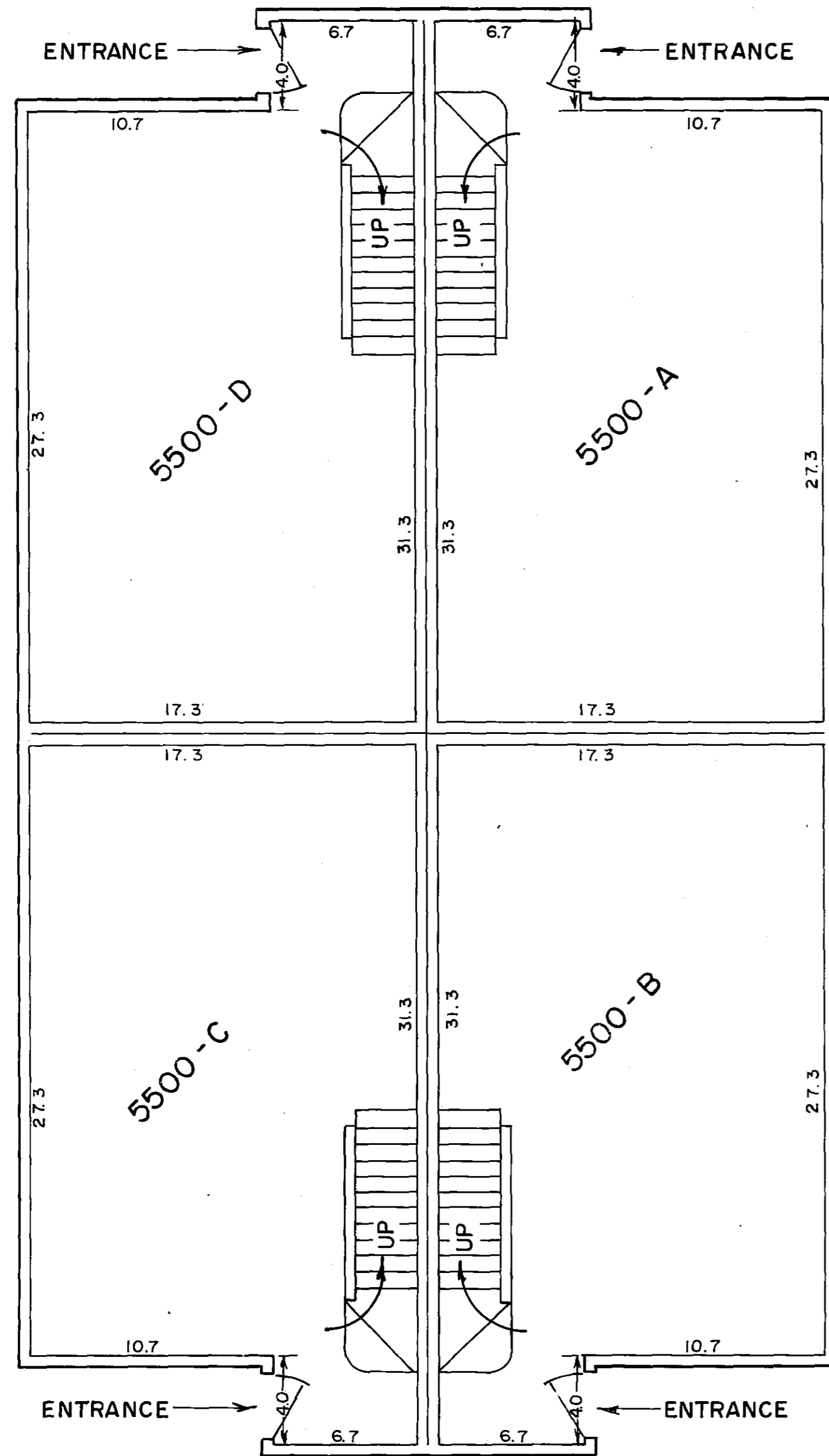

FLOOR ELEVATION 1032.69  
CEILING HEIGHT 8.05

## MAIN FLOOR

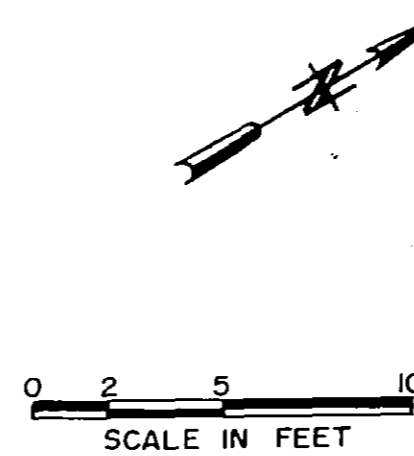

Refer to Site Plan, Sheet 1 of 3 Sheets for building location. Floor Elevations as shown are referenced to an established benchmark as shown on Site Plan.

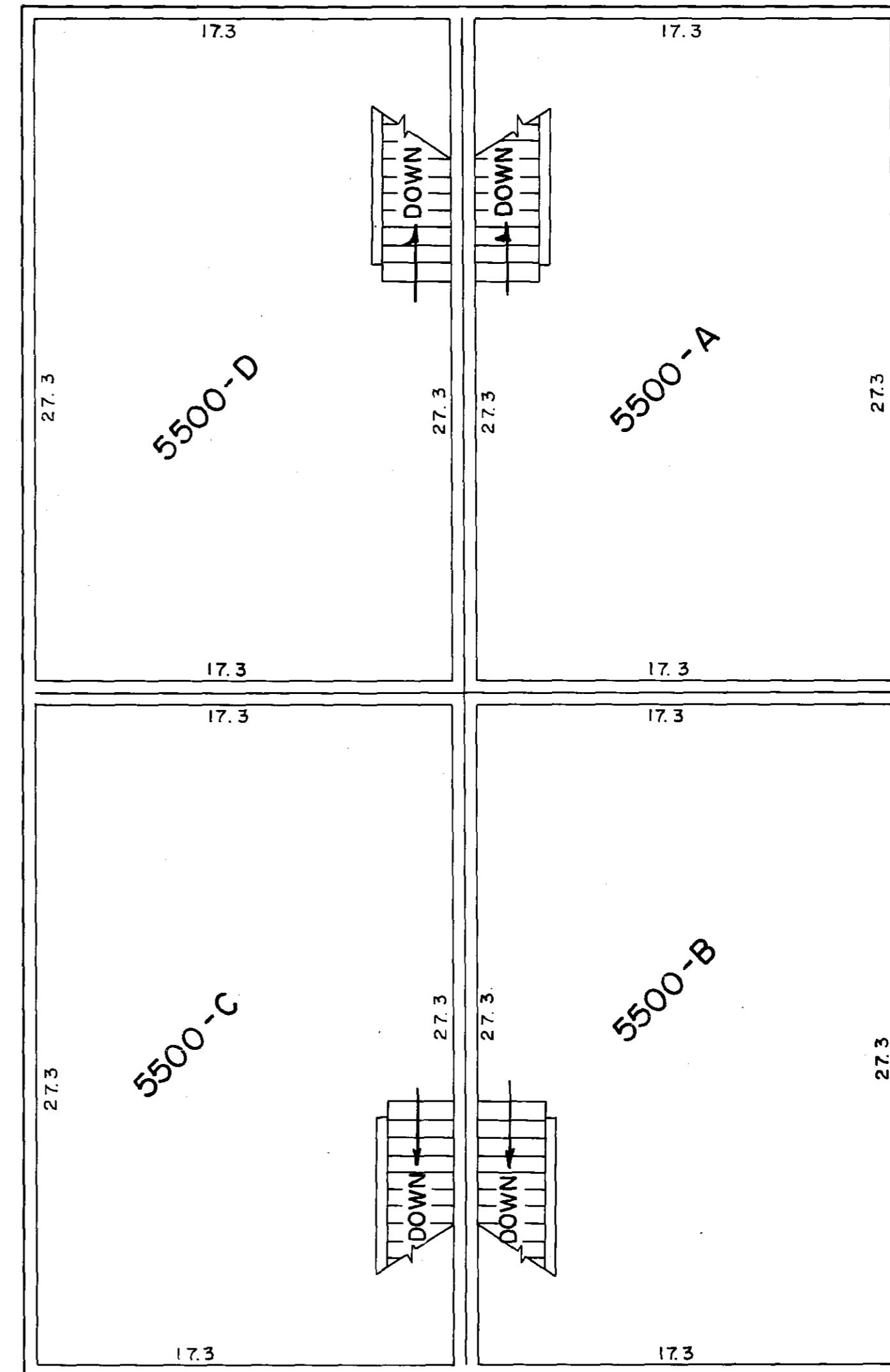

FLOOR ELEVATION 1041.94  
CEILING HEIGHT 8.05

## SECOND FLOOR

VERTICAL CONTROL

The elevations on this plan are based on the National Geodetic Vertical Datum of 1929.

# CONDOMINIUM NUMBER 84 LA QUESTA NORTH CONDOMINIUM FIRST SUPPLEMENTAL SITE PLAN

These Floor Plans have been recorded as part of the Declaration filed as Document No. 476577 on the 10 day of October A.D., 1984, Olmsted County Recorder.

**BENCH MARKS:**

Northeast Bolt Hydrant at 26th Avenue and 55th Street N.W. E1. 1032.58  
Northeast Bolt Hydrant on North Frontage Road midway between 26th Avenue and 28th Avenue N.W. E1. 1026.77

Elevations are based on the National Geodetic Vertical Datum of 1929.

Bearings are azimuths measured to the right from an assumed north.

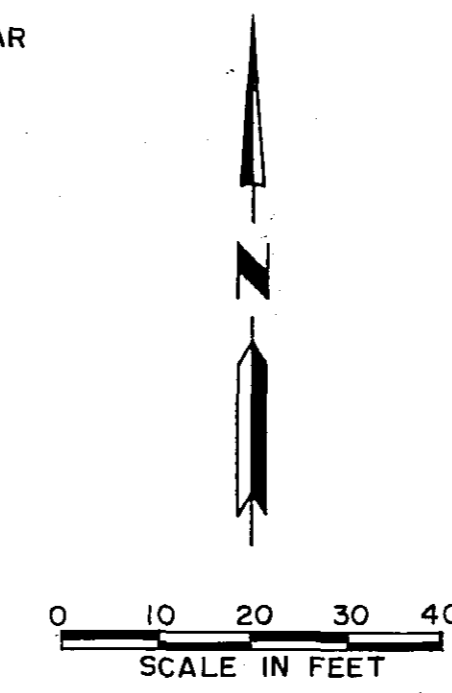
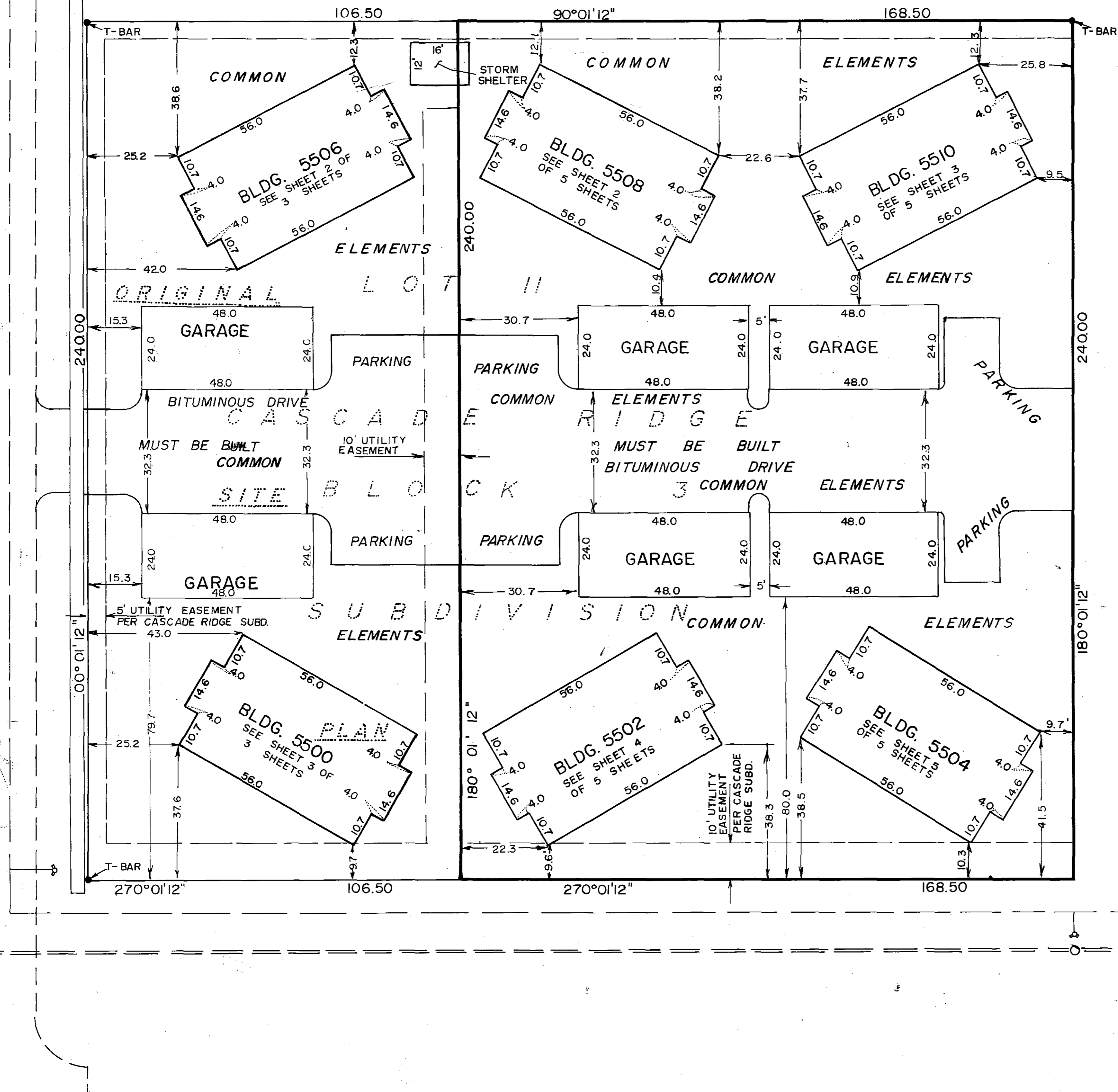

I hereby certify that the First Supplemental Site Plans for "LA QUESTA NORTH CONDOMINIUM" No. 84 being located upon the following described property:

All of Lot 11, Block 3, CASCADE RIDGE SUBDIVISION, according to the plat thereof on file in the County Recorders Office, Olmsted County, Minnesota, except the west 106.50 feet thereof.

Said tract contains 0.94 acres more or less.

Accurately depict all information required by Minnesota Statutes Section 515 A.2 - 110 and

I hereby certify that this survey, plan or report was prepared by me or under my direct supervision and that I am a duly Registered Land Surveyor under the laws of the State of Minnesota.

Date 10/8/84 Reg. No. 10162

NOTARY:

State of Minnesota  
County of Olmsted

The foregoing instrument was acknowledged before me this 8th day of OCTOBER, 19 84 by DONALD R. BORCHERT registered professional SURVEYOR.

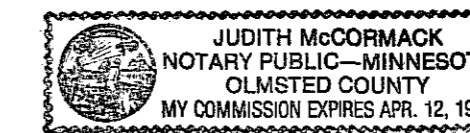

Judith McCormack  
Notary Public

I hereby certify that all structural components and mechanical systems serving more than one unit of all buildings containing or comprising any units hereby created are substantially completed consistent with the Floor Plans for "LA QUESTA NORTH CONDOMINIUM" (No. 84) and

I hereby certify that this plan, specification, or report was prepared by me or under my direct supervision and that I am a duly Registered Engineer under the laws of the State of Minnesota.

Date 10/8/84 Reg. No. 10162

NOTARY:

State of Minnesota  
County of Olmsted

The foregoing instrument was acknowledged before me this 8th day of OCTOBER, 19 84 by DONALD R. BORCHERT a registered professional ENGINEER.

Judith McCormack  
Notary Public

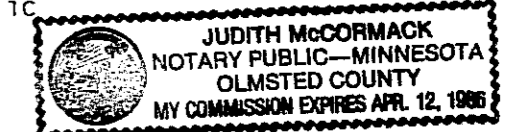

# CONDOMINIUM NUMBER 84 LA QUESTA NORTH CONDOMINIUM FLOOR PLAN

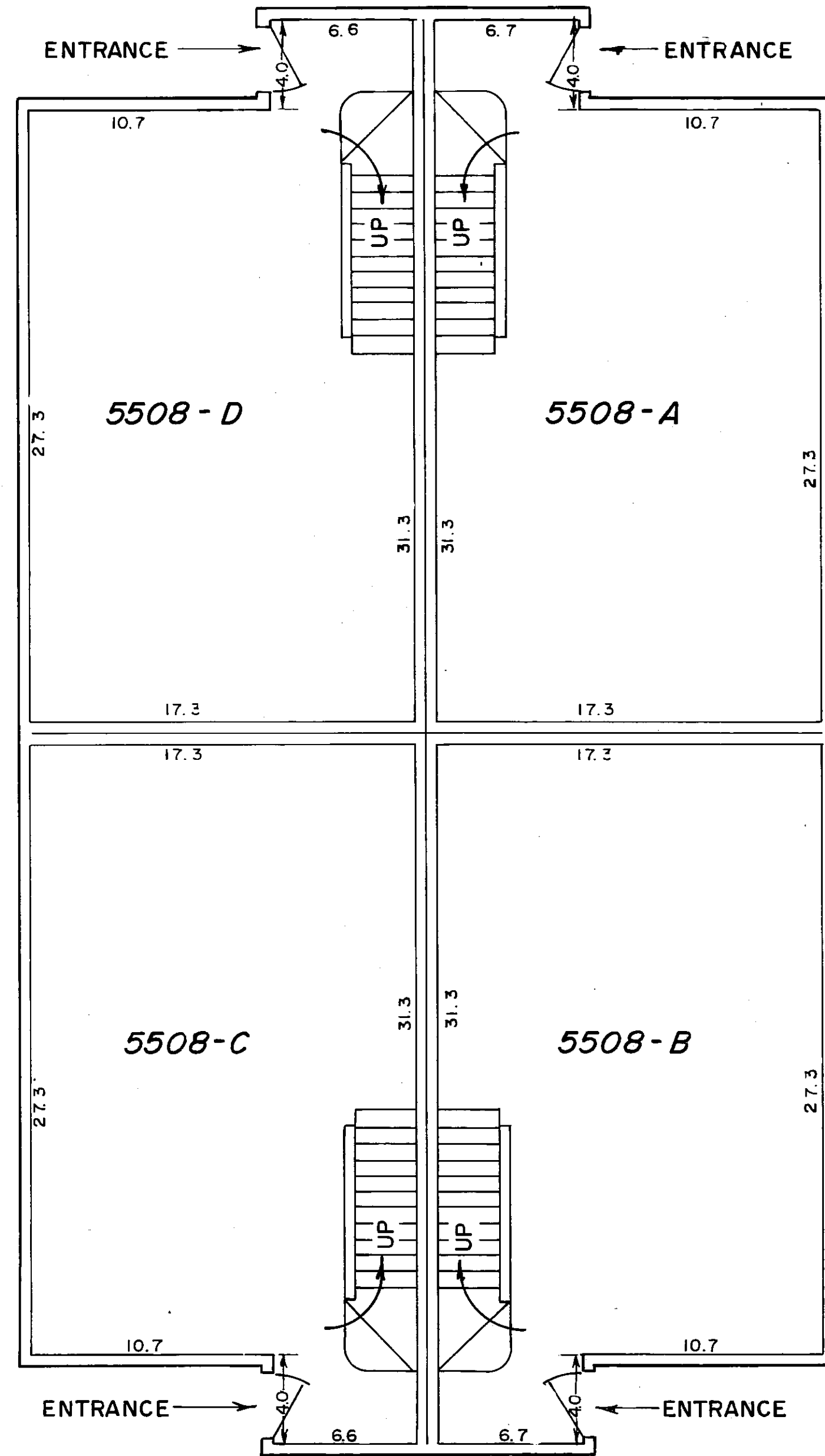

FINISHED FLOOR ELEV. 1040.5  
CEILING HEIGHT 8.1

## MAIN FLOOR

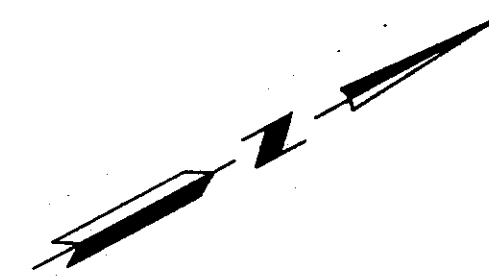

0 2 5 10  
SCALE IN FEET

Refer to Site Plan, Sheet 1 of  
5 Sheets for building location.  
Floor Elevations as shown are  
referenced to an established  
benchmark as shown on Site Plan.

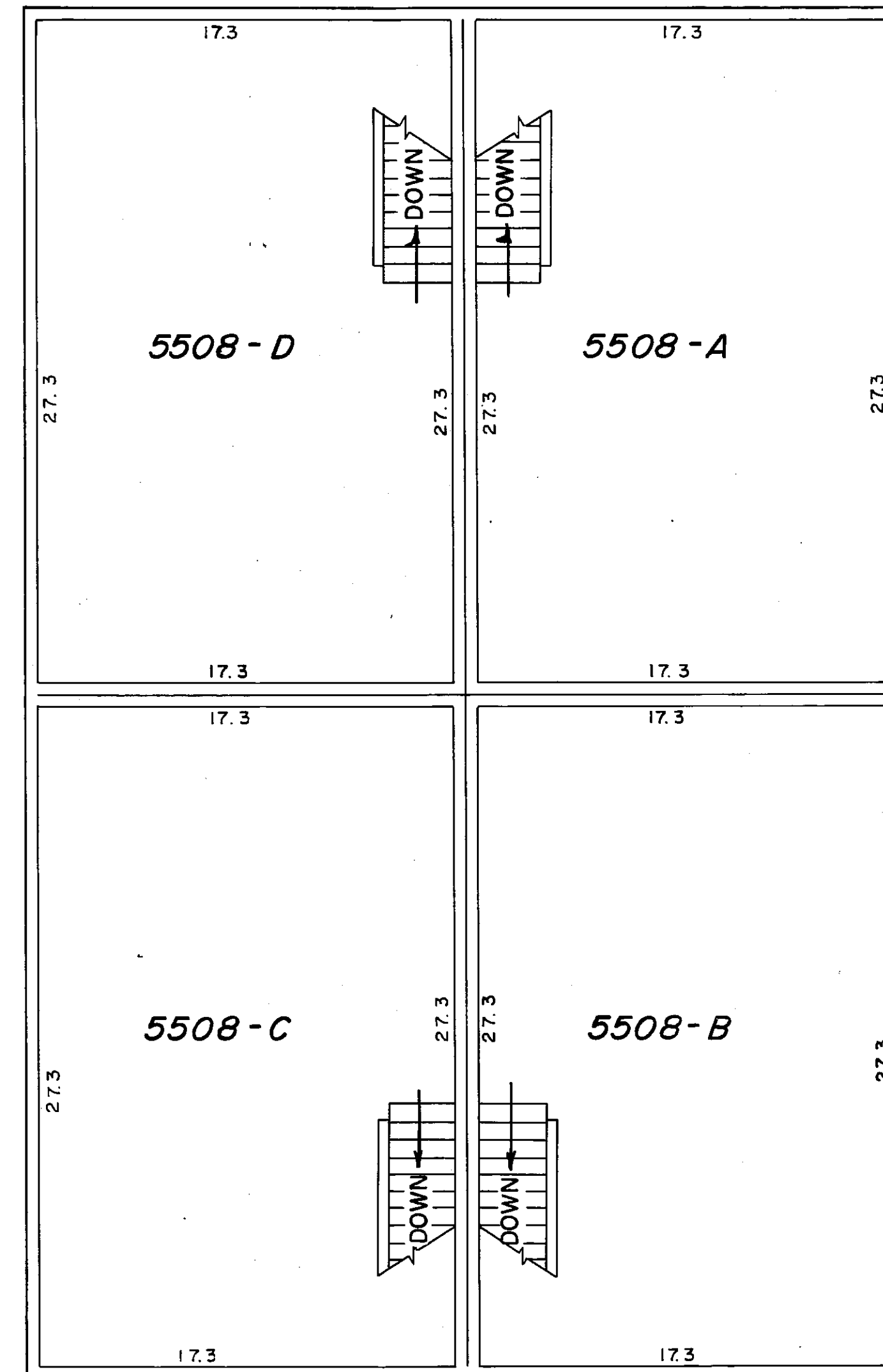

FINISHED FLOOR ELEV. 1049.6  
CEILING HEIGHT 8.1

## SECOND FLOOR

VERTICAL CONTROL

The elevations on this plan are based on the  
National Geodetic Vertical Datum of 1929.

# CONDOMINIUM NUMBER 84 LA QUESTA NORTH CONDOMINIUM FLOOR PLAN

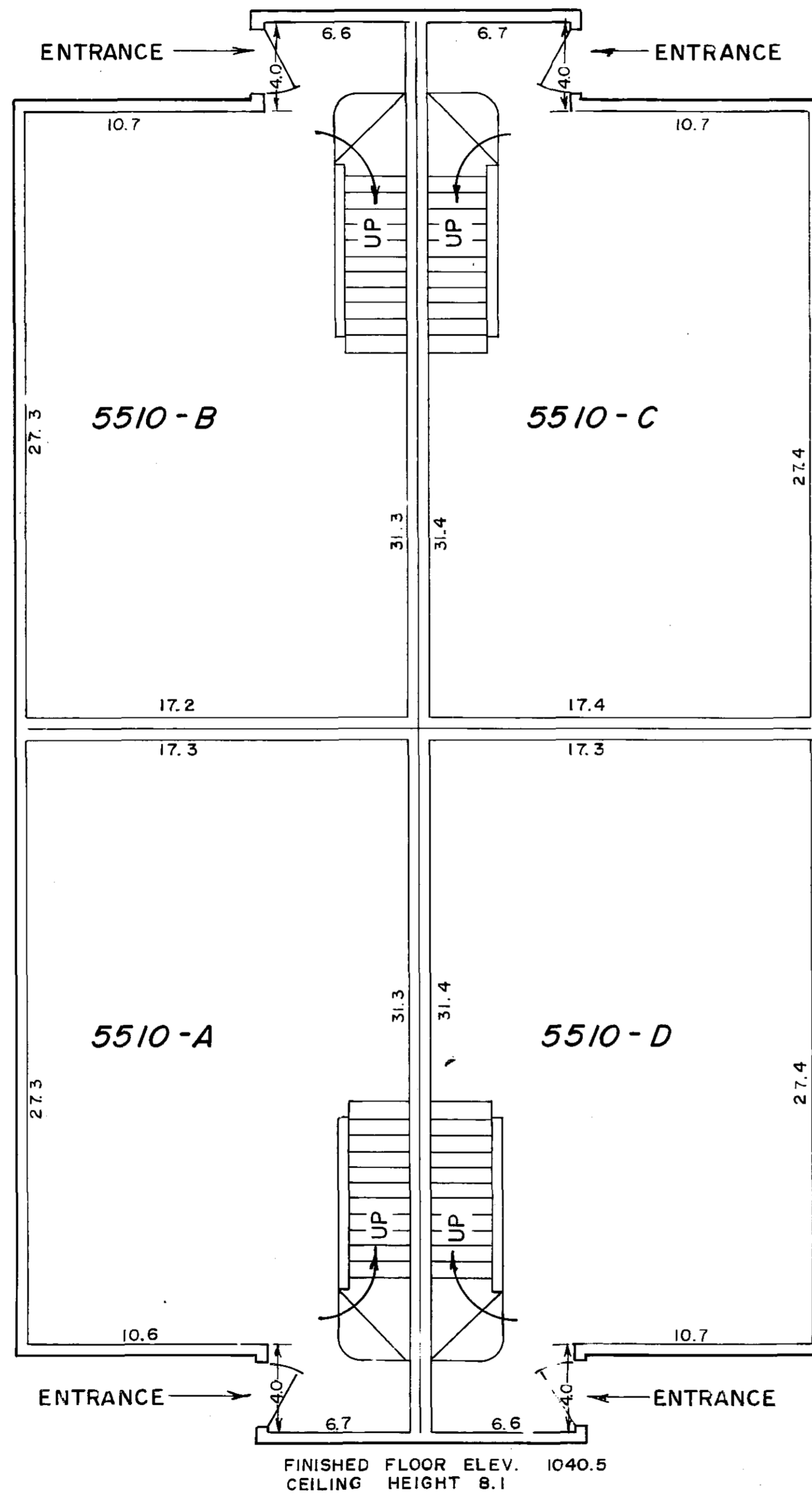

**MAIN FLOOR**

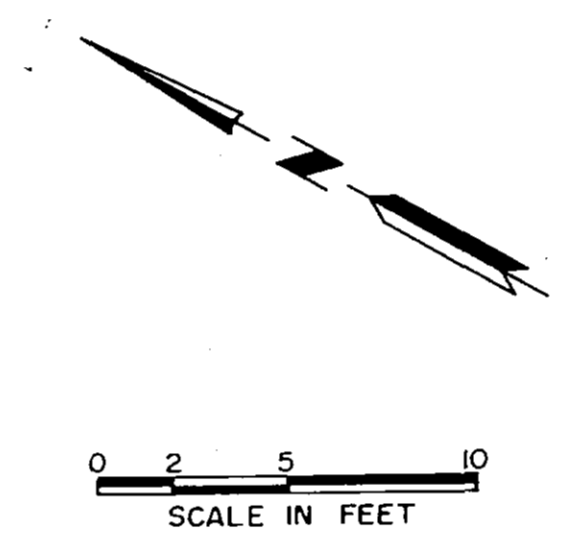

Refer to Site Plan, Sheet 1 of 5 Sheets for building location. Floor Elevations as shown are referenced to an established benchmark as shown on Site Plan.

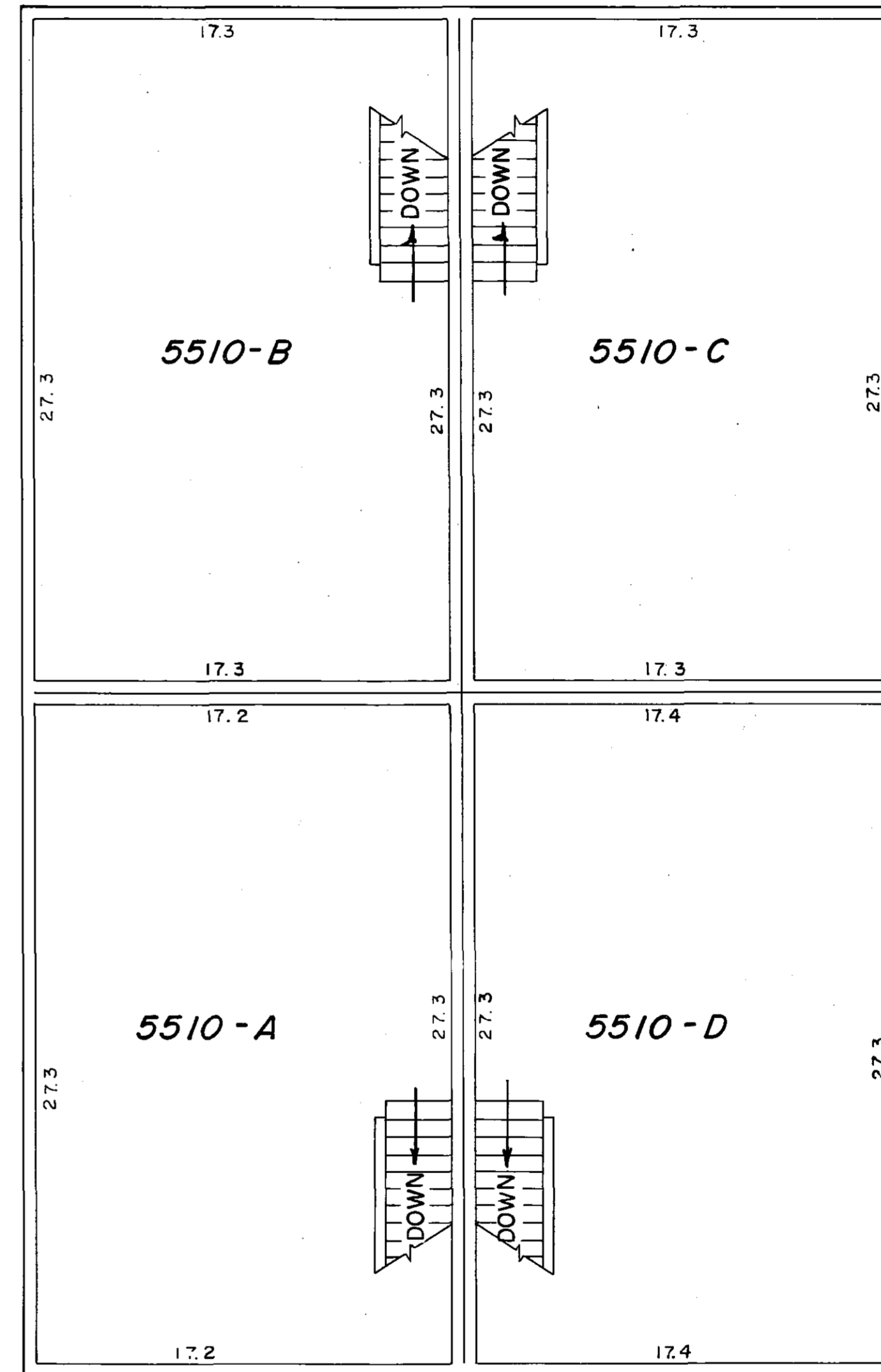

**SECOND FLOOR**

VERTICAL CONTROL

The elevations on this plan are based on the National Geodetic Vertical Datum of 1929.

# CONDOMINIUM NUMBER 84 LA QUESTA NORTH CONDOMINIUM FLOOR PLAN

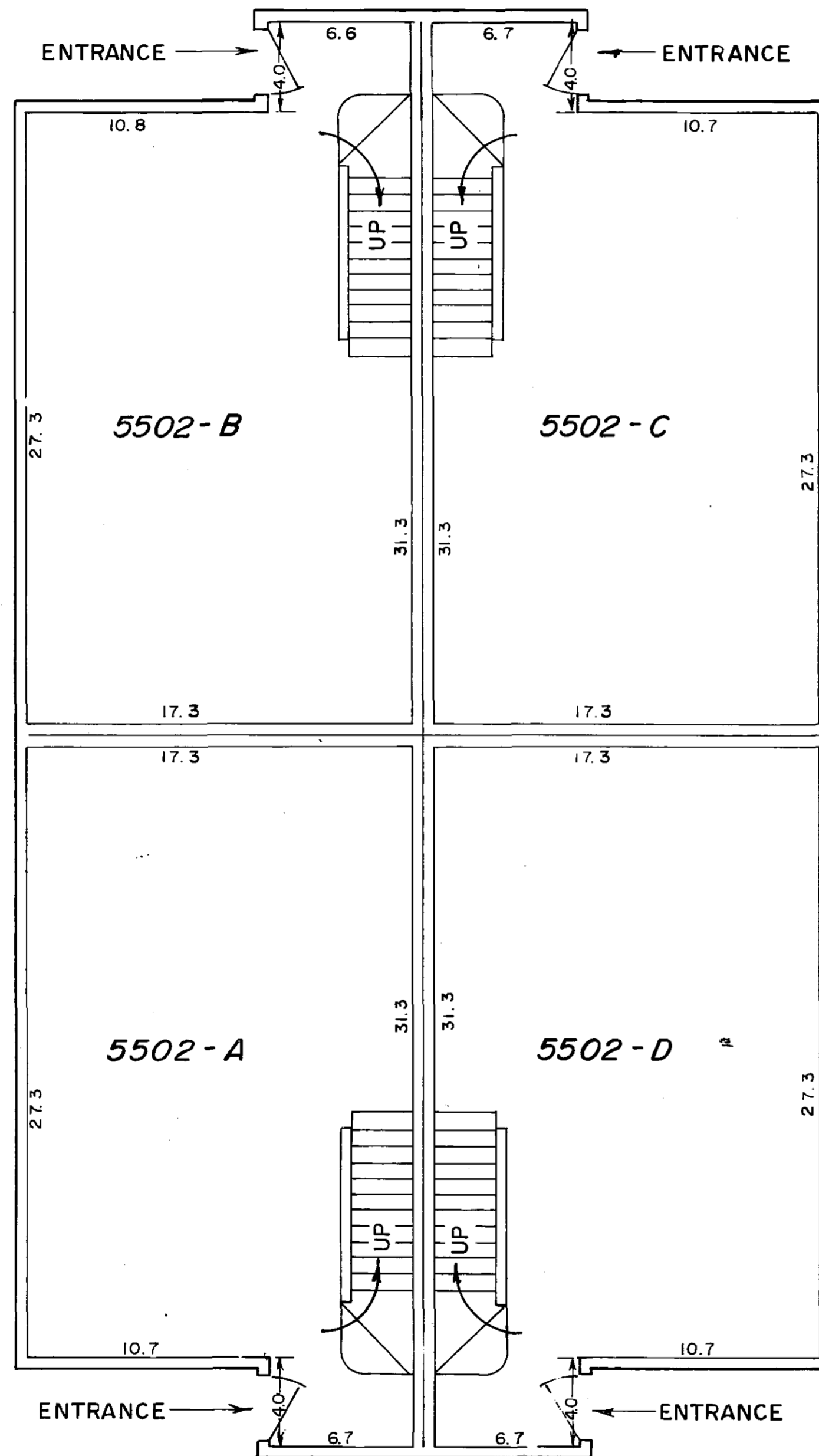

FINISHED FLOOR ELEV. 1032.0  
CEILING HEIGHT 8.1

## MAIN FLOOR

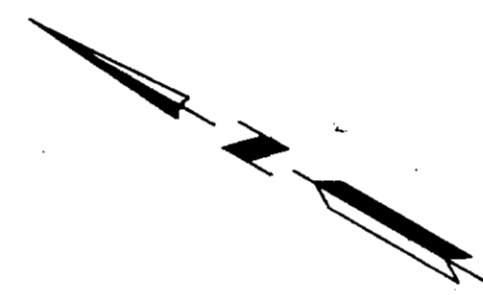

0 2 5 10  
SCALE IN FEET

Refer to Site Plan, Sheet 1 of  
5 Sheets for building location.  
Floor Elevations as shown are  
referenced to an established  
benchmark as shown on Site Plan.

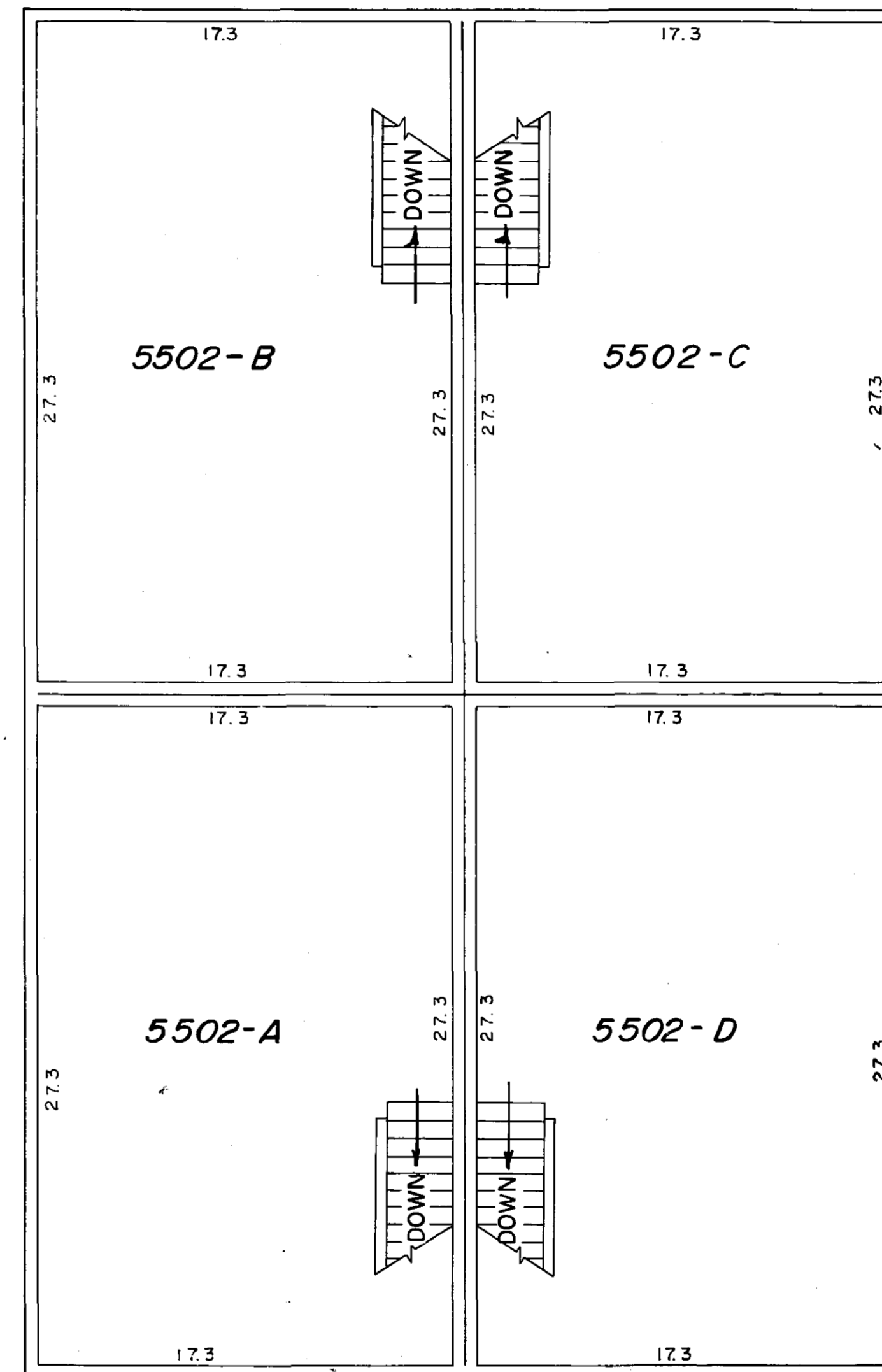

FINISHED FLOOR ELEV. 1041.1  
CEILING HEIGHT 8.1

## SECOND FLOOR

VERTICAL CONTROL

The elevations on this plan are based on the  
National Geodetic Vertical Datum of 1929.

# CONDOMINIUM NUMBER 84 LA QUESTA NORTH CONDOMINIUM FLOOR PLAN

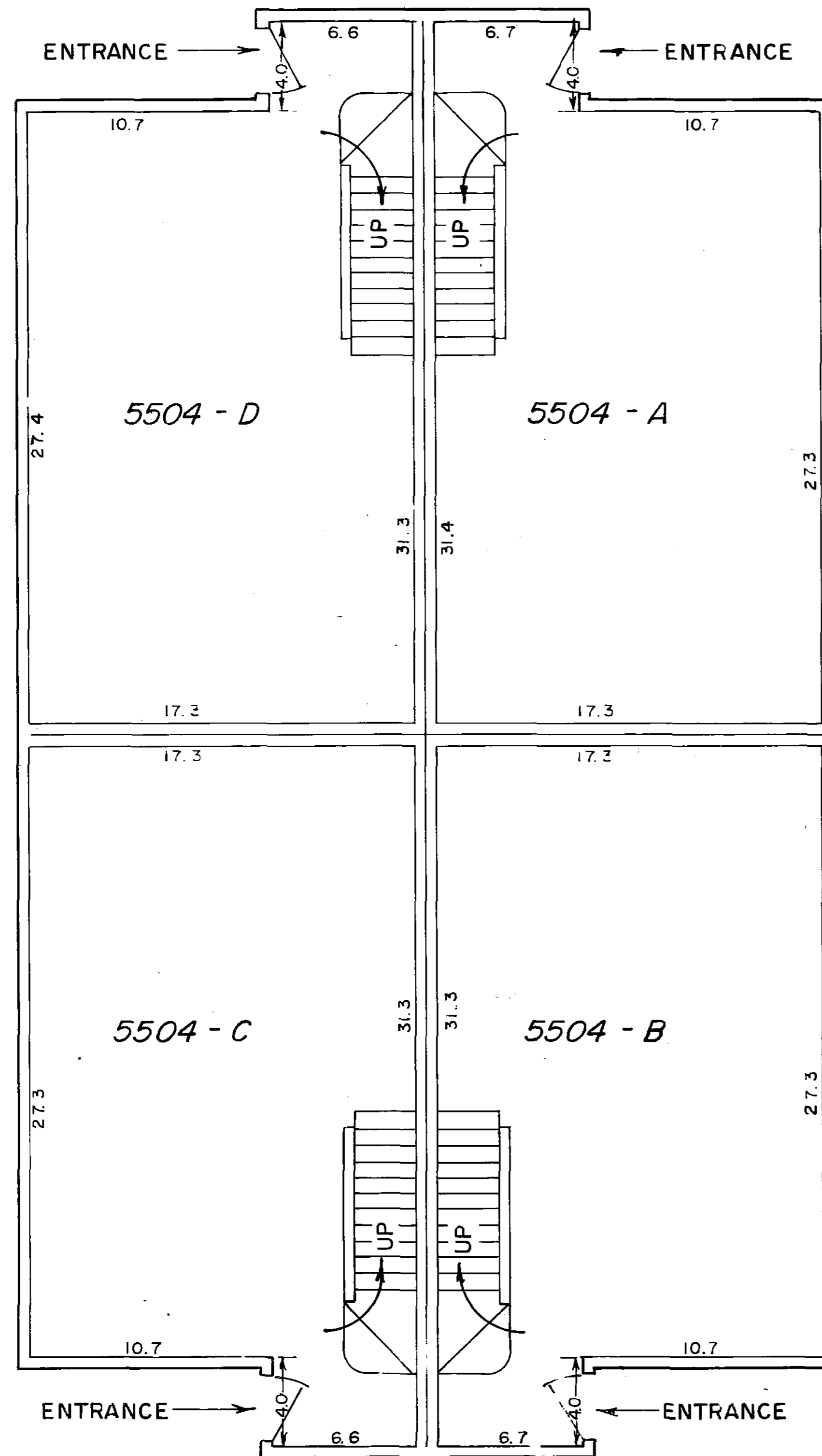

FINISHED FLOOR ELEV. 1031.5  
CEILING HEIGHT 8.1

## MAIN FLOOR

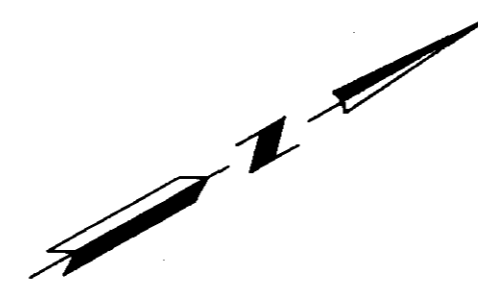

0 2 5 10  
SCALE IN FEET

Refer to Site Plan, Sheet 1 of  
5 Sheets for building location.  
Floor Elevations as shown are  
referenced to an established  
benchmark as shown on Site Plan.

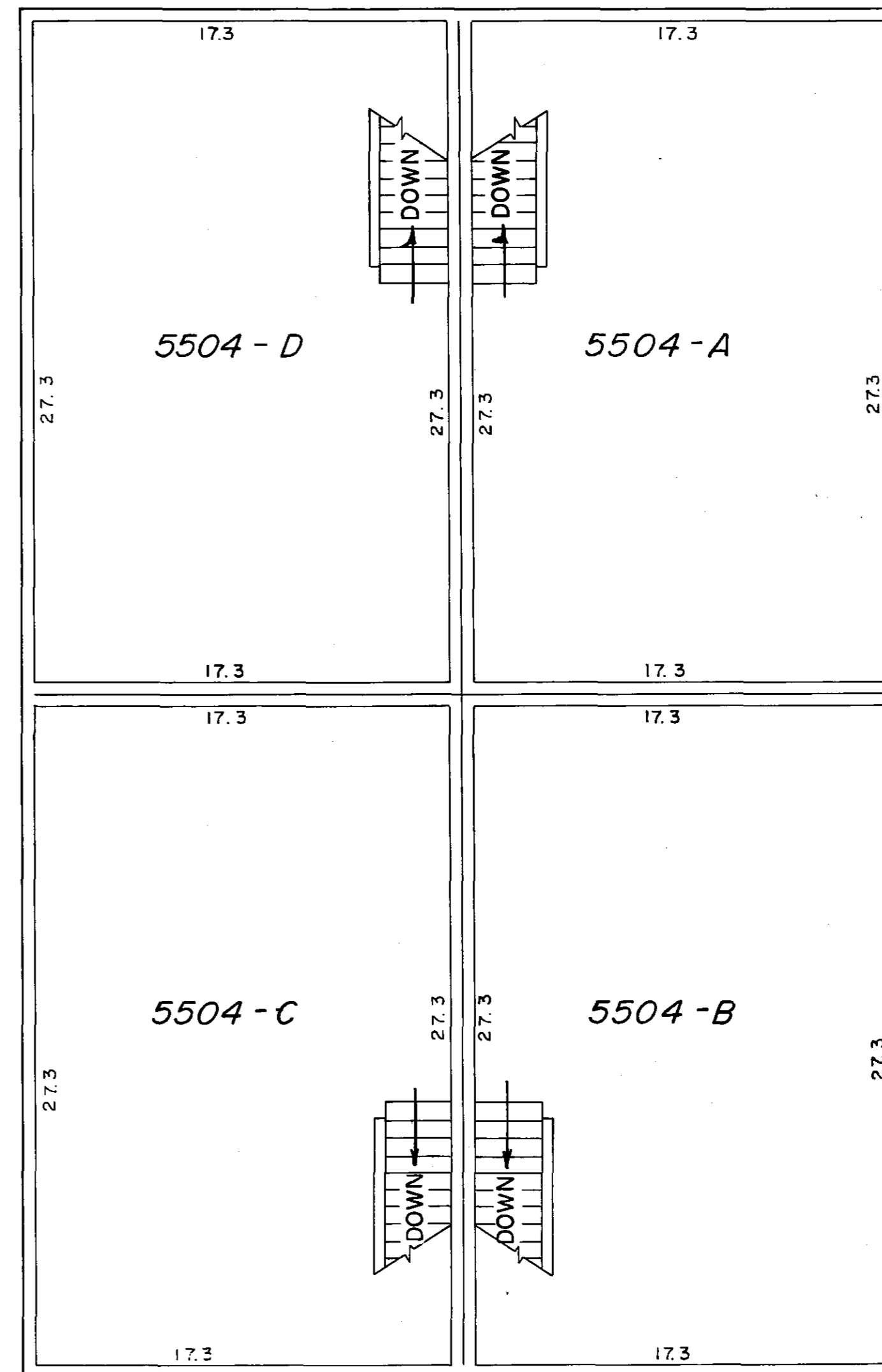

FINISHED FLOOR ELEV. 1040.6  
CEILING HEIGHT 8.1

## SECOND FLOOR

VERTICAL CONTROL

The elevations on this plan are based on the  
National Geodetic Vertical Datum of 1929.