

# BARCLAY SQUARE

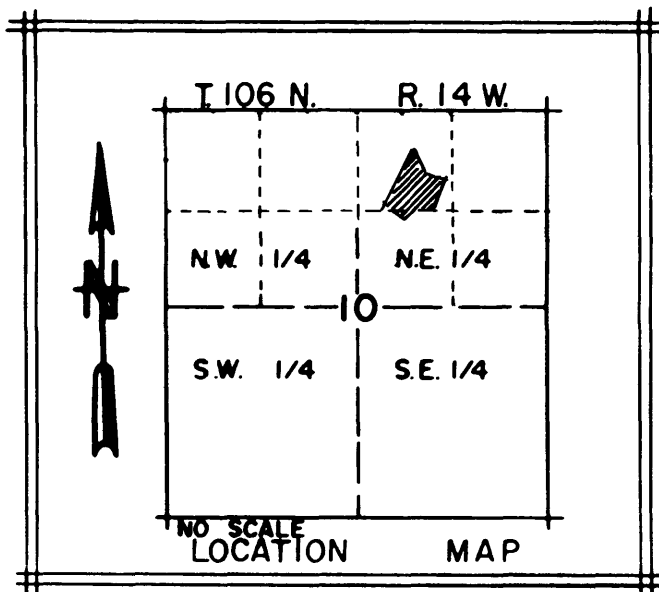

### BEARINGS

Plat bearings are Minnesota State Plane Grid Azimuths measured to the right from Grid North.

### MONUMENTS

- 1/2" Rebars
- 3/4" Iron Pipes
- Found Monuments (Pipe, Rod, Etc.)
- No Monuments Found or Set

All monuments set have a plastic cap stamped R.L.S. 10162.

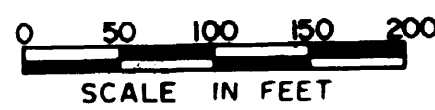

### COUNTY TREASURER

Taxes due and payable for the year 1984, have been paid as of this 24<sup>th</sup> day of April, 1984.

*Bob Ryan*  
Olmsted County Treasurer

STATE OF MINNESOTA

### CONTROLLED ACCESS DEFINED

Ingress or egress to, from or across the abutting roadway is restricted by the road authority pursuant to Minnesota State Statute 160.08.

### WATERMAIN EASEMENT DEFINED

An unobstructed easement for the construction and maintenance of a public watermain.

### UTILITY EASEMENT DEFINED

An unobstructed easement for the construction and maintenance of all necessary overhead, underground or surface, public utilities, including rights to conduct drainage and trimming on said easement.

### GAS MAIN EASEMENT

An unobstructed easement for the construction and maintenance of a gas main.

### SURVEYOR'S CERTIFICATE

I do hereby certify that I have surveyed and platted and replatted the property described on this plat as BARCLAY SQUARE, that this plat is a correct representation of said survey, that all distances are correctly shown on said plat in feet and hundredths of a foot, that all monuments have been correctly placed in the ground as shown, that the outside boundary lines are correctly designated and that there are no wetlands or public highways to be designated on said plat other than as shown.

*Donald R. Borcharding*  
DONALD R. BORCHARDING  
Minnesota R.L.S. 10162

STATE OF MINNESOTA  
COUNTY OF OLMSTED

The foregoing Surveyor's Certificate was acknowledged before me this 16<sup>th</sup> day of April, 1984 by Donald R. Borcharding, R.L.S. 10162.

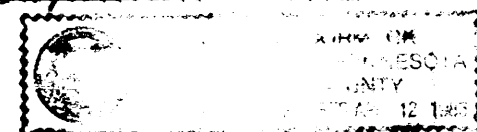

*Judith M. Cormack*  
Notary Public, Olmsted County, MN  
My Commission Expires 4-12-86

### INSTRUMENT OF DEDICATION

KNOW ALL MEN BY THESE PRESENTS: That George A. Baihly and Marion K. Baihly, husband and wife, owners and proprietors of the following described property situated in the County of Olmsted, State of Minnesota, to wit:

That part of Lot 2, Block 2, Green Meadows First Subdivision, according to the plat thereof on file in the County Recorders Office, Olmsted County, Minnesota, being described as follows:

Beginning at the northwest corner of said Lot 2; thence easterly on a Minnesota State Plane Grid azimuth from north of 88 degrees 54 minutes 30 seconds along the north line of said Lot 2 a distance of 180.00 feet; thence southwesterly 227 degrees 37 minutes 52 seconds azimuth 117.97 feet to the southwesterly line of said Lot 2; thence northwesterly 309 degrees 20 minutes 30 seconds azimuth along said southwesterly line 120.01 feet to the point of beginning.

Said tract contains 7004 square feet more or less.

KNOW ALL MEN BY THESE PRESENTS: That George R. Kerr, attorney in fact, on behalf of Charlyne Burks and Peter Burks, husband and wife, Gladys Fager, a single person, and Racheal Hendricks, a single person, all being owners and proprietors of the following described property situated in the County of Olmsted, State of Minnesota to wit:

That part of the North Half of the Northeast Quarter of Section 10, Township 106 North, Range 14 West, Olmsted County, Minnesota, described as follows:

Commencing at the Southwest Corner of said North Half of the Northeast Quarter; thence easterly on a Minnesota State Plane Grid Azimuth from North of 88 degrees 54 minutes 30 seconds along the south line of said North Half 383.63 feet to the point of beginning; thence continue easterly along said line 88 degrees 54 minutes 30 seconds azimuth 998.10 feet; thence northerly 11 degrees 11 minutes 21 seconds azimuth along a line 100.00 feet west and parallel with the centerline of the south bound lane of State Highway No. 52 a distance of 540.00 feet; thence westerly 281 degrees 11 minutes 21 seconds azimuth 190.00 feet; thence northwesterly 326 degrees 37 minutes 57 seconds azimuth 398.53 feet; thence westerly 276 degrees 11 minutes 16 seconds azimuth along the southerly right-of-way line of State Highway No. 52 a distance of 44.40 feet; thence southwesterly 212 degrees 34 minutes 06 seconds azimuth along the southeasterly right-of-way line of County Highway No. 8 a distance of 378.72 feet; thence southwesterly along a tangential curve concave to the northwest, having a radius of 5108.51 feet, and a central angle of 06 degrees 47 minutes 42 seconds, along said right-of-way line a distance of 605.85 feet; thence southwesterly 219 degrees 21 minutes 48 seconds azimuth along said right-of-way line 147.38 feet to the point of beginning.

Said tract contains 12.79 acres more or less.

Have caused the same to be surveyed and platted and replatted as BARCLAY SQUARE and do hereby grant the easements as shown on this plat.

In witness whereof said George A. Baihly and Marion K. Baihly have hereunto set their hands this 11<sup>th</sup> day of APRIL, 1984.

*George A. Baihly*  
George A. Baihly

*Marion K. Baihly*  
Marion K. Baihly

STATE OF MINNESOTA  
COUNTY OF OLMSTED

The foregoing instrument was acknowledged before me this 11<sup>th</sup> day of April, 1984 by George A. Baihly and Marion K. Baihly.

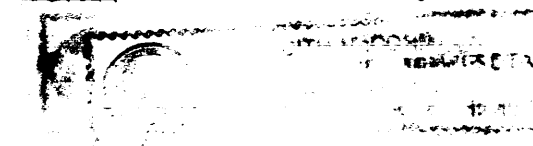

*Robert M. ...*  
Notary Public, Olmsted County, MN  
My Commission Expires ...

In witness whereof said George R. Kerr has hereunto set his hand this 1<sup>st</sup> day of April, 1984 A.D.

*George R. Kerr*  
George R. Kerr  
Attorney in Fact

STATE OF MINNESOTA  
COUNTY OF OLMSTED

The foregoing instrument was acknowledged before me this 16<sup>th</sup> day of April, 1984 A.D. by George R. Kerr as attorney in fact on behalf of Charlyne Burks, Peter Burks, Gladys Fager and Racheal Hendricks.

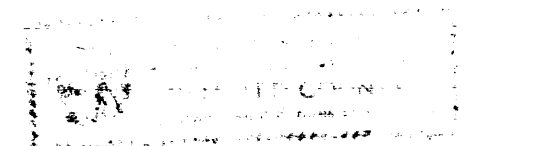

*Robert M. ...*  
Notary Public, Olmsted County, MN  
My Commission Expires ...

### CITY APPROVAL

STATE OF MINNESOTA  
COUNTY OF OLMSTED  
CITY OF ROCHESTER

I, Carole A. Grimm, City Clerk, in and for the City of Rochester, do hereby certify that on the 18 day of April, 1984, the accompanying plat was duly approved by the Common Council of the City of Rochester. In testimony whereof, I have hereunto signed my name and affixed the Seal of said City of Rochester this 24 day of April, 1984.

*Carole A. Grimm*  
Carole A. Grimm  
City Clerk

### COUNTY SURVEYOR

I certify that this plat has been checked mathematically and that the plat conforms to the applicable platting laws.

This 12<sup>th</sup> day of April, 1984

*Roger W. Brand*  
Olmsted County Surveyor

### COUNTY AUDITOR

No delinquent taxes due and transfer entered this 24<sup>th</sup> day of April, 1984.

*Ross ...*  
Olmsted County Auditor

### COUNTY RECORDER

Document Number

I hereby certify that this instrument was filed in the office of the County Recorder for record on this 24 day of April, 1984 at 3 o'clock P.M. and was duly recorded in Olmsted County Records.

### LOIS FINSTUEN

Olmsted County Recorder *Carole M. Fenice, Deputy*



PREPARED BY  
**YAGGY ASSOCIATES, INC.**  
CONSULTING ENGINEERS ■ PLANNERS ■ SURVEYORS  
ROCHESTER, MINNESOTA ■ MASON CITY, IOWA