

# BIRCHWOOD KNOLL SUBDIVISION

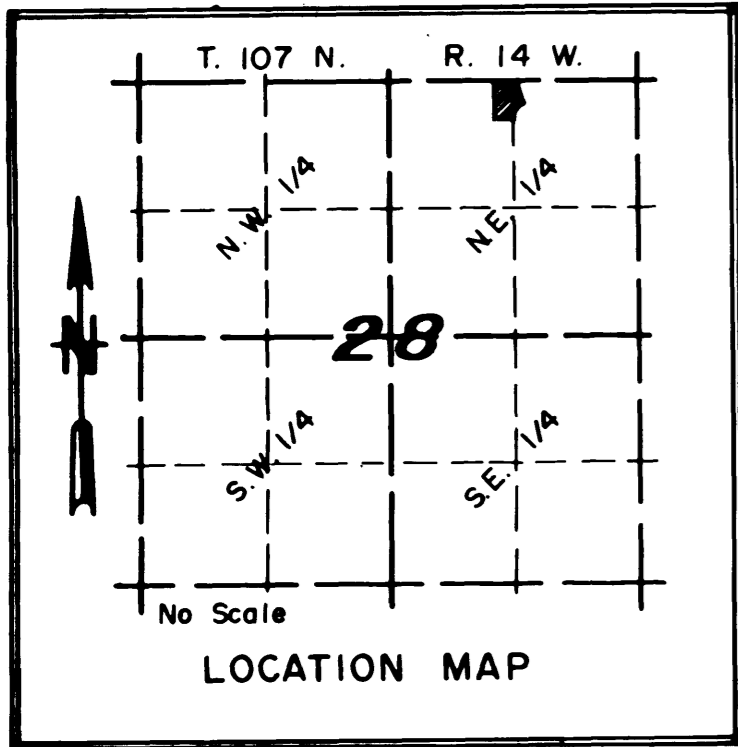

All monuments set have plastic cap stamped RLS 10162

- MONUMENTS**
- 1/2 Re-Bars
  - 3/4" Iron Pipes
  - Found Monument
  - 5/8" Iron Pipe unless otherwise noted

UNPLATTED

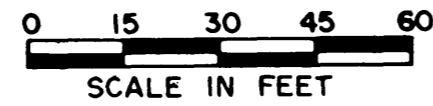

### INSTRUMENT OF DEDICATION

KNOW ALL MEN BY THESE PRESENTS: That Marc F. Carpenter and Helen P. Carpenter, his wife and George Grieve and Estelle Grieve, his wife, fee title holders and Clarence I. Horst and Elijah D. Horst, his wife and LeRoy A. Wood and Sandra K. Wood, his wife, contract for deed holders, all being owners and proprietors of the following described property situated in the County of Olmsted, State of Minnesota, to wit:

All of Lots 3 and 4, Block 1 of Northridge Second Subdivision, according to the plat thereof on file in the County Recorders Office, Olmsted County, Minnesota.

Have caused the same to be surveyed and replatted as BIRCHWOOD KNOLL SUBDIVISION, and grant the easements as shown on this plat.

In witness whereof said Marc F. Carpenter and Helen P. Carpenter have hereunto set their hands this 6<sup>th</sup> day of July, 1983.

Marc F. Carpenter      Helen P. Carpenter  
 Marc F. Carpenter      Helen P. Carpenter

STATE OF MINNESOTA  
 COUNTY OF OLMSTED

The foregoing instrument was acknowledged before me this 6<sup>th</sup> day of July, 1983 by Marc F. Carpenter and Helen P. Carpenter.

Dana C. Schmitt  
 Notary Public, Olmsted County, MN  
 My Commission Expires 11/8/87

In witness whereof said George Grieve and Estelle Grieve have hereunto set their hands this 6<sup>th</sup> day of July, 1983.

George Grieve      Estelle Grieve  
 George Grieve      Estelle Grieve

STATE OF MINNESOTA  
 COUNTY OF OLMSTED

The foregoing instrument was acknowledged before me this 6<sup>th</sup> day of July, 1983 by George Grieve and Estelle Grieve.

Dana C. Schmitt  
 Notary Public, Olmsted County, MN  
 My Commission Expires

In witness whereof said Clarence I. Horst and Elijah D. Horst have hereunto set their hands this \_\_\_\_\_ day of \_\_\_\_\_, 19\_\_\_\_.

Clarence I. Horst      Elijah D. Horst  
 Clarence I. Horst      Elijah D. Horst

STATE OF MINNESOTA  
 COUNTY OF OLMSTED

The foregoing instrument was acknowledged before me this 6<sup>th</sup> day of July, 1983 by Clarence I. Horst and Elijah D. Horst.

Notary Public, Olmsted County, MN  
 My Commission Expires 12

In witness whereof said LeRoy A. Wood and Sandra K. Wood have hereunto set their hands this \_\_\_\_\_ day of \_\_\_\_\_, 19\_\_\_\_.

LeRoy A. Wood      Sandra K. Wood  
 LeRoy A. Wood      Sandra K. Wood

STATE OF MINNESOTA  
 COUNTY OF OLMSTED

The foregoing instrument was acknowledged before me this \_\_\_\_\_ day of \_\_\_\_\_, 1983, by LeRoy A. Wood and Sandra K. Wood.

Notary Public, Olmsted County, MN  
 My Commission Expires 6/21/85

### UTILITY EASEMENT DEFINED

An unobstructed easement for the construction and maintenance of all necessary overhead, underground, or surface public utilities, including rights to conduct drainage and trimming on said easement.

### COUNTY SURVEYOR

I certify that this plat has been checked mathematically and that the plat conforms to the applicable platting laws.

Approved this 6<sup>th</sup> day of July, 1983

Robert W. Brand  
 Olmsted County Surveyor

### COUNTY AUDITOR

No delinquent taxes due and transfer entered this 1st day of August, 1983.

Melna Nelson  
 Olmsted County Auditor  
 Melna Nelson, Deputy

### COUNTY RECORDER

Document Number \_\_\_\_\_

I hereby certify that this instrument was filed in the office of the County Recorder for record on this 1 day of August, 1983, at 11:10 o'clock A..M. and was duly recorded in Olmsted County Records.

Lain Finstrom  
 Olmsted County Recorder.

### CITY APPROVAL

State of Minnesota  
 County of Olmsted  
 City of Rochester

I, Carole A. Grimm, City Clerk, in and for the City of Rochester, do hereby certify that on the 6 day of July, 1983, the accompanying plat was duly approved by the Common Council of the City of Rochester. In testimony whereof, I have hereunto signed my name and affixed the Seal of said City of Rochester this 7 day of July, 1983.

Carole A. Grimm  
 City Clerk

### SURVEYOR'S CERTIFICATE

I do hereby certify that I have surveyed and replatted the property described on this plat as BIRCHWOOD KNOLL SUBDIVISION that this plat is a correct representation of said survey, that all distances are correctly shown on said plat in feet and hundredths of a foot, that all monuments have been correctly placed in the ground as shown, that the outside boundary lines are correctly designated and that there are no wetlands or public highways to be designated on said plat other than as shown.

Donald R. Borcharding  
 DONALD R. BORCHARDING  
 Minnesota R.L.S. 10162

STATE OF MINNESOTA  
 COUNTY OF OLMSTED

The foregoing Surveyor's Certificate was acknowledged before me this 15 day of July, 1983 by Donald R. Borcharding, R.L.S. 10162.

Notary Public, Olmsted County, MN  
 My Commission Expires 12-21-85

### COUNTY TREASURER

Taxes due and payable for the year 1983 have been paid as of this 1st day of August, 1983.

Bob Ryan  
 Deputy County Treasurer  
 Olmsted County Treasurer