

# BUCK RIDGE SUBDIVISION

### INSTRUMENT OF DEDICATION

KNOW ALL MEN BY THESE PRESENTS THAT: Robert J. Gores, single, fee title holder, George M. Van Schaick and Dorothy L. Van Schaick, husband and wife, mortgagee and Buck Ridge Development Company, a partnership, option contract holder all being owners and proprietors of the following described property situated in the County of Olmsted, State of Minnesota, to wit:

That part of the Southeast Quarter of the Northwest Quarter and the Southwest Quarter of the Northeast Quarter and the Northwest Quarter of the Southeast Quarter and the East Half of the Southwest Quarter of Section 12, Township 107 North, Range 14 West, Olmsted County, Minnesota, described as follows:

Commencing at the center of said Section 12, thence northerly on a Minnesota State Plane Grid Azimuth from north of 359 degrees 02 minutes 02 seconds along the east line of said Northwest Quarter 588.27 feet; thence westerly 269 degrees 02 minutes 02 seconds azimuth 237.48 feet to the point of beginning; thence southeasterly 161.42 feet along a nontangential curve concave to the northeast having a radius of 733.00 feet central angle of 12 degrees 37 minutes 04 seconds and a chord azimuth of 124 degrees 31 minutes 50 seconds, thence southeasterly 118 degrees 13 minutes 18 seconds azimuth 129.21 feet; thence northeasterly 28 degrees 13 minutes 18 seconds azimuth 66.00 feet; thence southeasterly 118 degrees 13 minutes 18 seconds azimuth 200.00 feet; thence southeasterly 118 degrees 13 minutes 18 seconds azimuth 655.93 feet to the centerline of old State Highway No. 63; thence southwesterly 240 degrees 50 minutes 57 seconds azimuth along said centerline 163.78 feet; thence southerly along said centerline on a tangential curve concave to the east having a radius of 286.48 feet, central angle of 50 degrees 32 minutes 00 seconds a distance of 252.67 feet; thence southerly 190 degrees 18 minutes 57 seconds azimuth along said centerline 430.20 feet; thence westerly 269 degrees 35 minutes 16 seconds azimuth 198.94 feet; thence southerly 178 degrees 49 minutes 25 seconds azimuth 440.00 feet; thence westerly 269 degrees 32 minutes 23 seconds azimuth 192.00 feet to the west line of said Northwest Quarter of the Southeast Quarter; thence westerly 268 degrees 49 minutes 25 seconds azimuth 141.13 feet; thence southerly 178 degrees 49 minutes 25 seconds azimuth 135.65 feet; thence westerly 268 degrees 49 minutes 25 seconds azimuth 255.12 feet; thence southerly 178 degrees 49 minutes 25 seconds azimuth 412.20 feet; thence northwesterly 305 degrees 34 minutes 25 seconds azimuth 420 feet plus or minus to the centerline of the South Fork of the Zumbro River; thence northerly along said centerline 1660 feet plus or minus to its intersection with a line which bears 239 degrees 52 minutes 41 seconds azimuth from the point of beginning; thence northeasterly 59 degrees 52 minutes 41 seconds azimuth along said line 685 feet plus or minus to the point of beginning.

Said tract contains 40.1 acres more or less.

Have caused the same to be surveyed and platted as BUCK RIDGE SUBDIVISION and do hereby donate and dedicate to the public for public use forever the thoroughfares and grant the easements as shown on this plat.

In witness whereof said Robert J. Gores has hereunto set his hand this \_\_\_\_\_ day of \_\_\_\_\_, 19\_\_\_\_.

Robert J. Gores

STATE OF MINNESOTA  
COUNTY OF OLMSTED

The foregoing instrument was acknowledged before me this \_\_\_\_\_ day of \_\_\_\_\_, 19\_\_\_\_, by Robert J. Gores.

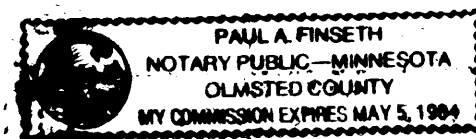

Notary Public, Olmsted Co., MN  
My Commission Expires \_\_\_\_\_

In witness whereof said George M. Van Schaick and Dorothy L. Van Schaick have hereunto set their hands this \_\_\_\_\_ day of \_\_\_\_\_, 19\_\_\_\_.

George M. Van Schaick      Dorothy L. Van Schaick

STATE OF MINNESOTA  
COUNTY OF OLMSTED

The foregoing instrument was acknowledged before me this 16<sup>TH</sup> day of September, 1980, by George M. Van Schaick and Dorothy L. Van Schaick.

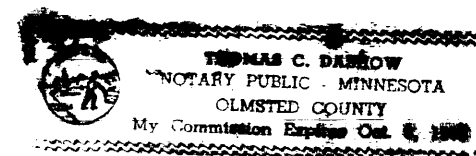

Thomas C. Dashow  
Notary Public, Olmsted Co., MN  
My Commission Expires \_\_\_\_\_

In witness whereof said Buck Ridge Development Company has caused these presents to be signed by its proper partners this 16<sup>TH</sup> day of September, 1980.

Robert F. Dashow - Partner

W.J. Nigbur - Partner

STATE OF MINNESOTA  
COUNTY OF OLMSTED

The foregoing instrument was acknowledged before me this \_\_\_\_\_ day of \_\_\_\_\_, 19\_\_\_\_, by Robert F. Dashow and W.J. Nigbur, partners of Buck Ridge Development Company, on behalf of the partnership.

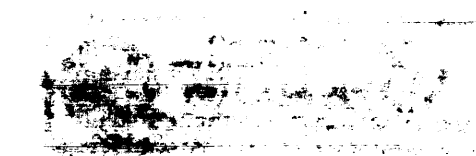

Louis D. Hunt  
Notary Public, Olmsted Co., MN  
My Commission Expires \_\_\_\_\_

### COUNTY SURVEYOR

I certify that this plat has been checked mathematically and that the plat conforms to the applicable platting laws.

Approved this 12<sup>TH</sup> day of Sept, 1980

Robert H. Brand  
Olmsted County Surveyor

### OLMSTED COUNTY HIGHWAY DEPARTMENT

Approved by the Olmsted County Highway Department

County Engineer

### BOARD OF COUNTY COMMISSIONERS

State of Minnesota  
County of Olmsted

I do hereby certify that the accompanying plat was duly approved by the Olmsted County Board of Commissioners at a meeting held on the day of \_\_\_\_\_, 19\_\_\_\_. In testimony whereof I have signed my name and affixed the seal of said county this \_\_\_\_\_ day of \_\_\_\_\_, 19\_\_\_\_.

Olmsted County Auditor

### SURVEYOR'S CERTIFICATE

I do hereby certify that I have surveyed and platted the property described on this plat as BUCK RIDGE SUBDIVISION, that this plat is a correct representation of said survey, that all distances are correctly shown on said plat in feet and hundredths of a foot, that all monuments have been correctly placed in the ground as shown, that the outside boundary lines are correctly designated and that there are no wetlands or public highways to be designated on said plat other than as shown.

Donald R. Borchherding  
Minnesota R.L.S. 10162

STATE OF MINNESOTA  
COUNTY OF OLMSTED

The foregoing Surveyor's Certificate was acknowledged before me this \_\_\_\_\_ day of \_\_\_\_\_, 19\_\_\_\_, by Donald R. Borchherding, Minnesota R.L.S. 10162.

Notary Public, Olmsted Co., MN  
My Commission Expires \_\_\_\_\_

### COUNTY AUDITOR - TAX STATEMENT

No delinquent taxes due and transfer entered this \_\_\_\_\_ day of \_\_\_\_\_, 19\_\_\_\_.

Olmsted County Auditor

### COUNTY RECORDER

Document Number 42455

I hereby certify that this instrument was filed in the office of the County Recorder for record on this 29<sup>th</sup> day of October, 1980, at 4:14 o'clock P.M. and was duly recorded in Olmsted County Records.

Louis Finseth  
Olmsted County Recorder  
By Nancy Johnson, Deputy

### OLMSTED COUNTY PLANNING ADVISORY COMMISSION

I hereby certify that the Olmsted County Planning Advisory Commission has examined the accompanying plat and found that it conforms to the provisions of the Subdivision Ordinance of Olmsted County.

Commission Chairperson

### TOWNSHIP BOARD OF SUPERVISORS

The Township Board of Supervisors for Cascade Township, Olmsted County, do hereby certify that we have approved the accompanying plat. In testimony whereof, we have signed our names this 5<sup>TH</sup> day of September, 1980.

Board Chairperson

Town Clerk

### OLMSTED COUNTY BOARD OF HEALTH

The Olmsted County Board of Health has approved this plat for water supply and sewage disposal system.

Public Health Engineer

# BUCK RIDGE SUBDIVISION

**EULER SPIRAL CURVE DATA**

CURVE	Δ	CURVE OFFSET	CHORD	CHORD AZIMUTH
SP-1	01° 11' 06"	125'	81.52	214° 33' 41"
SP-2	02° 50' 06"	75'	114.37	212° 36' 04"
SP-3	01° 01' 22"	75'	33.03	210° 36' 25"
SP-4	01° 07' 04"	75'	33.01	209° 32' 08"
SP-5	01° 09' 03"	75'	31.40	208° 23' 58"
SP-6	06° 37' 47"	75'	243.02	192° 21' 44"

**CIRCULAR CURVE DATA**

CURVE	Δ	R	L	CHORD
1	36° 06' 04"	267.00	168.23	165.46
2	22° 14' 33"	267.00	103.65	103.00
3	39° 11' 42"	60.00	41.04	40.25
4	93° 13' 20"	60.00	97.62	87.20
5	83° 47' 46"	60.00	87.75	80.14
6	81° 22' 18"	60.00	85.21	78.23
7	39° 11' 42"	60.00	41.04	40.25
8	06° 41' 43"	333.00	38.91	38.89
9	39° 07' 40"	333.00	227.41	223.02
10	12° 31' 14"	333.00	72.77	72.62
11	11° 41' 57"	1507.48	307.81	307.28

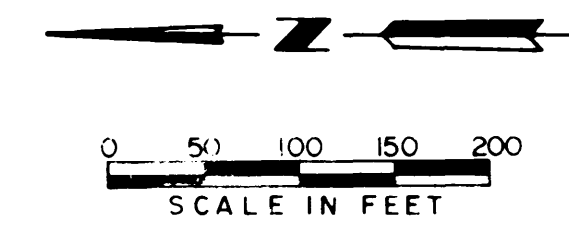

- MOMUMENTS**
- 1/2" Re-bars
  - 3/4" Iron Pipes
  - Found Monuments (As shown)

All monuments set have a plastic cap stamped RLS 10162

**CONTROLLED ACCESS DEFINED**  
Ingress or egress to, from, or across the abutting roadway is restricted by the road authority pursuant to Minnesota State Statute 160.08.

**UTILITY EASEMENT DEFINED**  
An unobstructed easement for the construction and maintenance of all necessary overhead, underground, or surface public utilities, including rights to conduct drainage and trimming on said easement.

**VERTICAL CONTROL**  
The elevations on this plan are based on the National Geodetic Vertical Datum of 1929.

**BENCH MARK**  
Std. M.H.D. Disc. - 1.7 miles S. of Co. Rd. 14, 160 feet E. T.H. No. 63.  
75' E-S.E. of P.P.  
12' W 12" Elm tree  
8' S. of private drive to VanSchaick Res.  
2' N. of fence line  
1' W. of witness post  
Elevation 1032.148

**HIGHEST KNOWN WATER ELEVATION**  
960.00 feet on July 6, 1978. Obtained from Department of Natural Resources Aerial Photos.

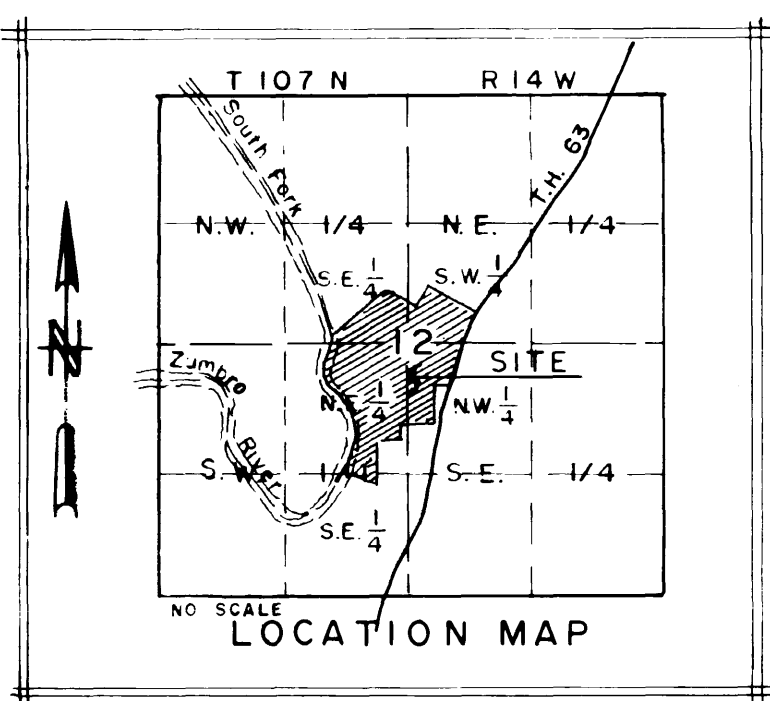

20

566-79

PREPARED BY  
**YAGGY ASSOCIATES, INC.**  
CONSULTING ENGINEERS ■ PLANNERS ■ SURVEYORS  
ROCHESTER, MINNESOTA ■ MASON CITY, IOWA

LAND SURVEYORS CERTIFICATE OF PLAT CORRECTION

BUCK RIDGE SUBDIVISION

586882

Pursuant to the provisions of Chapter 505.174, Laws of Minnesota 1957, Donald R. Borcharding, the undersigned, a Registered Land Surveyor in and for the State of Minnesota, declares as follows:

I prepared the plat of BUCK RIDGE SUBDIVISION dated September 16, 1980, and filed on October 29, 1980 in the office of the County Recorder, Olmsted County Minnesota, Document #429959.

That said plat contains an omission in the following particulars to wit:

- A. WHEREAS the most southerly line of outlot A, as shown on the plat, was originally described by John Kerr, RLS #238 as following the "center line of said Dry Ravine".
- B. WHEREAS, Richard J. Halverson, RLS #9385 during a survey dated October 19, 1989 has redefined the "center line of said Dry Ravine", which no longer follows the same alignment as determined by John Kerr.
- C. WHEREAS, this new description of the "center line of said Dry Ravine" has created an apparent encroachment into said Outlot A.
- D. WHEREAS, the call for the "center line of said Dry Ravine" in the original deed would take precedence over any bearing and distance used to approximate said center line.
- E. WHEREAS, the call for the "center line of said Dry Ravine" was omitted from the plat and the description in the Instrument of Dedication in BUCK RIDGE SUBDIVISION.

THEREFORE, said plat is hereby corrected in the following particulars to wit:

Lines 29 and 30 of the body of the description in the Instrument of Dedication shall be revised to read as follows:

"southerly 178 degrees 49 minutes 25 seconds azimuth 412.20 feet to the center line of the Dry Ravine; thence northwesterly 305 degrees 34 minutes 25 seconds azimuth along said center line of the Dry Ravine 420 feet"

  
Donald R. Borcharding  
6/23/90 AND 10/62  
Date SURVEYOR Reg. No.  
STATE OF MINNESOTA

STATE OF MINNESOTA

COUNTY OF OLMSTED

The foregoing Land Surveyors Certificate of Plat Correction was acknowledged before me this 15<sup>th</sup> day of June, 1990 by Donald R. Borcharding, R.L.S. #10162.

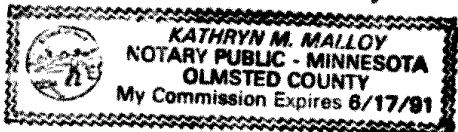

Kathryn M. Malloy  
Notary Public, Olmsted County, MN  
My Commission Expires 6-17-91

COUNTY SURVEYOR

This Land Surveyors Certificate of Plat Correction has been checked and approved this 20 day of June, 1990.

Edward Kusale  
Olmsted County Surveyor

BOARD OF COUNTY COMMISSIONERS

STATE OF MINNESOTA

COUNTY OF OLMSTED

I do hereby certify that the accompanying Land Surveyors Certificate of Plat Correction was duly approved by the Olmsted County Board of Commissioners at a meeting held on the 10<sup>th</sup> day of July, 1990. In testimony whereof I have signed my name and affixed the seal of said County this 10<sup>th</sup> day of July, 1990.

Samuel J. Hamelster, Deputy  
Olmsted County Auditor

COUNTY RECORDER

**586882**

DOCUMENT NUMBER \_\_\_\_\_

I hereby certify that this instrument was filed in the Office of the County Recorder for record on this 27 day of July, 1990, at 1/2 o'clock P.m. and was duly recorded in the Olmsted County records.

*bk. 7-5 Page 306*

By LOIS FERGUSON  
County Recorder

Carol Ann Ferris  
Deputy

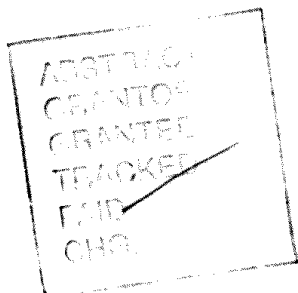

*Yaggy Dalby Assoc.*