

# HOLLISTON'S ADD.

TO

# ORONOCO



I hereby certify that this is a correct Plat of Holliston's Addition to the City Village of Oronoco (which is a continuation of Blocks fifteen (15) and twenty (20) of the original Survey of the Town of Oronoco) as surveyed by me on the first day of September A.D. 1856 and is situated in the North East Corner of the Mill Site Reservation

Robert K. Hitchcock  
Surveyor

I James Holliston the proprietor of Holliston's Addition to the village of Oronoco do certify and acknowledge that the said addition of which this is a correct plat, was laid out according to my desire and direction.

James Holliston  
Proprietor

James Holliston

State of Minnesota

County of Olmsted

Do it known that on this 31st day of December 1858 personally appeared before me James Holliston who acknowledges himself to be the Proprietor of Holliston's Addition to the village of Oronoco of which the above is a correct plat of said and that it was laid out according to his desire and direction.

Robert K. Hitchcock  
Justice of the Peace

Filed July 10th 1859 at 4 P.M. Recorded in...

J. J. Kerr

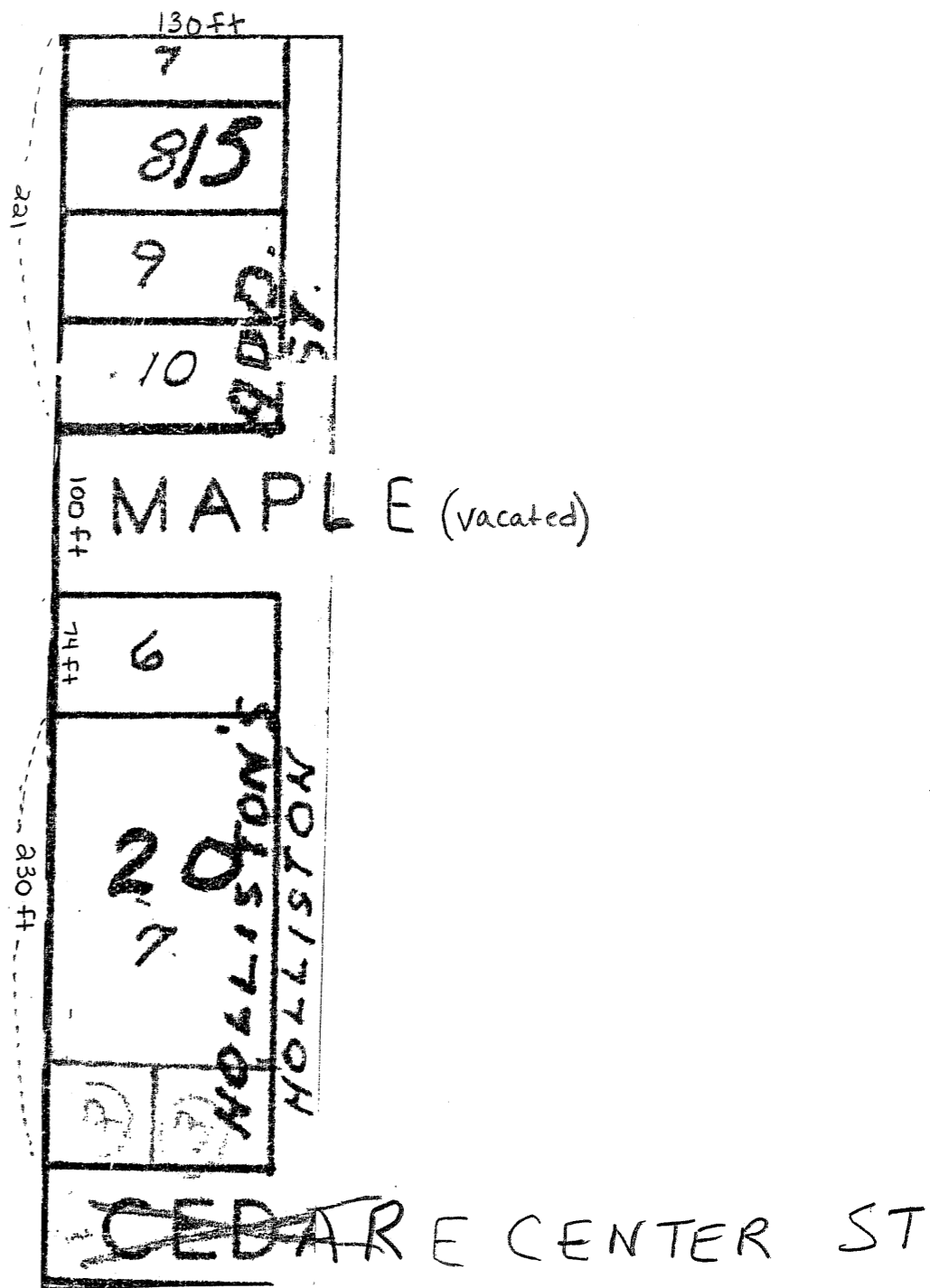

## HOLLISTON'S ADDITION TO ORONOCO

The above map is not an official plat map, but shown here for reference purposes only.

Map copy has been taken from a City of Oronoco Map surveyed by John J. Kerr, surveyor's number 328.

Date unknown.