

State of Minnesota )  
County of Olmsted ) ss.

I, C. H. Armstrong, County Surveyor, in and for the County of Olmsted, State of Minnesota, do hereby certify that at the request of F. R. Mosse and Flora L. Mosse, husband and wife, I did survey, lay out, and stake out into lots, blocks, streets and avenues all the following described pieces and parcels of land to be known and designated as "Mosse Re-Subdivision" of parts of Blocks 17 and 18 in Cummings' Addition, as herein described as follows, to-wit:-

Commencing at the Southwest corner of Block Seventeen in Cummings' Addition to the City of Rochester, where the north line of Second Street Northwest intersects the East line of Eighth Place Northwest, and running north on the east line of Eighth Place Northwest one hundred fifty four (154) feet, thence east parallel with the north line of Second Street Northwest one hundred forty nine (149) feet, thence northerly parallel to the west line of Eighth Avenue Northwest, to a point forty four (44) feet north of the north line of Third Street Northwest, thence east parallel with the north line of Third Street Northwest one hundred fifty three and one-half (153 1/2) feet to the west line of Eighth Avenue Northwest, thence southerly along the west line of Eighth Avenue Northwest forty four (44) feet, thence westerly on the north line of Third Street Northwest four and one-half (4 1/2) feet, thence south along the west line of Eighth Avenue Northwest to the north line of Second Street Northwest, thence west on the north line of Second Street Northwest to place of beginning.

Dated at Rochester, Minnesota, this 29th day of March, A.D. 1920.

C. H. Armstrong,  
County Surveyor.

Subscribed and sworn to before me, a Notary Public within and for said County and State this 29th day of March, A.D. 1920.

I. L. Eckholdt,  
Notary Public.  
My commission expires Dec. 1, 1926.

DEDICATION

We, the undersigned, F. R. Mosse and Flora L. Mosse, husband and wife, do hereby certify that we are the owners of the following described tract or parcel of land situated and being within the corporate limits of the City of Rochester in the County of Olmsted and State of Minnesota, to-wit:-

Commencing at the Southwest corner of Block Seventeen in Cummings' Addition to the City of Rochester where the north line of Second Street Northwest, intersects the east line of Eighth Place Northwest, and running North on the east line of Eighth Place Northwest one hundred fifty four (154) feet, thence east parallel with the north line of Second Street Northwest one hundred forty nine (149) feet thence northerly parallel to the west line of Eighth Avenue Northwest to a point forty four (44) feet north of the north line of Third Street Northwest, thence east parallel with the north line of Third Street Northwest one hundred fifty three and one-half (153 1/2) feet to the west line of Eighth Avenue Northwest, thence southerly along the west line of Eighth Avenue Northwest forty four (44) feet, thence westerly on the north line of Third Street Northwest four and one-half (4 1/2) feet, thence south along the west line of Eighth Avenue Northwest to the north line of Second Street Northwest, thence west on the north line of Second Street Northwest to place of beginning.

And we further certify that we have caused the same to be surveyed and platted into blocks, lots, streets and avenues as a Re-Subdivision in the City of Rochester, to be known and designated as "Mosse Re-Subdivision", of parts of Blocks 17 and 18 in Cummings' Addition, and that we do for ourselves, our heirs and assigns hereby grant and dedicate the streets and avenues as laid down on the accompanying plat to the City of Rochester and for the public use as such forever.

IN TESTIMONY WHEREOF, we have hereunto set our hands and seals this 29th day of March, A.D. 1920.

F. R. Mosse, (SEAL)  
Flora L. Mosse (SEAL)

Signed and sealed in the presence of

Thomas Fraser  
Mabel Rausch

State of Minnesota )  
County of Olmsted ) ss.

On this 29th day of March, A.D. 1920, before me a Notary Public within and for said County, personally appeared Frederick R. Mosse and Flora L. Mosse, husband and wife, to me known to be the persons who executed the foregoing instrument and acknowledged that they executed the same as their free act and deed for the purposes therein set forth.

Thomas Fraser  
Notary Public  
My Commission expires July 16th, 1920.

State of Minnesota )  
County of Olmsted ) ss.  
City of Rochester )

I, A. F. Wright, City Clerk in and for said City, do hereby certify that on the 29th day of March, A.D. 1920, the accompanying plat was duly approved by the Common Council of the said City of Rochester.

IN TESTIMONY WHEREOF, I have hereunto signed my name and affixed the seal of said City, this 30th day of March, A.D. 1920.

A. F. Wright,  
City Clerk.

Taxes paid and transfer entered this \_\_\_\_\_ day of \_\_\_\_\_, A.D. 1920.

Amiel Glabe  
County Auditor.

Taxes for the year 1919, on the lands described within are paid.

Geo. J. Fullerton  
County Treasurer.

State of Minnesota )  
County of Olmsted ) ss.

Filed for record this \_\_\_\_\_ day of March, A.D. 1920, at \_\_\_\_\_ o'clock, \_\_\_\_\_ M. Book \_\_\_\_\_ of Plats on page \_\_\_\_\_.

Walter Eckholdt  
Register of Deeds.

State of Minnesota,  
County of Olmsted. ) ss.

I, Walter Eckholdt, Register of Deeds, in and for said County and State, do hereby certify that I have compared the foregoing copy of the Plat of Mosse Re-Subdivision of the City of Rochester, Olmsted County, Minnesota, with the original plat, Record on file in my office, and that the same is a true and correct copy of said original and the whole thereof.

Witness my hand and official seal at Rochester in said County this \_\_\_\_\_ day of \_\_\_\_\_, 1920.

Walter Eckholdt  
Register of Deeds.

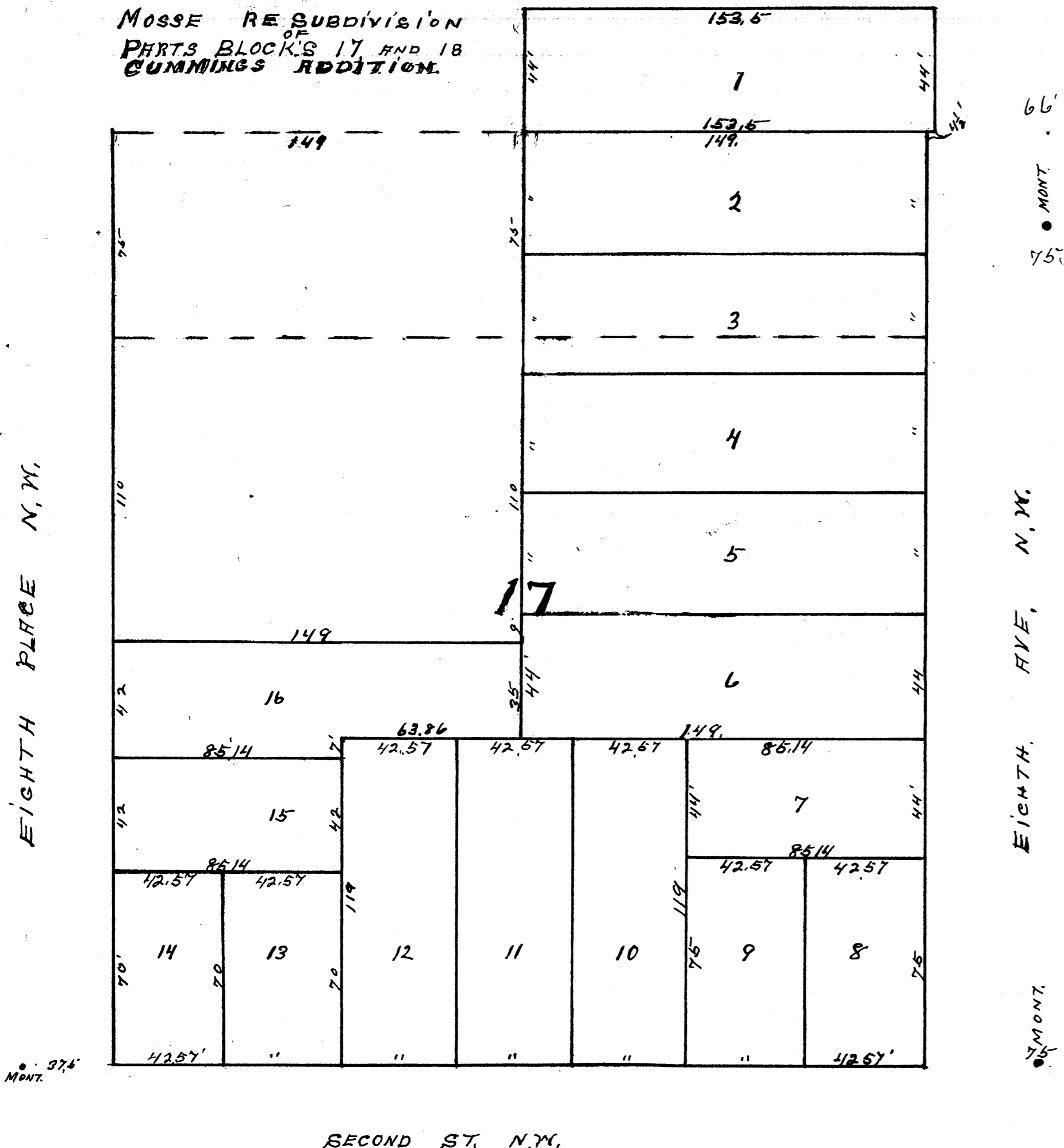

• 274  
MONT.

• 274  
MONT.