

# EMERALD HILLS SUBDIVISION

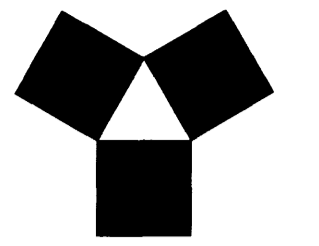

**YAGGY COLBY ASSOCIATES**

ENGINEERS • ARCHITECTS  
SURVEYORS • PLANNERS  
LANDSCAPE ARCHITECTS

717 THIRD AVENUE SOUTHEAST  
ROCHESTER, MINNESOTA 55904  
507-288-5444  
507-288-5058

INSTRUMENT OF DEDICATION

KNOW ALL MEN BY THESE PRESENTS: That Fred Schmidt and Darlene Schmidt, husband and wife, and Norwest Bank Minnesota South, N.A., mortgagees, being owners and proprietors of the following described property situated in the County of Olmsted, State of Minnesota, to wit:

That part of the Southwest Quarter of the Northeast Quarter and of the Southeast Quarter of Section 19, Township 107 North, Range 13 West, Olmsted County, Minnesota, described as follows:

Beginning at the northeast corner of said Southeast Quarter; thence southerly on a Minnesota State Plane Grid Azimuth from north of 179 degrees 13 minutes 03 seconds along the east line of said Southeast Quarter 1699.74 feet to the north line of Century High School, according to the plat thereof on file at the County Recorder's office, Olmsted County, Minnesota; thence westerly 269 degrees 29 minutes 47 seconds azimuth along said north line 600.21 feet; thence northerly 359 degrees 29 minutes 47 seconds azimuth 193.00 feet; thence easterly 89 degrees 29 minutes 47 seconds azimuth 33.44 feet; thence northerly 359 degrees 29 minutes 47 seconds azimuth 256.54 feet; thence northwesterly 324 degrees 41 minutes 22 seconds azimuth 184.86 feet; thence northwesterly 328 degrees 24 minutes 18 seconds azimuth 91.53 feet; thence northwesterly 332 degrees 21 minutes 47 seconds azimuth 219.69 feet; thence westerly 277 degrees 00 minutes 06 seconds azimuth 39.00 feet; thence northerly 13 degrees 47 minutes 58 seconds azimuth 87.80 feet; thence westerly 282 degrees 07 minutes 47 seconds azimuth 183.00 feet; thence northerly 15.73 feet on a nontangential curve concave westerly, having a radius of 1167.00 feet, a central angle of 00 degrees 46 minutes 21 seconds and a chord azimuth of 11 degrees 44 minutes 37 seconds; thence westerly 281 degrees 21 minutes 26 seconds azimuth 278.12 feet; thence northerly 04 degrees 00 minutes 06 seconds azimuth 240.60 feet; thence westerly 269 degrees 13 minutes 33 seconds azimuth 158.04 feet; thence northerly 04 degrees 00 minutes 06 seconds azimuth 132.58 feet; thence westerly 269 degrees 13 minutes 33 seconds azimuth 136.58 feet; thence northerly 350 degrees 54 minutes 10 seconds azimuth 476.01 feet; thence northeasterly 34 degrees 50 minutes 47 seconds azimuth 212.65 feet; thence easterly 89 degrees 13 minutes 33 seconds azimuth 148.85 feet to the east line of said Southwest Quarter; thence southerly 178 degrees 58 minutes 29 seconds azimuth along said east line 400.00 feet to the north line of said Southeast Quarter; thence easterly 89 degrees 13 minutes 33 seconds azimuth along said north line 1336.79 feet to the point of beginning.

Said tract contains 39.53 acres more or less.

Have caused the same to be surveyed and platted as EMERALD HILLS SUBDIVISION and do hereby donate and dedicate to the public for public use forever the thoroughfares and easements, as shown on this plat.

In witness whereof, said Fred Schmidt and Darlene Schmidt husband and wife, have caused these presents to be signed this 09 day of OCTOBER, 1999.

Fred Schmidt  
Fred Schmidt

Darlene Schmidt  
Darlene Schmidt

STATE OF MINNESOTA  
COUNTY OF OLMSTED

The foregoing instrument was acknowledged before me this 15<sup>th</sup> day of October, 1999, by Fred Schmidt and Darlene Schmidt husband and wife.

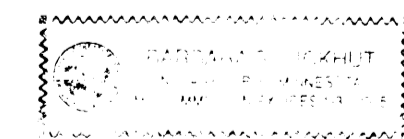

Barbara S. Diebheit  
Notary Public, Olmsted County, MN  
My Commission Expires 1-31-2005

In witness whereof, said Norwest Bank Minnesota South, N.A. has caused these presents to be signed by its proper officer this 1<sup>st</sup> day of OCTOBER, 1999.

Robert B. Claves  
Vice President

STATE OF MINNESOTA  
COUNTY OF OLMSTED

The foregoing instrument was acknowledged before me this 1<sup>st</sup> day of October, 1999, by Robert B. Claves, Norwest Bank Minnesota South, N.A.

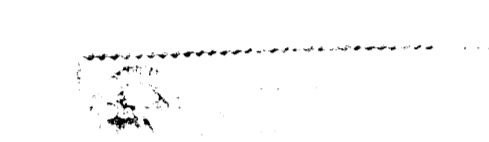

Shelley K. Smith  
Notary Public, Olmsted County, MN  
My Commission Expires 1-31-2000

SURVEYOR'S CERTIFICATE

I do hereby certify that I have surveyed and platted the property described on this plat as EMERALD HILLS SUBDIVISION; that this plat is a correct representation of said survey; that all distances are correctly shown on said plat in feet and hundredths of a foot; that all monuments have been correctly placed in the ground as shown or will be correctly placed in the ground by May 1, 2000; that the outside boundary lines are correctly designated; and that there are no wetlands as defined in MS 505.02, Subd. 1, or public highways to be designated on said plat other than as shown.

Douglas G. Rude  
Douglas G. Rude  
Minnesota L.S. No. 22422

STATE OF MINNESOTA  
COUNTY OF OLMSTED

The foregoing Surveyor's Certificate was acknowledged before me this 15<sup>th</sup> day of October, 1999, by Douglas G. Rude, L.S. No. 22422.

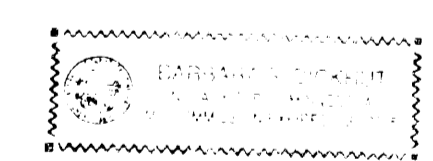

Barbara S. Diebheit  
Notary Public, Olmsted County, MN  
My Commission Expires 1-31-2005

CITY APPROVAL  
STATE OF MINNESOTA  
COUNTY OF OLMSTED  
CITY OF ROCHESTER

I, JUDY KAY SCHERR, City Clerk, in and for the City of Rochester, do hereby certify that on the 30<sup>th</sup> day of MAY, 1999, the accompanying plat was duly approved by the Common Council of the City of Rochester. In testimony whereof, I have hereunto signed my name and affixed the seal of said City of Rochester this 19<sup>th</sup> day of NOVEMBER, 1999.

Judy Kay Scherr  
City Clerk

COUNTY AUDITOR/TREASURER

Taxes payable in the year 1999 on the land herein described have been paid, there are no delinquent taxes and transfer has been entered this 19<sup>th</sup> day of NOVEMBER, 1999.

[Signature]  
Olmsted County Auditor/Treasurer  
By [Signature] Deputy

COUNTY SURVEYOR

I certify that this plat has been checked mathematically and that the plat conforms to applicable platting laws.

This 5 day of October, 1999.

[Signature]  
Olmsted County Surveyor

COUNTY RECORDER

A-829329

Document Number

I hereby certify that this instrument was filed in the Office of the County Recorder for record on this 19<sup>th</sup> day of November, 1999, at 11 o'clock A.m. and was duly recorded in Olmsted County Records.

[Signature]  
Olmsted County Recorder

DRAFTSPERSON:R.A.S.  
DATE: 04/14/99  
COMPUTER FILE: 6393SFO1.DWG  
PROJECT NUMBER: 6393-99

# EMERALD HILLS SUBDIVISION

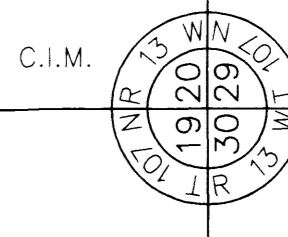
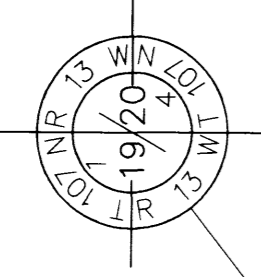

UNPLATTED

UNPLATTED

UNPLATTED

UNPLATTED

P.O.B. COR  
1/4  
SEC. 19  
C.I.M.

C.I.M.

ENGINEERS - ARCHITECTS  
SURVEYORS - PLANNERS  
LANDSCAPE ARCHITECTS  
717 THIRD AVENUE, SOUTHEAST  
ROCHESTER, MINNESOTA 55904  
507-288-6464  
FAX 507-288-5058

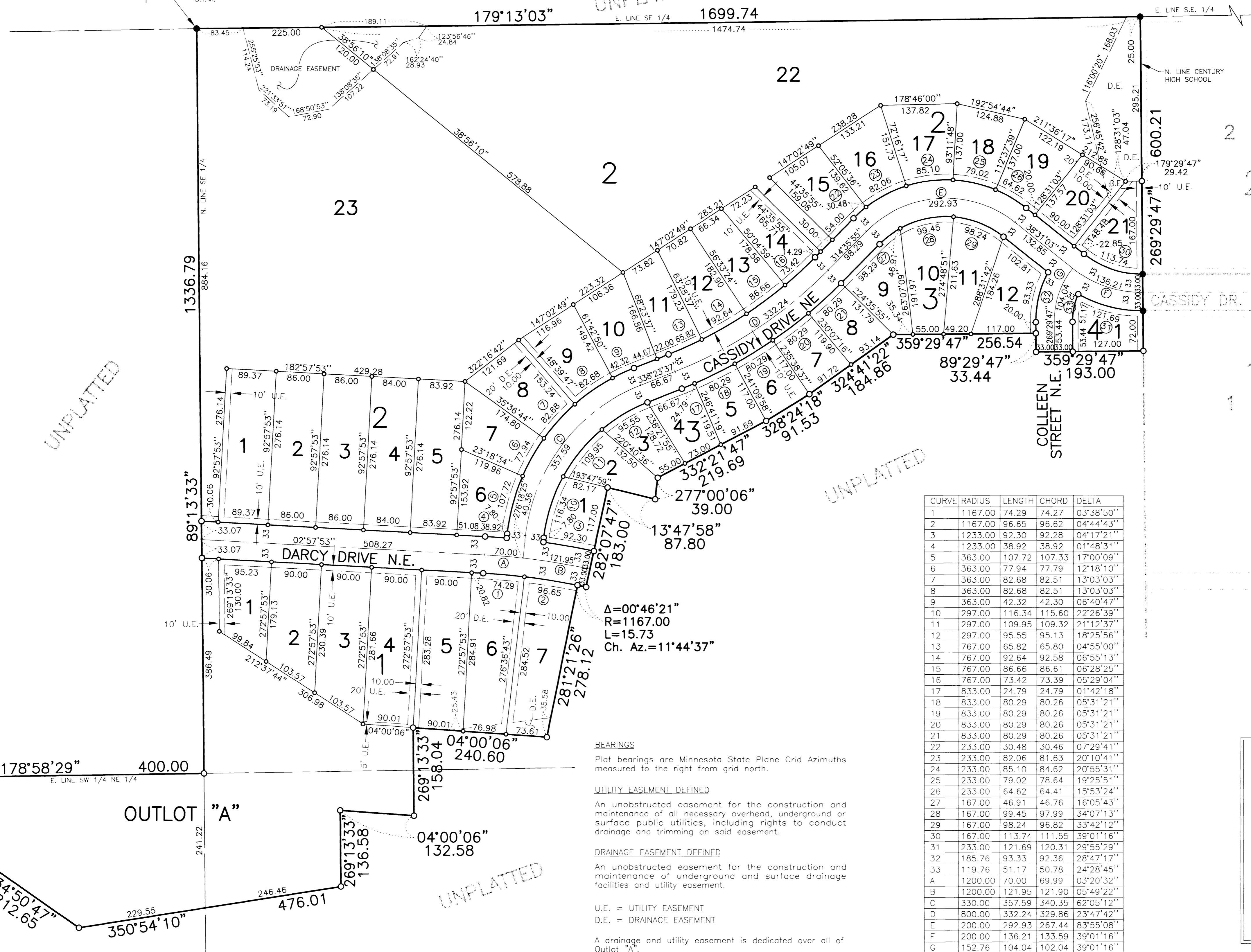

$\Delta = 00^{\circ}46'21''$   
 $R = 1167.00$   
 $L = 15.73$   
 $Ch. Az. = 11^{\circ}44'37''$

**BEARINGS**  
Plat bearings are Minnesota State Plane Grid Azimuths measured to the right from grid north.

**UTILITY EASEMENT DEFINED**  
An unobstructed easement for the construction and maintenance of all necessary overhead, underground or surface public utilities, including rights to conduct drainage and trimming on said easement.

**DRAINAGE EASEMENT DEFINED**  
An unobstructed easement for the construction and maintenance of underground and surface drainage facilities and utility easement.

U.E. = UTILITY EASEMENT  
D.E. = DRAINAGE EASEMENT

A drainage and utility easement is dedicated over all of Outlot "A".

CURVE	RADIUS	LENGTH	CHORD	DELTA
1	1167.00	74.29	74.27	03°38'50"
2	1167.00	96.65	96.62	04°44'43"
3	1233.00	92.30	92.28	04°17'21"
4	1233.00	38.92	38.92	01°48'31"
5	363.00	107.72	107.33	17°00'09"
6	363.00	77.94	77.79	12°18'10"
7	363.00	82.68	82.51	13°03'03"
8	363.00	82.68	82.51	13°03'03"
9	363.00	42.32	42.30	06°40'47"
10	297.00	116.34	115.60	22°26'39"
11	297.00	109.95	109.32	21°12'37"
12	297.00	95.55	95.13	18°25'56"
13	767.00	65.82	65.80	04°55'00"
14	767.00	92.64	92.58	06°55'13"
15	767.00	86.66	86.61	06°28'25"
16	767.00	73.42	73.39	05°29'04"
17	833.00	24.79	24.79	01°42'18"
18	833.00	80.29	80.26	05°31'21"
19	833.00	80.29	80.26	05°31'21"
20	833.00	80.29	80.26	05°31'21"
21	833.00	80.29	80.26	05°31'21"
22	233.00	30.48	30.46	07°29'41"
23	233.00	82.06	81.63	20°10'41"
24	233.00	85.10	84.62	20°55'31"
25	233.00	79.02	78.64	19°25'51"
26	233.00	64.62	64.41	15°53'24"
27	167.00	46.91	46.76	16°05'43"
28	167.00	99.45	97.99	34°07'13"
29	167.00	98.24	96.82	33°42'12"
30	167.00	113.74	111.55	39°01'16"
31	233.00	121.69	120.31	29°55'29"
32	185.76	93.33	92.36	28°47'17"
33	119.76	51.17	50.78	24°28'45"
A	1200.00	70.00	69.99	03°20'32"
B	1200.00	121.95	121.90	05°49'22"
C	330.00	357.59	340.35	62°05'12"
D	800.00	332.24	329.86	23°47'42"
E	200.00	292.93	267.44	83°55'08"
F	200.00	136.21	133.59	39°01'16"
G	152.76	104.04	102.04	39°01'16"

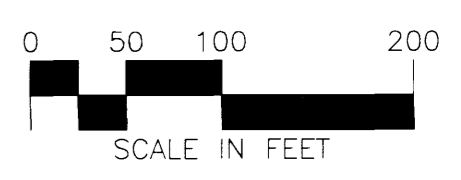
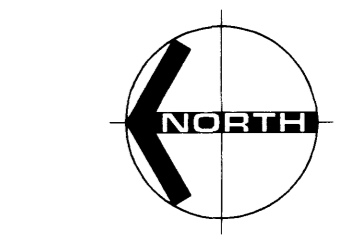

**MONUMENTS**

- Set 1/2" Rebars
- Set 3/4" Iron Pipes
- Found Monuments (Pipe, Rod, Etc.)

All monuments set have a plastic cap stamped L.S. 22422.

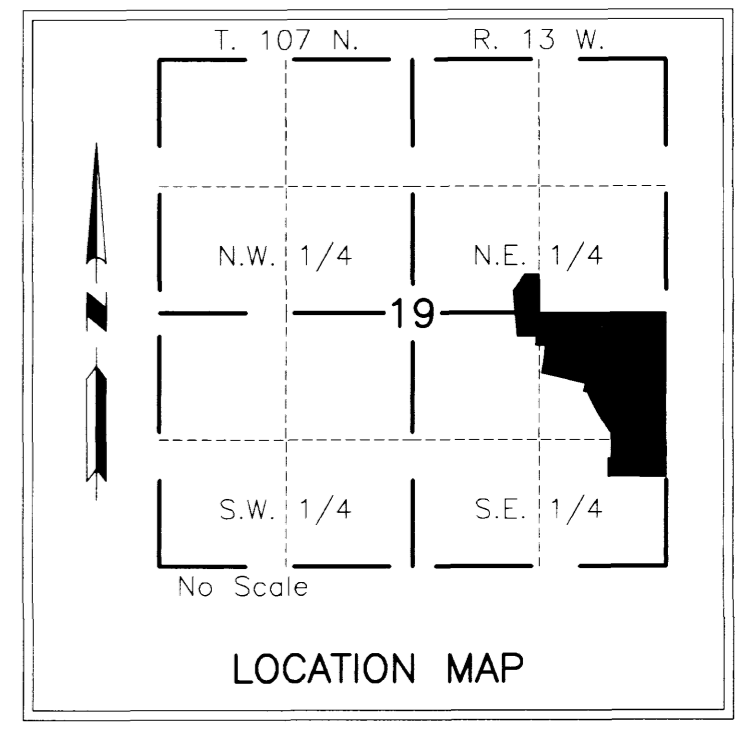

PROJECT NUMBER: 6393-99  
COMPUTER FILE: 6393SF01.DWG  
DATE: 04/14/99  
DRAFTSPERSON: R.A.S.