

COMMON INTEREST COMMUNITY NUMBER 123 VILLAGE ON THE GREEN II CONDOMINIUM FOURTH SUPPLEMENTAL

This FOURTH SUPPLEMENTAL CIC Plat has been recorded as part of the Fifth Amended Declaration Document No. _____ A.D., 19__ at _____ in the Office of the Olmsted County Recorder.

797511

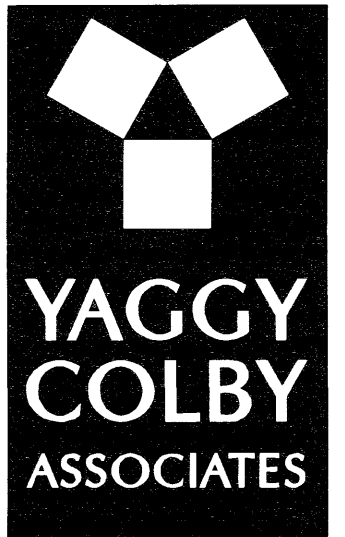

ENGINEERS • ARCHITECTS
SURVEYORS • PLANNERS
LANDSCAPE ARCHITECTS
717 THIRD AVENUE SOUTHEAST
ROCHESTER, MINNESOTA 55904
507-288-6664
FAX 507-288-5058
EMAIL INFO@YAGGY.COM

COUNTY RECORDER OFFICE
Olmsted County, Minn.
I hereby certify that the within instrument was filed on
NOV 25 1998
at 5 o'clock P.M.
by Tom Nemestala Deputy

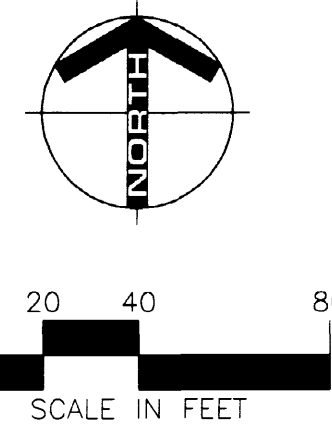

VERTICAL CONTROL

The elevations on this plan are based on the National Geodetic Vertical Datum of 1929.

BASIS OF BEARINGS

All bearings are in relationship with the northeasterly line of Lot 5, Block 2, of the plat of Village on the Green which is assumed to be North 33 degrees 10 minutes 35 seconds West.

BENCH MARKS

S.C.S. disc in NE guardrail post S side of 48th St. 170 feet up hill from entrance to Village on the Green
South bolt hydrant on property line between Lots 4 and 5, Block 2.

Elev. 1103.18

Elev. 1088.59

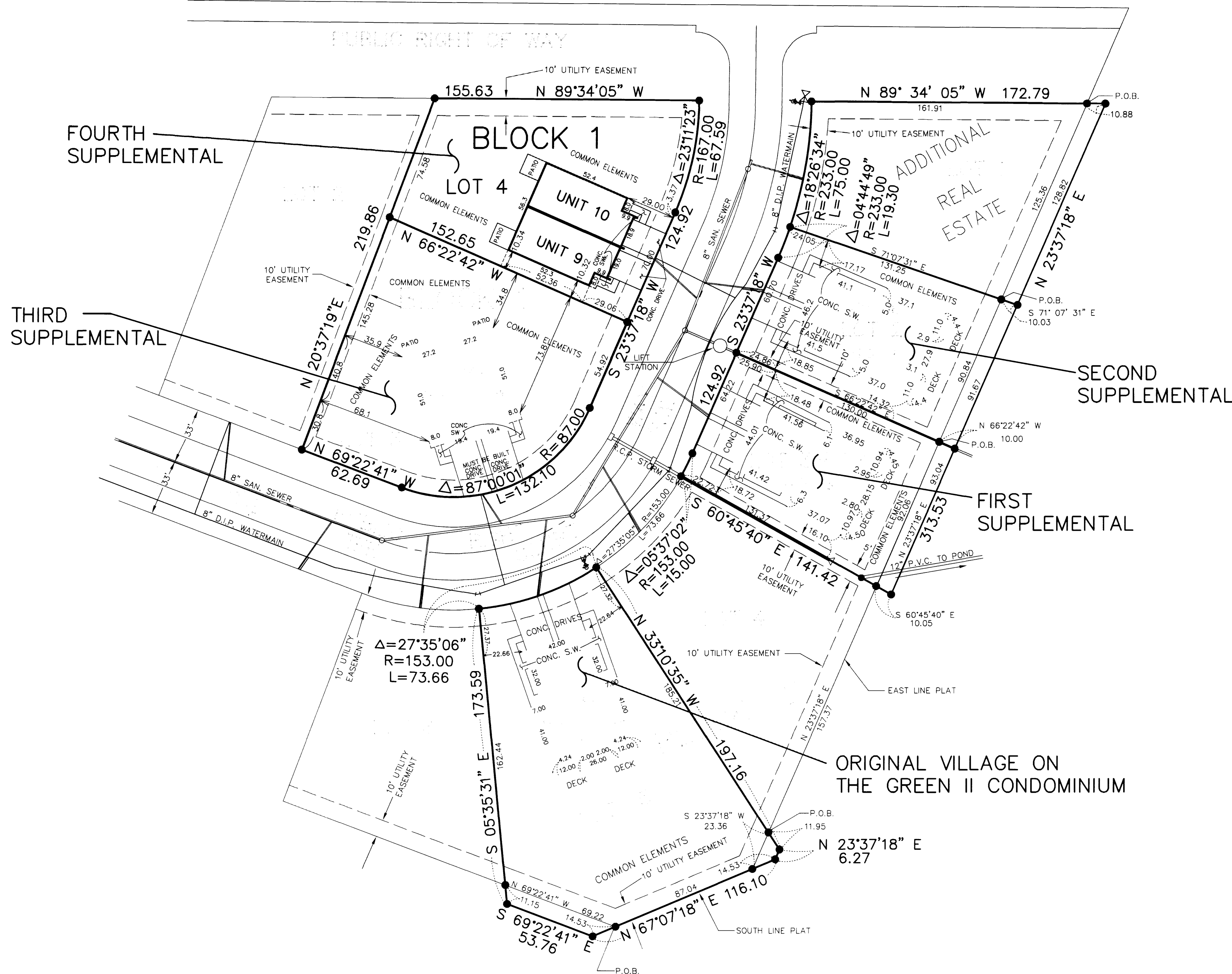

COMMON INTEREST COMMUNITY NUMBER 123 VILLAGE ON THE GREEN II CONDOMINIUM FOURTH SUPPLEMENTAL

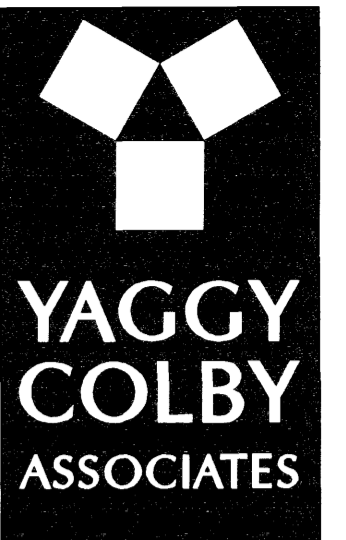

ENGINEERS • ARCHITECTS
SURVEYORS • PLANNERS
LANDSCAPE ARCHITECTS
717 THIRD AVENUE SOUTHEAST
ROCHESTER, MINNESOTA 55904
507-288-6464
FAX 507-288-5058
EMAIL INFO@YAGGY.COM

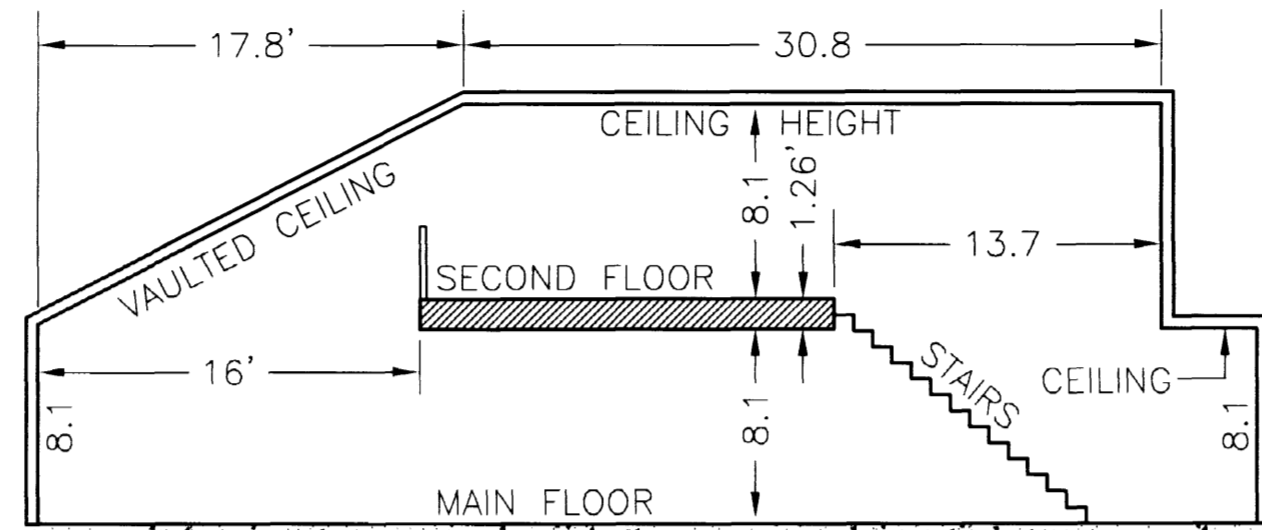

SECTION A-A

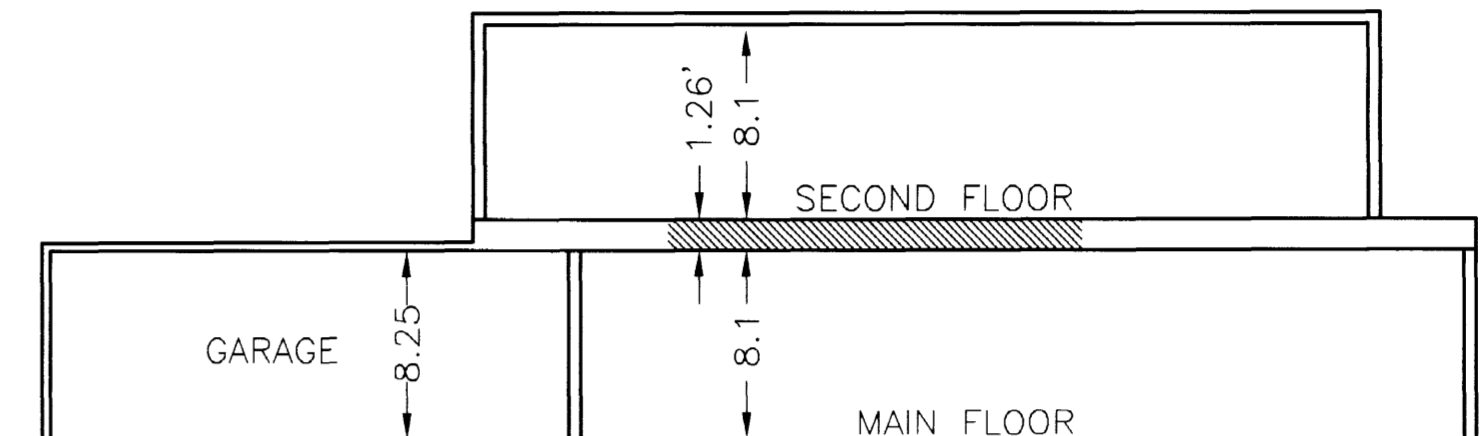

SECTION B-B

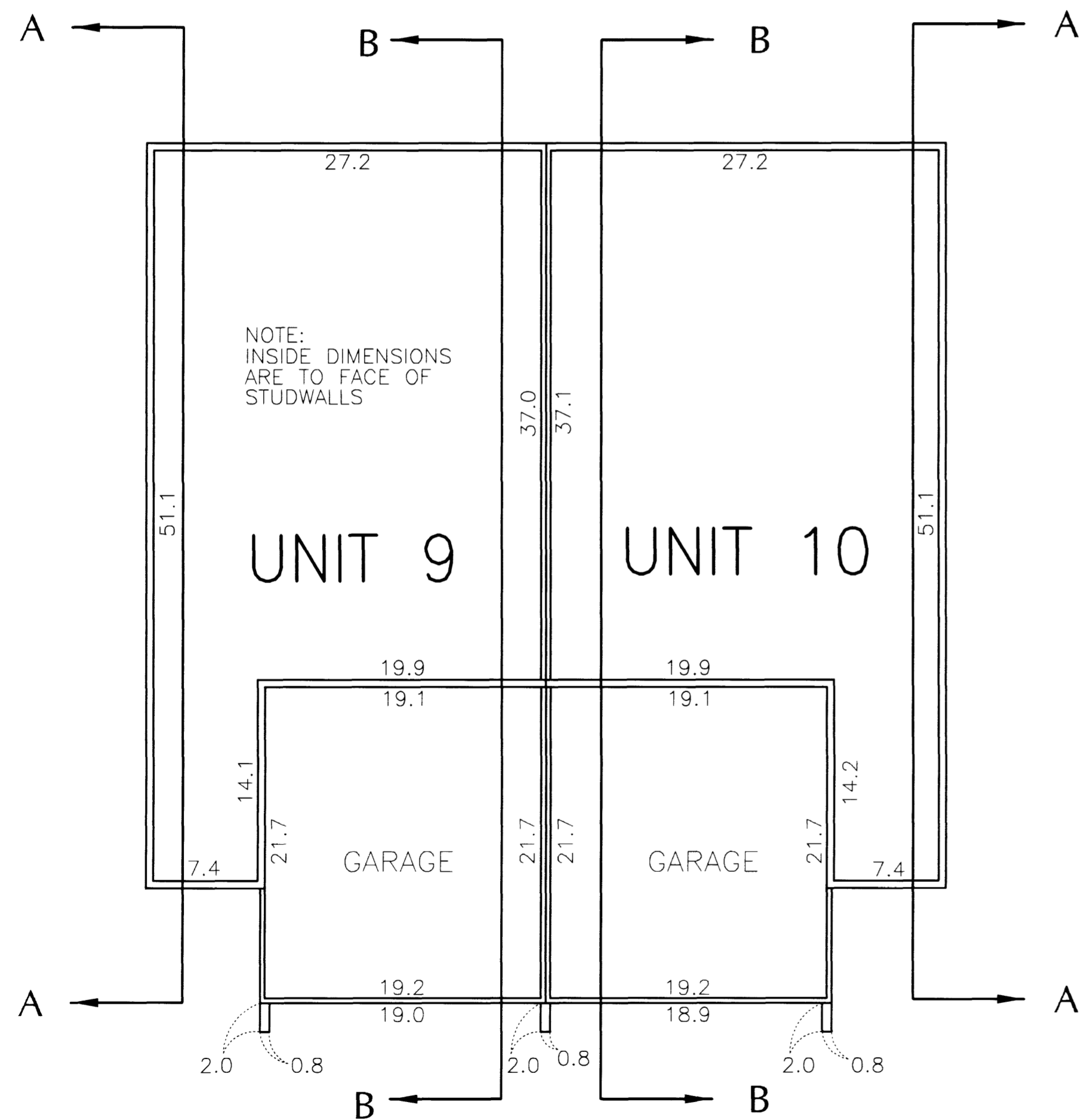

NOTE:
INSIDE DIMENSIONS
ARE TO FACE OF
STUDWALLS

UNIT 9

UNIT 10

GARAGE

GARAGE

MAIN FLOOR

FINISHED FLOOR ELEVATION 1090.22
FINISHED CEILING HEIGHT 8.1
GARAGE FLOOR ELEVATION 1090.22

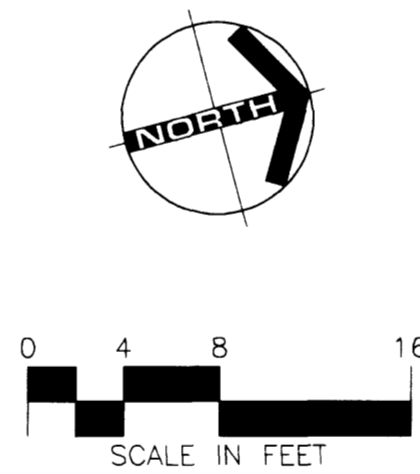

VERTICAL CONTROL

The elevations on this plan are based on the National Geodetic vertical datum of 1929.

Elevations shown are referenced to a bench mark as denoted on SHEET 1 OF 3 SHEETS, FOURTH SUPPLEMENTAL.

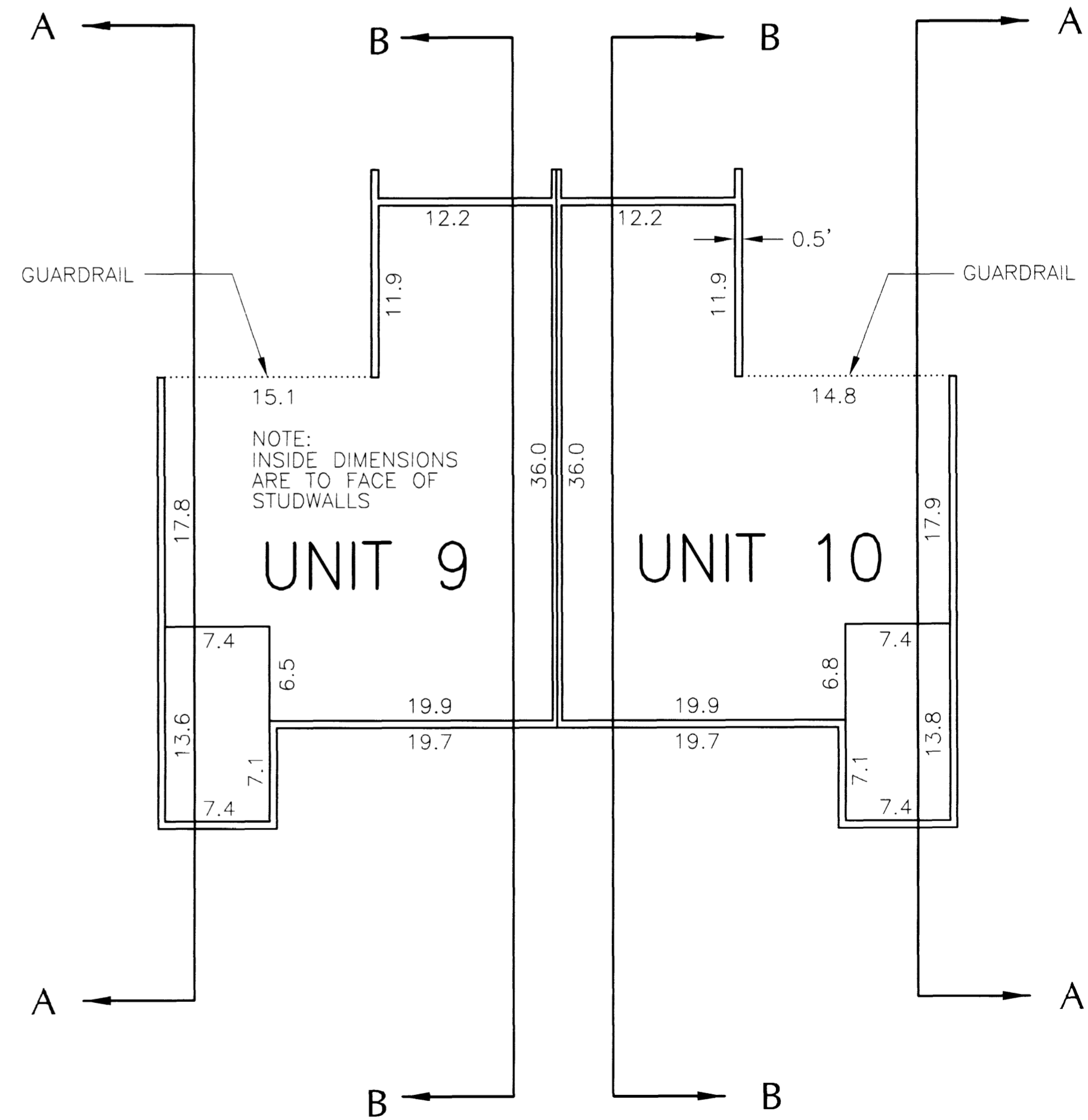

UNIT 9

UNIT 10

SECOND FLOOR

FINISHED FLOOR ELEVATION 1099.58
FINISHED CEILING HEIGHT 8.1

PROJECT NUMBER: 6307
COMPUTER FILE: 6307SF02.DWG
DATE: 10/13/98
DRAFTSPERSON: SCB

COMMON INTEREST COMMUNITY NUMBER 123 VILLAGE ON THE GREEN II CONDOMINIUM FOURTH SUPPLEMENTAL

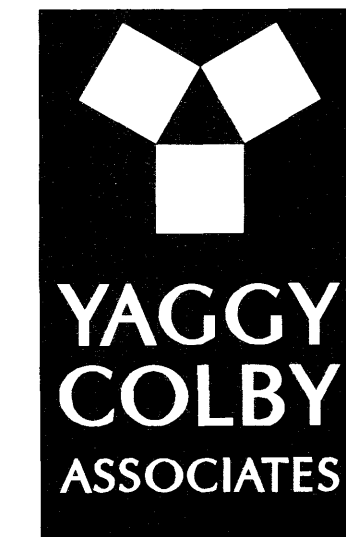

ENGINEERS • ARCHITECTS
SURVEYORS • PLANNERS
LANDSCAPE ARCHITECTS
717 THIRD AVENUE SOUTHEAST
ROCHESTER, MINNESOTA 55904
507-288-6464
FAX 507-288-5038
EMAIL INFO@YAGGY.COM

SURVEYOR'S CERTIFICATE

I, Douglas G. Rude, hereby certify that this condominium plat of COMMON INTEREST COMMUNITY NUMBER 123, VILLAGE ON THE GREEN II CONDOMINIUM FOURTH SUPPLEMENTAL located upon:

Lots 3 & 4, Block 1, and Lots 2, 3, and 5, Block 2, Village on the Green, according to the plat thereof on file in the County Recorder's Office, Olmsted County, Minnesota.

AND

That part of the South Half of the Southeast Quarter, Section 27, Township 106 North, Range 14 West of the 5th Meridian, Olmsted County, Minnesota, described as follows:

Beginning at the most easterly corner of Lot 5, Block 2, Village on the Green, according to the recorded plat thereof on file and of record in the office of the County Recorder, Olmsted County Minnesota; thence South 23 degrees 37 minutes 18 seconds West along the easterly line of said plat a distance of 23.36 feet; thence North 67 degrees 07 minutes 18 seconds East a distance of 14.53 feet; thence North 23 degrees 37 minutes 18 seconds East a distance of 6.27 feet; thence North 33 degrees 10 minutes 35 seconds West a distance of 11.95 feet to the point of beginning.

AND

That part of the South Half of the Southeast Quarter, Section 27, Township 106 North, Range 14 West of the 5th Principal Meridian, Olmsted County, Minnesota, described as follows:

Commencing at the most easterly corner of Lot 5, Block 2, Village on the Green, according to the plat thereof on file and of record in the office of the County Recorder, Olmsted County, Minnesota; thence South 23 degrees 37 minutes 18 seconds West along the easterly line of said plat a distance of 23.36 feet; thence South 67 degrees 07 minutes 18 seconds West along the Southerly line of said plat a distance of 87.04 feet to the point of beginning of the land to be described; thence North 69 degrees 22 minutes 41 seconds West a distance of 69.22 feet; thence South 5 degrees 35 minutes 31 seconds East a distance of 11.15 feet; thence South 69 degrees 22 minutes 41 seconds East a distance of 53.76 feet; thence North 67 degrees 07 minutes 18 seconds East a distance of 14.53 feet to the point of beginning.

AND

That part of the South Half of the Southeast Quarter, Section 27, Township 106 North, Range 14 West of the 5th Principal Meridian, Olmsted County, Minnesota, described as follows:

Beginning at the Northeast Corner of Lot 3, Block 2 of Village on the Green, according to the recorded plat thereof on file and of record in the Office of the County Recorder, Olmsted County Minnesota; thence South 23 degrees 37 minutes 18 seconds West along the Easterly line of said Plat a distance of 92.06 feet; thence South 60 degrees 45 minutes 40 seconds East a distance of 10.05 feet; thence North 23 degrees 37 minutes 18 seconds East a distance of 93.04 feet; thence North 66 degrees 22 minutes 42 seconds West a distance of 10.00 feet to the point of beginning.

AND

That part of the South Half of the Southeast Quarter, Section 27, Township 106 North, Range 14 West of the 5th Principal Meridian, Olmsted County, Minnesota, described as follows:

Beginning at the Northeast Corner of Lot 2, Block 2 of Village on the Green, according to the recorded plat thereof on file and of record in the Office of the County Recorder, Olmsted County, Minnesota; thence South 23 degrees 37 minutes 18 seconds West along the Easterly line of said Plat a distance of 90.84 feet; thence South 66 degrees 22 minutes 42 seconds East a distance of 10.00 feet; Thence North 23 degrees 37 minutes 18 seconds East a distance of 91.67 feet; thence North 71 degrees 07 minutes 31 seconds West a distance of 10.03 feet to the point of beginning.

AND The Additional Real Estate described as follows:

Lot 1, Block 2, Village on the Green, according to the plat thereof on file at the County Recorder's Office, Olmsted County, Minnesota.

AND

That part of the South Half of the Southeast Quarter, Section 27, Township 106 North, Range 14 West of the 5th Principal Meridian, Olmsted County, Minnesota, described as follows:

Beginning at the Northeast Corner of Lot 1, Block 2, Village on the Green, according to the recorded plat thereof on file and of record in the office of the County Recorder, Olmsted County, Minnesota; thence South 23 degrees 37 minutes 18 seconds West along the Easterly line of said Plat a distance of 125.36 feet; thence South 71 degrees 07 minutes 31 seconds East a distance of 10.03 feet; thence North 23 degrees 37 minutes 18 seconds East a distance of 128.82 feet; thence North 89 degrees 34 minutes 05 seconds West a distance of 10.88 feet to the point of beginning.

and was prepared by me or under my direct supervision and that it fully and accurately depicts all information required by Minnesota Statutes, Section 515B.2-110.

Dated this 17th day of November, 1998.

Douglas G. Rude
Douglas G. Rude, Land Surveyor
Minnesota L.S. No. 22422

STATE OF MINNESOTA
COUNTY OF OLMTED

The foregoing instrument was acknowledged before me this 17th day of November, 1998 by Douglas G. Rude, a licensed land surveyor.



Barbara S. Diehl
Notary Public, Olmsted County, Minnesota
My Commission Expires 1-31-2000

ARCHITECT'S CERTIFICATE

I, Christopher W. Colby, pursuant to Minnesota Statutes, Section 515B.2-110 (c) do hereby certify that all structural components and mechanical systems serving more than one unit of all buildings, containing or comprising any units hereby created, are substantially completed consistent with the floor plans for this condominium plat, COMMON INTEREST COMMUNITY NUMBER 123, VILLAGE ON THE GREEN II CONDOMINIUM FOURTH SUBDIVISION.

Dated this 17th day of NOVEMBER, 1998.

Christopher W. Colby
Christopher W. Colby, Registered Architect
Minnesota Registration No.11883

STATE OF MINNESOTA
COUNTY OF OLMTED

The foregoing instrument was acknowledged before me this 17th day of November, 1998 by Christopher W. Colby, a registered architect.

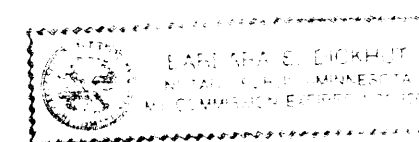

Barbara S. Diehl
Notary Public, Olmsted County, Minnesota
My Commission Expires 1-31-2000

COUNTY SURVEYOR

Pursuant to Minnesota Statutes, Chapter 389.09, Subdivision 2, this condominium plat has been reviewed and approved this 18 day of November, 1998.

Edward P. Kunitz
Olmsted County Surveyor

DRAFTSPERSON:SCB

DATE: 10/13/98

COMPUTER FILE: 6307SFO3.DWG

PROJECT NUMBER: 6307