

COUNTY PUBLIC WORKS SUBDIVISION

KNOW ALL MEN BY THESE PRESENTS: That the County of Olmsted, a political subdivision of the State of Minnesota, owner of the following described properties:

That part of the Southeast Quarter of Section 25, Township 106 North, Range 14 West, Olmsted County, Minnesota described as follows:

Commencing at the southeast corner of said Southeast Quarter; thence on an assumed bearing of South 89 degrees 26 minutes 00 seconds West, along the south line of said Southeast Quarter, 200.00 feet to the point of beginning; thence North 00 degrees 35 minutes 48 seconds West, parallel with the east line of said Southeast Quarter, 200.00 feet; thence North 89 degrees 26 minutes 00 seconds East, 200.00 feet to the east line of said Southeast Quarter; thence North 00 degrees 35 minutes 48 seconds West, along said east line, 460.00 feet; thence South 89 degrees 26 minutes 00 seconds West, 1650.00 feet; thence South 00 degrees 34 minutes 00 seconds East, 660.00 feet to the south line of said Southeast Quarter, thence North 89 degrees 26 minutes 00 seconds East, along said south line, 1450.35 feet to the point of beginning.

ALSO:

That part of the North Half of Section 36, Township 106 North, Range 14 West, Olmsted County, Minnesota described as follows:

Commencing at the northeast corner of said Section 36; thence on an assumed bearing of South 89 degrees 26 minutes 00 seconds West, along the north line of the Northeast Quarter of said Section 36, 810.00 feet to the point of beginning; thence South 01 degrees 49 minutes 09 seconds West, 480.42 feet; thence South 89 degrees 26 minutes 00 seconds West, 1090.00 feet; thence South 00 degrees 34 minutes 00 seconds East, 470.00 feet; thence South 89 degrees 26 minutes 00 seconds West, 500.00 feet; thence South 20 degrees 02 minutes 30 seconds West, 113.62 feet; thence South 89 degrees 26 minutes 00 seconds West, 1482.48 feet to the west line of the East Half of the Northwest Quarter of said Section 36; thence North 00 degrees 01 minutes 08 seconds West, along said west line, 1070.45 feet to the north line of the Northwest Quarter of said Section 36; thence South 89 degrees 57 minutes 10 seconds East, along said north line, 1310.72 feet to the northeast corner of said Northwest Quarter; thence North 89 degrees 26 minutes 00 seconds East, along the north line of the Northeast Quarter of said Section 36, 1811.59 feet to the point of beginning.

ALSO:

That part of the Northeast Quarter of the Northwest Quarter and the Northwest Quarter of the Northeast Quarter of Section 36, Township 106 North, Range 14 West, Olmsted County, Minnesota described as follows:

Commencing at the northeast corner of the Northeast Quarter of said Section 36; thence on an assumed bearing of South 89 degrees 26 minutes 00 seconds West along the north line of said Northeast Quarter, 810.00 feet; thence South 01 degrees 49 minutes 09 seconds West, 480.42 feet; thence South 89 degrees 26 minutes 00 seconds West, 1090.00 feet; thence South 00 degrees 34 minutes 00 seconds East, 470.00 feet; thence South 89 degrees 26 minutes 00 seconds West, 500.00 feet; thence South 20 degrees 02 minutes 30 seconds West, 113.62 feet to the point of the beginning; thence South 89 degrees 26 minutes 00 seconds West, 664.08 feet; thence South 83 degrees 54 minutes 38 seconds East, 640.48 feet; thence North 20 degrees 02 minutes 30 seconds East, 79.32 feet to the point of beginning.

ALSO:

That part of the Northeast Quarter of Section 36, Township 106 North, Range 14 West, Olmsted County, Minnesota described as follows:

Commencing at the northeast corner of said Northeast Quarter; thence on an assumed bearing of South 89 degrees 26 minutes 00 seconds West, along the north line of said Northeast Quarter, 200.00 feet to the point of beginning; thence South 89 degrees 26 minutes 00 seconds West, 610.00 feet; thence South 01 degrees 49 minutes 09 seconds West, 480.42 feet; thence South 89 degrees 26 minutes 00 seconds West, 1090.00 feet; thence South 00 degrees 34 minutes 00 seconds East, 470.00 feet; thence South 89 degrees 26 minutes 00 seconds West, 500.00 feet; thence South 20 degrees 02 minutes 30 seconds West, 113.62 feet; thence South 89 degrees 26 minutes 00 seconds West, 664.08 feet to the point of beginning; thence North 00 degrees 01 minutes 08 seconds West, 1070.45 feet; thence North 89 degrees 26 minutes 00 seconds East, 637.91 feet; thence North 00 degrees 34 minutes 00 seconds West, 380.59 feet; thence North 89 degrees 26 minutes 00 seconds East, 900.00 feet; thence North 44 degrees 26 minutes 00 seconds East, 1060.66 feet to the north line of said Northeast Quarter and the point of beginning.

EXCEPTING THEREFROM:

That part of the Northeast Quarter of the Northwest Quarter of Section 36, Township 106 North, Range 14 West, Olmsted County, Minnesota described as follows:

Commencing at the northeast corner of the Northeast Quarter of said Section 36; thence on an assumed bearing of South 89 degrees 26 minutes 00 seconds West along the north line of said Northeast Quarter, 810.00 feet; thence South 01 degrees 49 minutes 09 seconds West, 480.42 feet; thence South 89 degrees 26 minutes 00 seconds West, 1090.00 feet; thence South 00 degrees 34 minutes 00 seconds East, 470.00 feet; thence South 89 degrees 26 minutes 00 seconds West, 500.00 feet; thence South 20 degrees 02 minutes 30 seconds West, 113.62 feet; thence South 89 degrees 26 minutes 00 seconds West, 664.08 feet to the point of beginning; thence North 00 degrees 01 minutes 08 seconds West, 1070.45 feet; thence North 89 degrees 26 minutes 00 seconds East, 637.91 feet; thence North 00 degrees 34 minutes 00 seconds West, 380.59 feet; thence North 89 degrees 26 minutes 00 seconds East, 900.00 feet; thence North 44 degrees 26 minutes 00 seconds East, 1060.66 feet to the north line of said Northeast Quarter and the point of beginning.

Containing in all, 97.93 acres, more or less.

Has caused the same to be surveyed and platted as COUNTY PUBLIC WORKS SUBDIVISION and does hereby dedicate to the public for public use the utility easements as created by this plat.

In witness whereof said County of Olmsted, a political subdivision of the State of Minnesota, has caused these presents to be signed by its proper officer this 22 day of April, 2014.

Matt Flynn
Chairman of Olmsted County Board of Commissioners

STATE OF MINNESOTA
COUNTY OF Olmsted

This instrument was acknowledged before me on April 22, 2014 by Matt Flynn, Chairman of Olmsted County Board of Commissioners, County of Olmsted, a political subdivision of the State of Minnesota.

Diane E. Paradise
Notary Public, Olmsted County, Minnesota
My commission expires on 1/31/2019



SURVEYOR'S CERTIFICATE

I, Joel Thoreson, hereby certify that this plat was prepared by me or under my direct supervision; that I am a duly Licensed Land Surveyor in the State of Minnesota; that this plat is a correct representation of the boundary survey; that all mathematical data and labels are correctly designated on this plat; that all monuments depicted on this plat have been, or will be correctly set within one year; that all water boundaries and wet lands, as defined in Minnesota Statutes, Section 505.01, Subd. 3, as of the date of this certificate are shown and labeled on this plat; and all public ways are shown and labeled on this plat.

Dated this 17 day of APRIL, 2014.

Joel A. Thoreson
Joel Thoreson, Licensed Land Surveyor
Minnesota License No. 42638

STATE OF MINNESOTA
COUNTY OF Olmsted

This instrument was acknowledged before me on April 17, 2014 by Joel Thoreson.

Brittney Marschall
Notary Public, Olmsted County, Minnesota
My commission expires on January 31, 2019



PROPERTY RECORDS AND LICENSING

Taxes payable in the year 2014 on the land described herein have been paid, there are no delinquent taxes and transfer has been entered this 29th day of April, 2014.

DOCUMENT NUMBER A-1345071

I hereby certify that this instrument was filed in the Office of Property Records and Licensing for the record on this 29th day of April, 2014, at 1:12 o'clock P.M., and was duly recorded in the Olmsted County records.

W. Mark Krupski
Director of Property Records & Licensing

Wendy von Wood
Deputy

COUNTY SURVEYOR

I hereby certify that in accordance with Minnesota Statutes, Section 505.021, Subd. 11, this plat has been reviewed and approved this 17 day of APRIL, 2014.

Joel A. Thoreson
Olmsted County Surveyor

CITY APPROVAL

State of Minnesota
County of Olmsted
City of Rochester

I, Aaron Reeves, City Clerk, in and for the City of Rochester, do hereby certify that on the 4 day of September, 2014, the accompanying plat was duly approved by the Common Council of the City of Rochester. In testimony thereof I have hereunto signed my name and affixed the seal of said City of Rochester this 28 day of April, 2014.

Aaron Reeves
Aaron Reeves, City Clerk

COUNTY ENGINEER

Recommended for approval this 22 day of April, 2014.

Kay M. Biernick
Olmsted County Engineer

1276A

COUNTY PUBLIC WORKS SUBDIVISION

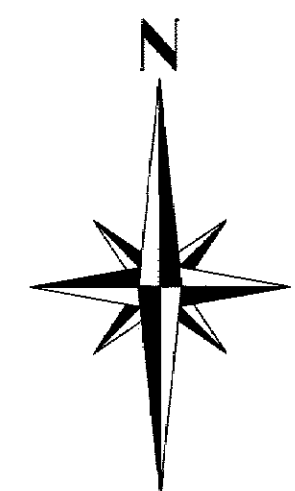
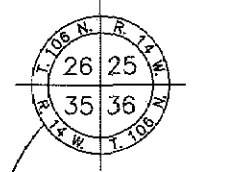
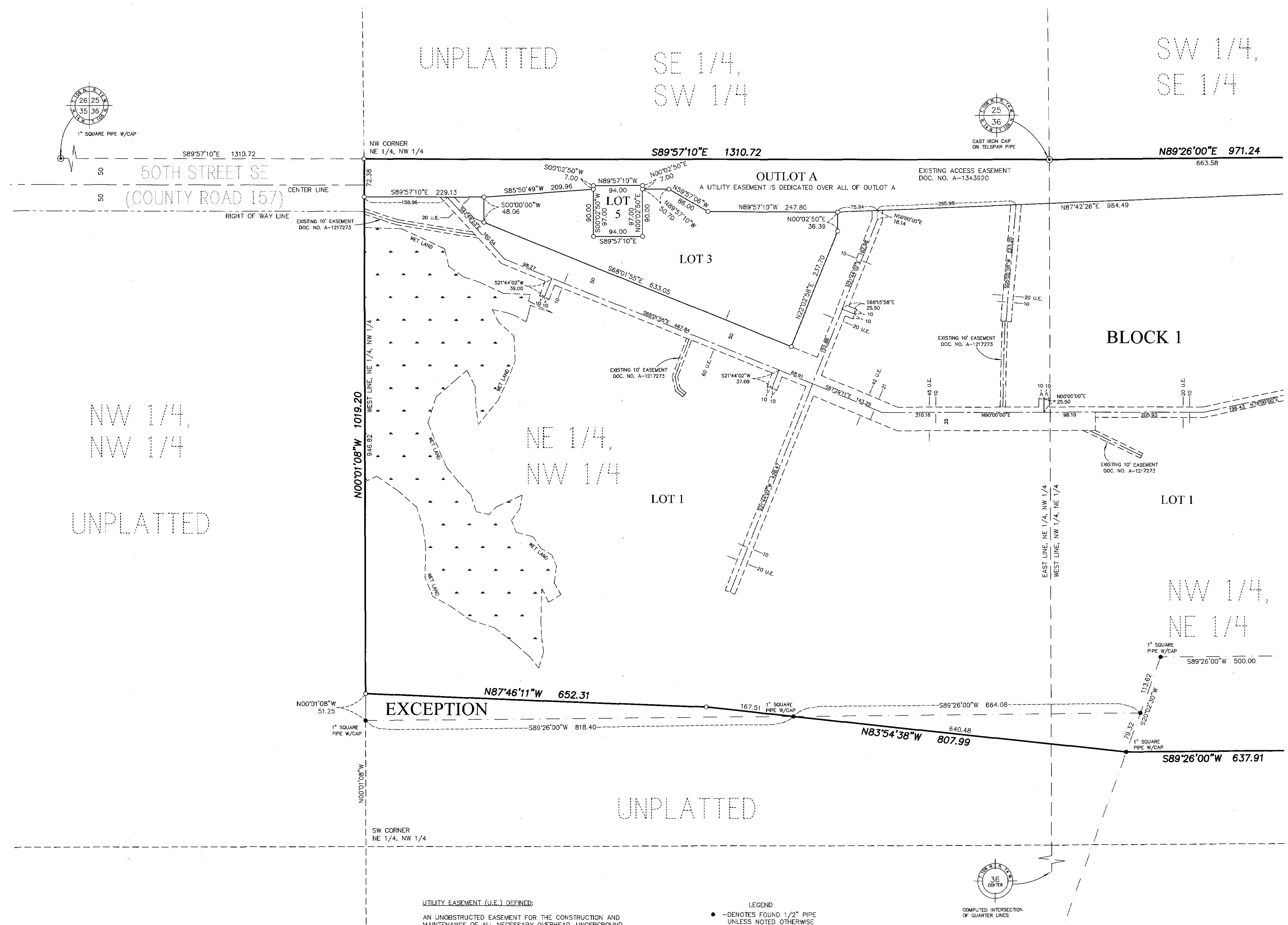

Scale in Feet
 25 0 50 100
 1 Inch = 100 Feet

ORIENTATION OF THIS BEARING SYSTEM IS BASED ON THE OLMSTED COUNTY COORDINATE SYSTEM NAD83 (1995 ADJUSTMENT)

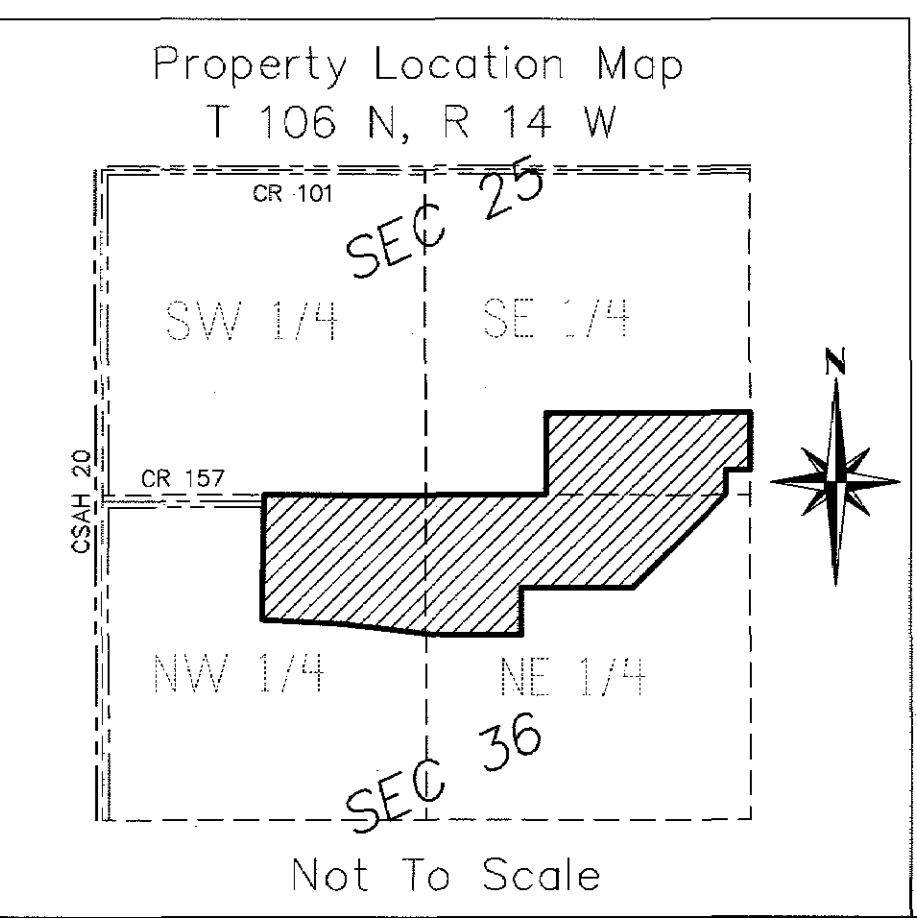

UTILITY EASEMENT (U.E.) DEFINED:
 AN UNOBSTRUCTED EASEMENT FOR THE CONSTRUCTION AND MAINTENANCE OF ALL NECESSARY OVERHEAD, UNDERGROUND OR SURFACE PUBLIC UTILITIES INCLUDING THE RIGHTS TO CONDUCT DRAINAGE AND TRIMMING ON SAID EASEMENT

LEGEND
 ● - DENOTES FOUND 1/2" PIPE UNLESS NOTED OTHERWISE
 ○ - DENOTES SET 1" SQUARE PIPE W/CAP LICENSE NO. 42638

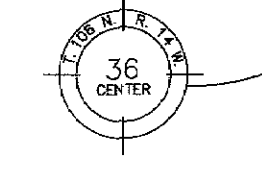

COMPUTED INTERSECTION OF QUARTER LINES

CITY OF SEAS

CITY OF SEAS

COUNTY PUBLIC WORKS SUBDIVISION

UNPLATTED

SW 1/4,
SE 1/4

SE 1/4,
SE 1/4
LOT 4

BLOCK 1

SEE SHEET 2

SEE SHEET 2

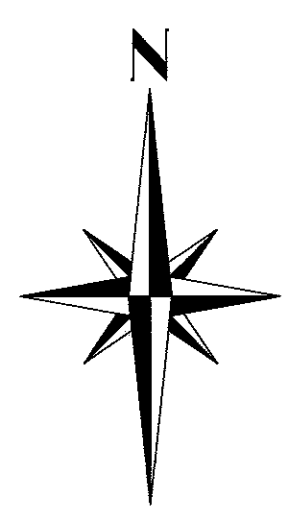
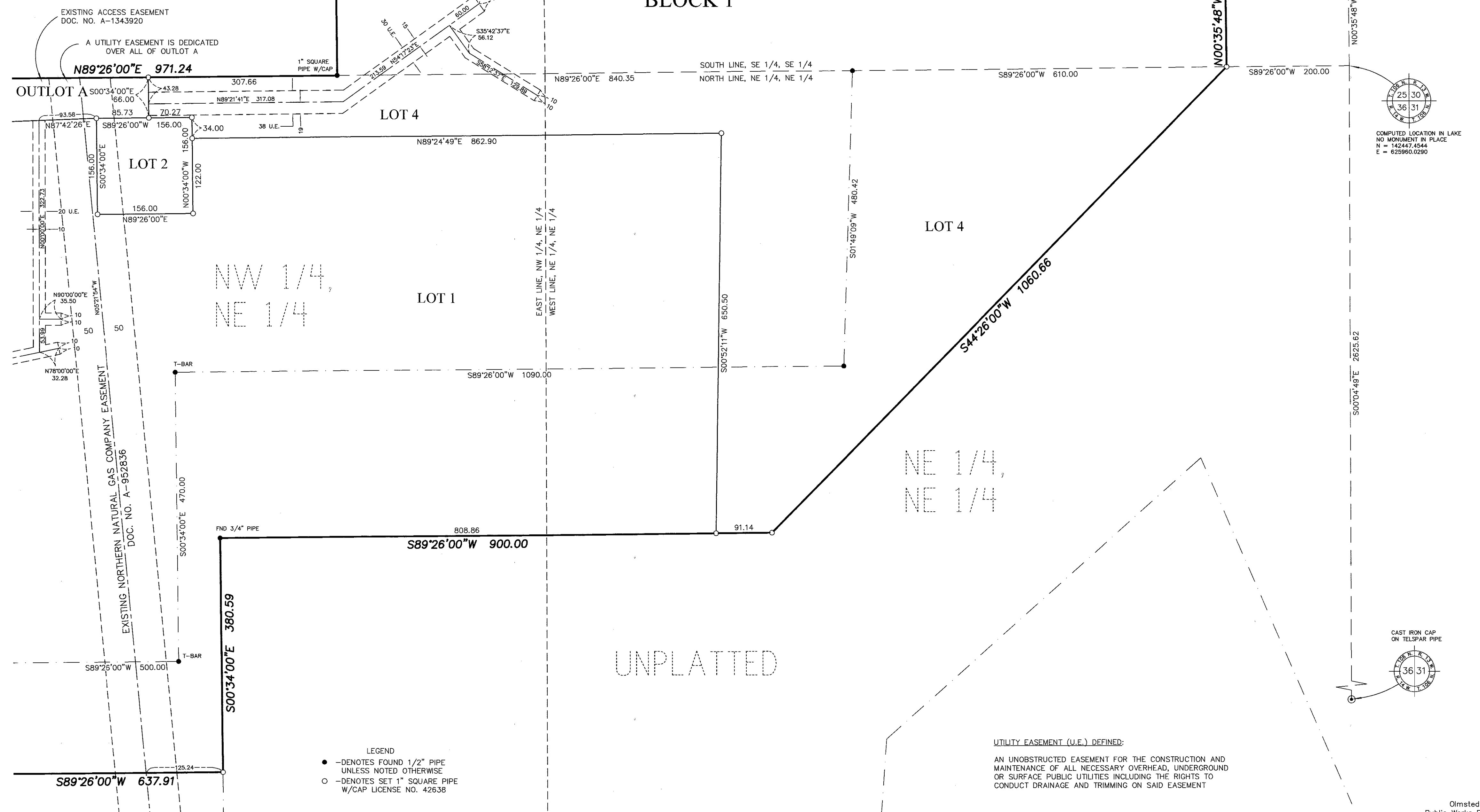

Scale in Feet
 25 0 50 100
 1 Inch = 100 Feet

ORIENTATION OF THIS BEARING SYSTEM IS BASED ON THE OLMSTED COUNTY COORDINATE SYSTEM NAD83 (1996 ADJUSTMENT)

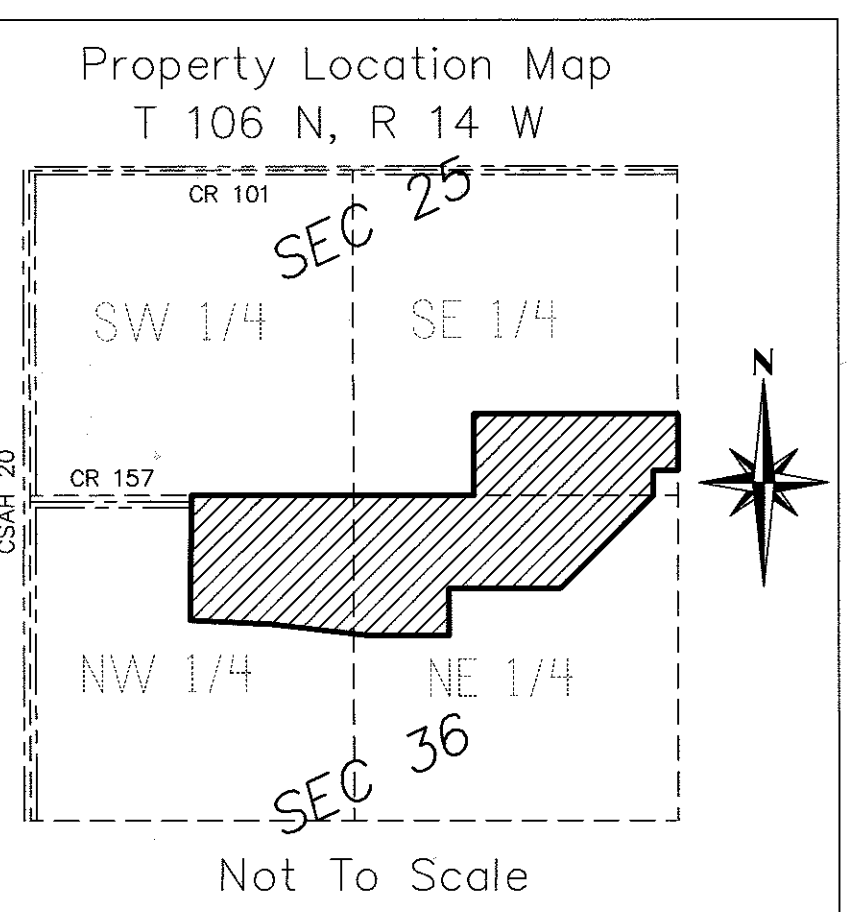

- LEGEND
- DENOTES FOUND 1/2" PIPE UNLESS NOTED OTHERWISE
 - DENOTES SET 1" SQUARE PIPE W/CAP LICENSE NO. 42638

UTILITY EASEMENT (U.E.) DEFINED:
 AN UNOBSTRUCTED EASEMENT FOR THE CONSTRUCTION AND MAINTENANCE OF ALL NECESSARY OVERHEAD, UNDERGROUND OR SURFACE PUBLIC UTILITIES INCLUDING THE RIGHTS TO CONDUCT DRAINAGE AND TRIMMING ON SAID EASEMENT

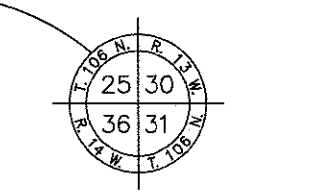
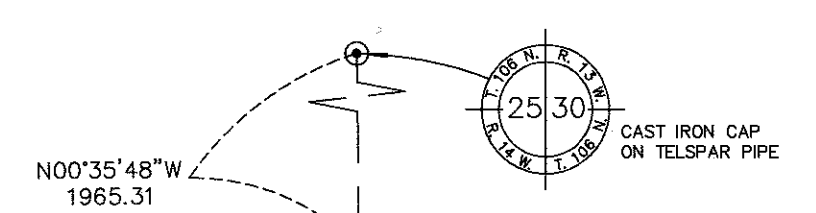

COMPUTED LOCATION IN LAKE
 NO MONUMENT IN PLACE
 N = 142447.4544
 E = 625960.0290

